



RFQ #19-10

Professional Engineering Services



Prepared by **Kimley»Horn**

TRED260035.19



1. Cover Letter

November 22, 2019

Kimley»Horn

Mr. Rafael G. Casals, ICMA-CM,CFM
Town Manager, Town of Cutler Bay
10720 Caribbean Blvd., Suite 105
Cutler Bay, FL 33189

Re: Public Works Department – Professional Engineering Services; RFQ #19-10

Dear Mr. Casals and Members of the Selection Committee:

Kimley-Horn is pleased to submit this Statement of Qualifications to provide the Town of Cutler Bay with professional engineering services. We have selected a talented and experienced group of professionals with extensive local experience to serve you on this contract. As your consultant, Kimley-Horn pledges our full commitment to assist in developing the best solutions for all your project needs.

The Town needs an experienced consultant who works as a trusted partner and extension of Town staff. Kimley-Horn has a long history of successfully teaming with local and municipal clients to help assess their needs, develop goals, and implement programs to achieve those goals. Our firm has provided engineering, planning, and landscape architectural services to Florida clients for the past 52 years. ***Kimley-Horn has served more than 100 cities, counties, and local government clients throughout Florida—and more than 50 of these municipalities have chosen Kimley-Horn as their on-call consultant.*** Throughout the firm's growth, we have come to appreciate the value and importance of remaining true to our roots as a small firm: focusing our attention on our local clients and providing them with the personalized and responsive service they expect.

Commitment to Municipal Clients. Kimley-Horn prides itself on being a successful municipal consultant. In fact, one of our largest practices is within the municipal arena. We have conscientiously served municipal clients for many years and are currently serving as consultant for your neighbors in Palmetto Bay, North Bay Village, Miami Gardens, Miami Lakes, Medley, Homestead, Miami Beach, Miami, South Miami, and Bay Harbor Islands, along with dozens of other Florida municipalities.

Familiarity with the Town's needs. Having worked on many continuing contract opportunities across Florida and with the Town since your incorporation, we will capitalize on our extensive knowledge of local issues and proven ability to manage your projects. Our knowledge and understanding of Cutler Bay, coupled with our flexibility to adapt to your changing needs, allows us to be your consultant of choice for your multidisciplinary demands.

Unmatched Responsiveness. We are a responsive, readily available team who will examine ways to reduce costs as we work with you to define specific needs and implement well-planned and innovative solutions. We have more than 4,200 professionals with diverse backgrounds and experience ready to begin working with you immediately. *We look forward to serving as your consultant on this contract.*

Very truly yours,

KIMLEY-HORN

Stefano Viola, P.E.
Project Manager

Gary Ratay, P.E.
Principal-in-Charge

Note: As a senior vice president with Kimley-Horn, Gary Ratay is authorized to contractually bind the firm.

RFQ #19-10

Professional Engineering Services



2. Table of Contents

Section / Title	Page
1. Cover Letter	1
2. Table of Contents.....	2
3. Organizational Chart and Availability	3
4. Consultant History	4
5. Resumes	6
6. Table of Current and Recently Completed Projects	10
7. Projects Completed On Time and Within Budget	12
8. Similar Projects	14
9. Awards	18
10. Appendices A, B, and C (Forms).....	21
11. Required Firm Licenses, Certificates of Insurance, and Acknowledgment of Addendums	28

3. Organizational Chart and Availability

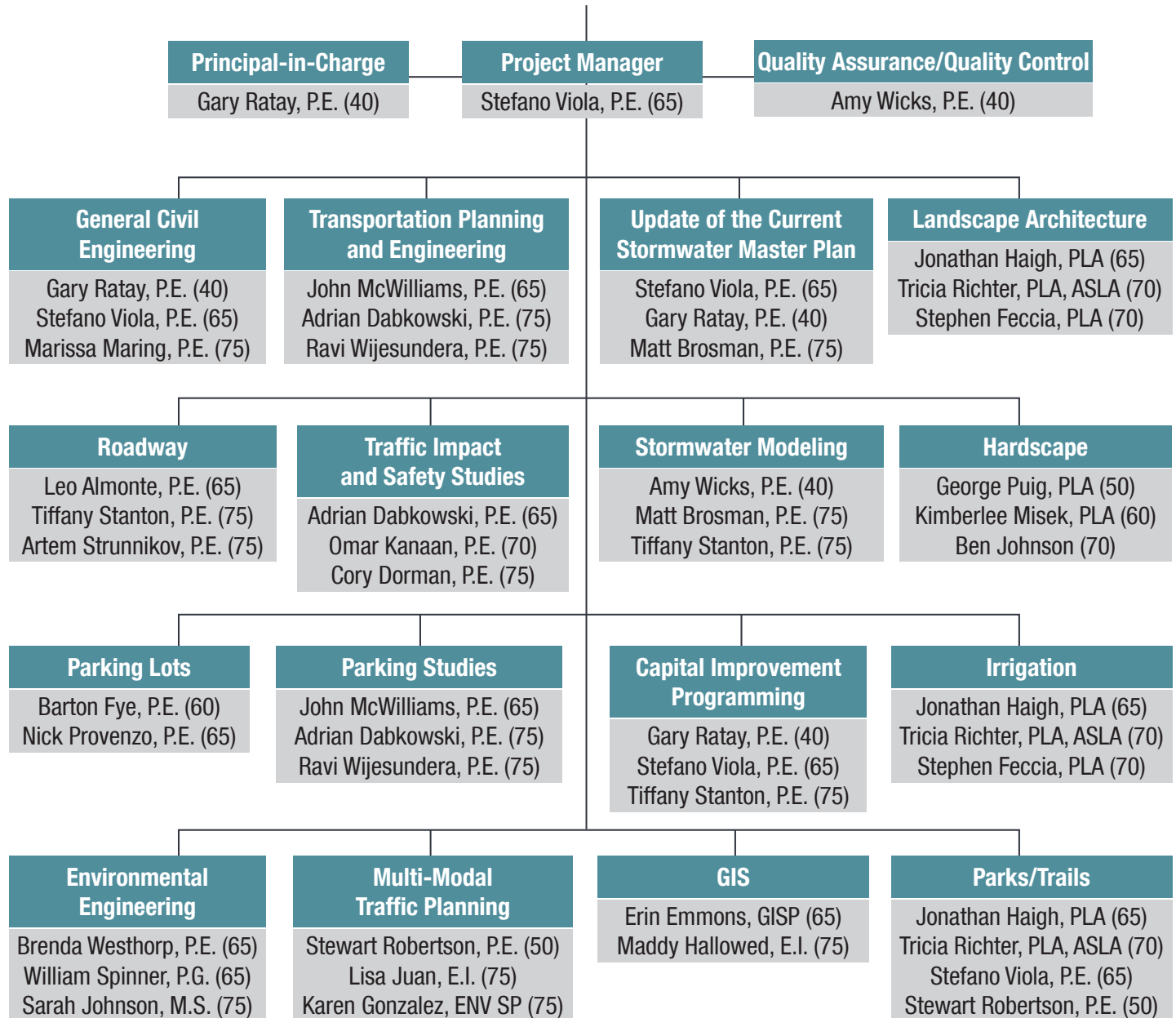

Subconsultants

Surveying Stoner and Associates James Stoner, PSM (50) Richard Crawford Jr., PSM (50)	Geotechnical Engineering Tierra South Florida Raj Krishnasamy, P.E. (50) Ramakumar Vedula, P.E. (50)
---	--

*Projected Availability
shown in parentheses*

4. Consultant History

Kimley-Horn and Associates, Inc. is a full-service multidisciplinary consulting firm offering a broad range of engineering, planning, landscape architecture, transportation, and environmental services to clients in both the public and private sectors. Founded in 1967, Kimley-Horn first became well-known for its expertise in transportation planning and traffic engineering. In the early 1970s, the firm built an impressive track record in regional and urban area transportation planning, traffic impact analysis, parking planning and design, traffic control system design, and statewide and local traffic operations and safety studies. During this period, the firm also added practices in structural, highway, and bridge design, as well as airport planning and design. Kimley-Horn is now one of the largest and fastest growing full-service consulting firms in Florida.

Our permanent staff includes more than 4,200 professional, technical, and support staff nationwide and more than 800 employees in 16 offices throughout Florida. Kimley-Horn remains one of the few employee-owned consulting firms in the nation. Today, we are a fully integrated consulting firm with experience and expertise including, but not limited to:

- General civil engineering
- Transportation planning and engineering
- Stormwater master planning & design
- Landscape architecture
- Land use planning
- Land development regulations
- Comprehensive planning
- Developments of Regional Impact (DRI)
- Urban design
- Community/neighborhood planning
- Visioning/public involvement programs
- Traffic impact analysis
- Parking studies
- Commercial/mixed-use site planning
- Grant funding, loan, and other intergovernmental funding assistance

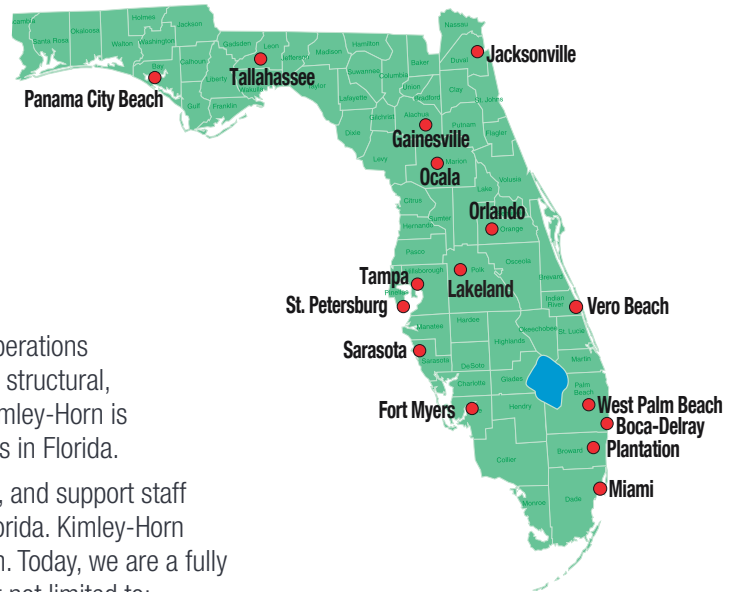

Subconsultants

Kimley-Horn emphasizes the value of building structured working relationships to obtain the greatest combination of skills and professionalism to offer dependable, quality service to our clients. We have a responsibility to provide the best possible client service to you as your consultant and we expect the same level of commitment from each of our subconsultants.

Tierra South Florida, Inc., Geotechnical Services. Tierra South Florida will provide geotechnical support. Their staff has been involved in dozens of roadway, drainage, and community enhancement projects in Florida, particularly on FDOT facilities. Kimley-Horn has teamed with them many times in the past and is confident in the consistently high level of service they routinely provide.

Stoner & Associates, Inc., Surveying Services. Stoner & Associates' mission is to provide quality Land Surveying services while utilizing the latest technology and techniques. Stoner & Associates is a professional land surveying consultant to numerous agencies and municipalities, including South Florida Water Management District, Broward College, Town of Davie, City of Fort Lauderdale, and City of Sunrise. They have performed land surveys for most municipalities and numerous governmental agencies and private clients within the Tri-County Area.

Overview of the Firm's Services

General Civil Engineering



Civil engineering forms the backbone of our experience and qualifications to serve the Town. In South Florida over 160 staff members are professionally registered as civil engineers. This means that in addition to having experience in general engineering, we are able to serve you in many additional areas. A stormwater infrastructure project could easily involve other disciplines such as transportation planning or roadway design. At Kimley-Horn, we can offer you experienced, integrated teams of professionals specializing in utility engineering, transportation planning, roadway design, drainage design, site planning and master planning, landscape architecture, water and wastewater facility rehabilitation and design, surface water management, and hydraulic/hydrologic modeling. Our multidisciplinary depth of resources means that you will receive unmatched service.

Transportation Planning and Engineering

Kimley-Horn has provided transportation-related planning and engineering services to public- and private-sector clients since its founding. We are a national leader in the assessment of transportation impacts, in the development of methodologies to continuously monitor development-generated traffic, and in the analysis and recommendation of feasible financing mechanisms for roadway and transportation improvements. We have assisted numerous local municipalities in developing transportation plans and programs that were successful in obtaining funding assistance for transportation improvement programs. In addition, our transportation planning staff lends a multimodal perspective to a broad range of transportation planning projects, applying effective and often innovative methods for ensuring public participation and support for implementation.



Stormwater Master Planning

Our stormwater design and master planning services encompass dozens of municipalities, local drainage districts, and every water management district across the state. Our professionals have helped solve some of the most complex stormwater runoff, retention, and treatment issues faced by public agencies today. We also specialize in designing drainage systems to protect sensitive ecosystems and are equipped to handle all of your permitting, design, and construction needs, from start to finish. Our stormwater related services include, but are not limited to:

- Stormwater master planning
- Feasibility analyses
- Drainage design
- Stormwater modeling
- FEMA permitting
- Drainage system retrofitting
- Hydrogeology
- Flood control system design
- NPDES monitoring and compliance programs
- Surface water quality monitoring
- Erosion and sediment control plans
- Geographic information systems (GIS)
- Visioning/public involvement programs



- Regulatory agency planning, coordination, and liaison
- Opinions of probable construction costs
- Construction phase services

Landscape Architecture

Our landscape architects and urban planners have varied public-sector experience ranging from corridor plans and downtown streetscape programs to parks and recreation planning. Our planners and landscape architects emphasize the development of a pleasing visual environment, meaningful theme, distinctive image, and strong sense of place. Our full-service consulting includes feasibility studies, master planning, design, permitting, public participation and consensus building, and construction administration. Our landscape architecture professionals are experts in conducting public involvement programs, including community workshops, to promote consensus for public beautification programs.

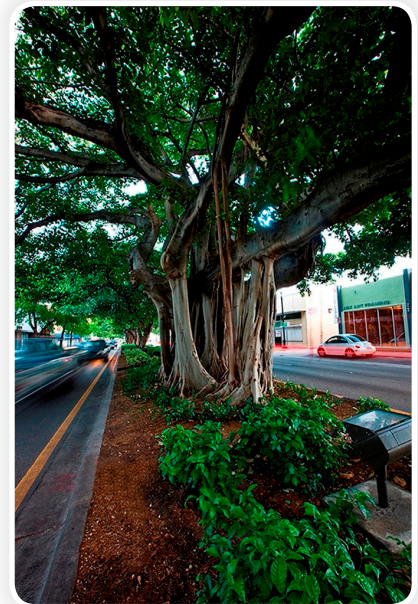

General Municipal Services



Kimley-Horn has a long history of being a successful consultant to local government clients. We have served more than 100 cities, counties, and local government clients in Florida—and more than 50 of these clients have chosen Kimley-Horn as their on-call consultant. The diversity of services that we offer to our clients allows us to truly be a consultant to them, not just an on-call engineer.



Stefano Viola, P.E.

Project Manager

Relevant Experience

Town of Cutler Bay Continuing Stormwater Services, Cutler Bay, FL — Project engineer. Kimley-Horn developed a stormwater master plan to address flood protection activities for its residents and to protect the environmental quality of its canals. Kimley-Horn also developed a stormwater management report to assist the Town in creating a stormwater utility, which generates a dedicated stream of revenue to implement capital improvements and maintain an operation and maintenance program associated with the stormwater system. In addition, Kimley-Horn developed the stormwater utility fee methodology and established the range of rates for the utility to implement improvements. The project tasks included compiling data, developing a stormwater master plan, developing a stormwater management report, and assisting the Town in joining the National Flood Insurance Program (NFIP) so the community has future access to federally-funded flood insurance, and submitting applications and program approach for an anticipated Community Rating System (CRS) rating of 6.

Cutler Bay Safe Routes to School Design Services-Cutler Bay Middle School, Cutler Bay, FL — Project manager. Kimley-Horn provided professional services for the design and preparation of construction documents for the Federally Funded Safe Routes to School (SRTS) project at Cutler Bay Middle School, formally known as Cutler Bay Academy of Advanced Studies. The scope included project management, preliminary design, environmental documentation, permitting assistance, final design services, LAP and post design, as well as construction contract documents including design plans, specifications, cost estimates, and production of the necessary environmental documents for the project.

SW 212th Street Improvement Project, Cutler Bay, FL — Project manager. Kimley-Horn assisted the Town in addressing flooding issues occurring on SW 212th Street between SW 87th Avenue and SW 85th Avenue. As part of the design, Kimley-Horn designed a mid-block crossing on SW 212th Street to improve the pedestrian traffic flows during peak events. This project required extensive permitting through Miami-Dade County Traffic, Environment and Regulatory Affairs (PERA), Miami-Dade County Public Works, Army Corps of Engineers, and the South Florida Water Management District (SFWMD). Based on local agency program funding, close coordination with FDOT was also required. Kimley-Horn also provided construction phase services to certify the project was built in compliance with the design plans. During construction, it was determined that the outfall structure was going to impact the existing multi-use path that was running parallel to the L-31E canal, so the path had to be redesigned in the field to prevent contractor delays. A short construction duration was performed during the summer months and was successfully completed on time.

SW 97th Avenue Improvements, Cutler Bay, FL — Project engineer for the Kimley-Horn team that is providing construction phase services for this roadway project in the Town of Cutler Bay. Tasks include shop drawing review, site visits, and utility coordination, as well as resident project representative services.

SW 89th Street Roadway and Drainage Improvement Project, Palmetto Bay, FL — Project engineer. Also provided utility coordination. Kimley-Horn assisted in developing a roadway restoration/resurfacing and drainage improvements project in a residential area, including design, hydraulic modeling, contract documents, and permitting. The project included signing and pavement markings, swale restoration, sidewalk improvements, and site restoration. Kimley-Horn provided construction phase services to expedite the project and to confirm the project was built in accordance with the design plans. Close coordination with residential property owners was required for the successful project.

North Bay Village Continuing Services Agreement for Planning, Utilities, Engineering, and Roadways, North Bay Village, FL Project engineer. Kimley-Horn provides general engineering services for the City of North Bay Village on an ongoing basis. Services have included water and wastewater studies, planning, design, permitting, and construction phase services.

Professional Credentials

- B.S., Civil Engineering, Florida International University, 2007
- Professional Engineer in Florida, #74655, June 8, 2012

Special Qualifications

- More than 13 years of engineering experience, including roadway restoration/resurfacing, drainage modeling, water/wastewater utility design, stormwater master planning, preparation of engineering drawings, permitting, and site/plan preparation and review
- Prior to joining Kimley-Horn, served as Sergeant in the United States Marine Corps for five years
- Experience with AutoCAD, WaterCAD, StormCAD, and Cascade

Professional Organizations

- American Society of Civil Engineers (ASCE)
- Florida Engineering Society



Gary Ratay, P.E.

Principal

Relevant Experience

SW 212th Street Improvement Project, Cutler Bay, FL — Principal-in-Charge. Kimley-Horn assisted the Town in addressing flooding issues occurring on SW 212th Street between SW 87th Avenue and SW 85th Avenue. SW 212th Street is adjacent to Cutler Bay Senior High School, so during heavy rain events the flooding was impacting access to the school. Kimley-Horn created a design that included exfiltration trench and an outfall to the L-31E canal on the west side of SW 87th Avenue. The connection to the canal required crossing an Army Corps of Engineers levee which entailed additional agency reviews and project coordination to ensure the levee was not compromised during construction. Additionally, as part of the design, Kimley-Horn designed a mid-block crossing on SW 212th Street to improve the pedestrian traffic flows during peak events. This project required extensive permitting through Miami-Dade County Traffic, Environment and Regulatory Affairs (PERA), Miami-Dade County Public Works, Army Corps of Engineers, and the South Florida Water Management District (SFWMD). Based on local agency program funding, close coordination with FDOT was also required. Kimley-Horn also provided construction phase services to certify the project was built in compliance with the design plans. During construction, it was determined that the outfall structure was going to impact the existing multi-use path that was running parallel to the L-31E canal, so the path had to be redesigned in the field to prevent contractor delays. A short construction duration was performed during the summer months and was successfully completed on time, so that the work did not impact the start of the 2015 school year and secured the project funding.

Stormwater Master Plan and Design Services, Cutler Bay, FL — Project manager for the creation of a stormwater master plan for Cutler Bay to address flood protection activities and protect the environmental quality of its canals. Kimley-Horn also developed a stormwater management report to assist the Client in creating a stormwater utility. A stormwater utility generates a dedicated stream of revenue to implement capital improvements and maintain an operation and maintenance program associated with the stormwater plan, development of a stormwater management report and assisting Cutler Bay in joining the National Flood Insurance Program (NFIP) so that federally funded flood insurance is available to the community.

Town Engineering Services, Miami Lakes, FL — Served as Town engineer, providing numerous duties that are associated with engineering, utility, parks, planning, and other engineering related issues. Developed the Town's stormwater master plan and associated stormwater management report to create a stormwater utility. Specifically, Kimley-Horn provides services and acts as the town engineer, public works staff, utility staff, and construction oversight staff.

Professional Credentials

- B.S., Mechanical Engineering, University of Florida, 1985
- Professional Engineer in Florida

Special Qualifications

- Has 32 years of civil engineering experience with particular expertise in general municipal engineering, stormwater management, project permitting, and construction phase services
- Principal areas of practice also include water distribution, wastewater collection, force main and associated pump station design, water treatment plant design, well pump design and site piping, and feasibility and engineering reports
- Has State Revolving Fund (SRF) loan experience

Professional Organizations

- Florida Engineering Society
- National Society of Professional Engineers (NSPE)

General Engineering Services, Plantation, FL — Served as project manager providing general consulting services for the City of Plantation. Worked closely with the City on numerous roadway, drainage, and community enhancement projects, as well as traffic studies associated with the proposed improvements. Services have included general planning to develop cost-effective streetscape and beautification approaches and a traffic calming program. Also assist the City in implementing those visions with thorough, cost-effective roadway, traffic, lighting, landscaping, irrigation, and drainage designs followed by construction phase services.

Stormwater Master Plan and Design Services, Palmetto Bay, FL — Served as project manager for the development of a stormwater master plan and subsequent stormwater master plan update for the Village of Palmetto Bay to address flood protection activities for its residents, and to protect the environmental quality of its many canals. In addition to addressing stormwater management issues, Kimley-Horn developed a stormwater management report to assist the Village in creating a stormwater utility. A stormwater utility generates a dedicated stream of revenue to implement capital improvements and maintain an operation and maintenance program associated with the stormwater system. The project tasks primarily consisted of data compilation, development of a stormwater master plan, development of a stormwater management report, and assisting the Village in joining the National Flood Insurance Program (NFIP) so that federally funded flood insurance is available to the community.



Amy Wicks, P.E., LEED AP

QA/QC, Stormwater Modeling

Relevant Experience

Owl Creek Drainage Study and Remediation, Charlotte County, FL — Kimley-Horn provided design and environmental resource permitting of a conveyance to alleviate existing flooding of SR 31. Lee County's North Fort Myers Master Plan was updated to include a more detailed approach to modeling to demonstrate regional improvements to both water quantity and water quality. The project is anticipated to reduce localized flooding up to one foot after buildout, and improve water quality within the basin by 40 percent. In the aftermath of Hurricane Irma, which produced over 12.5 inches of rainfall in 12 hours, the partially constructed system demonstrated a reduction of localized flooding of nearly 8 inches over previous recorded events in the area.

Hendry Creek West Branch Water Quality Improvements, Fort Myers, FL — Amy's team is designing one of the first tidal water quality-created wetlands in Southwest Florida. This project will create a stormwater park that will not only provide education to the community about stormwater though interaction but is designed to treat water flowing in two directions: from the Gulf and to the Gulf. The innovative design will be a showcase project for water quality improvement in Southwest Florida. Currently, Kimley-Horn is providing continuous flow monitoring and weekly water quality monitoring of the site to gain the necessary design information to meet 319 grant requirements.

Babcock Ranch Community, Charlotte and Lee Counties, FL — Project manager and engineer of record for the master development, design and environmental resource permitting of the surface water management system the 26+/- square mile development of regional impact. The goal of the development is to include several sustainable features including enhancing water quality, abating regional drainage issues, and developing the site in a socially responsible manner as to preserve much of the natural habitat. The site presently has obtained conceptual permitting through the SFWMD for the master stormwater management system, and approximately 900 acres have obtained construction and operation permits.

Town of Palm Beach D-4 and D-10 Stormwater Pump Station (SWPS) Construction, Palm Beach, FL — Project engineer. The Town of Palm Beach selected Kimley-Horn to design improvements to both the D-4 and D-10 Stormwater Pump Stations (SWPS). Kimley-Horn performed design, permitting, and construction phase services for the two projects. The Town of Palm Beach utilized the construction management at risk project delivery method where both stations were constructed simultaneously.

Town of Palm Beach D-4 and D-10 Stormwater Pump Station (SWPS) Construction, Palm Beach, FL — Project engineer. The Town of Palm Beach selected Kimley-Horn to design improvements to both the D-4 and D-10 Stormwater Pump Stations (SWPS). Kimley-Horn performed design, permitting, and construction phase services for the two projects. The Town of Palm Beach utilized the construction management at risk project delivery method where both stations were constructed simultaneously.

Fort Lauderdale Executive Airport (FXE) Master Drainage/Conceptual Environmental Resources Permit (ERP), Fort Lauderdale, FL — Project engineer. Prior to this project, FXE did not have an ERP for its property. Without an ERP, each development requires a standalone permit which does not allow for the overall benefit and development of the FXE property as a

whole. The purpose of the ERP is to conceptually approve the design concepts of a phased development mast plan for a surface water management system, so long as the general guidelines set forth in the ERP are upheld. The scope includes pre-design services, existing utility coordination, stormwater modeling, schematic plans, conceptual design permit plans, and permitting.

Professional Credentials

- M.S., Environmental Engineering, University of Florida, 2009
- B.S., Civil Engineering, Rose-Hulman Institute of Technology, 2004
- Professional Engineer in Florida, #68339, July 1, 2008
- LEED Accredited Professional

Special Qualifications

- Has 14 years of experience managing, designing and permitting a large variety of projects
- Expertise focused on surface water resources and water quality improvement projects, as well as 319 grant coordination
- Experience includes basin action management plan (BMAP) planning and negotiations with municipalities and FDEP
- Experience permitting projects of all sizes in both the South Florida Water Management District (SFWMD) and the Southwest Florida Water Management District (SWFWMD)
- Proficient in engineering software including ICPR, XPSWMM, HEC-RAS, and HEC-HMS)



Marissa Maring, P.E.

General Civil Engineering

Relevant Experience

Cutler Bay Safe Routes to School Design Services-Cutler Bay Middle School, Cutler Bay, FL — Project engineer. Kimley-Horn provided professional services for the design and preparation of construction documents for the Federally Funded Safe Routes to School (SRTS) project at Cutler Bay Middle School, formally known as Cutler Bay Academy of Advanced Studies. The scope included project management, preliminary design, environmental documentation, permitting assistance, final design services, LAP and post design, as well as construction contract documents including design plans, specifications, cost estimates, and production of the necessary environmental documents for the project.

North Bay Village Continuing Services Agreement for Planning, Utilities, Engineering, and Roadways, North Bay Village, FL — Project engineer. Kimley-Horn provides general engineering services for the City of North Bay Village on an ongoing basis. Services have included water and wastewater studies, planning, design, permitting, and construction phase services.

Las Olas Boulevard Corridor Improvements, Fort Lauderdale, FL — Project engineer. Kimley-Horn is providing preliminary design, evaluation, and due diligence services for this mixed-use project for the City of Fort Lauderdale Community Redevelopment Agency. The project consists of the redevelopment of several pieces of City property from existing surface parking lots to a new multi-story parking garage; active park and plaza areas; and general open space to enhance the pedestrian and beachgoer experience in the Fort Lauderdale beach area. Las Olas Boulevard is being improved to provide a “Complete Streets” design to better connect the shops, restaurants, and other businesses with the new Oceanside Plaza on the south side of Las Olas Boulevard. The design of Oceanside Plaza includes space for special events such as festivals and concerts; play areas for children; and a convenient porte-cochere drop off. Kimley-Horn is providing the initial site civil engineering design, roadway design, permitting coordination, stormwater, utility, franchise utility coordination, and other services.

Clematis Streetscape Improvements, West Palm Beach, FL — Project engineer. Kimley-Horn is providing landscape architecture and civil engineering services as part of the team designing improvements to the 300 block of Clematis Street in downtown West Palm Beach. In partnership with the City, the team conducted public outreach so residents and visitors. After several public input meetings with Clematis Street merchants, other area merchants, stakeholders, residents and visitors, the City Commission voted to implement recommendations from the award-winning design team.

Melaleuca Drive Roadway Improvements, Margate, FL — Project engineer. Kimley-Horn provided civil engineering and landscape architectural services for this project to design new sidewalks, accessible crossings, landscape, and provide irrigation improvements for this residential street that connects Atlantic Boulevard to NW 9th Court. The project focused on preserving existing trees and adding pockets of colorful plantings along the sidewalk to create a pleasant pedestrian experience.

Miramar Parkway Streetscape from SW 64th Avenue to SW 68th Avenue, Miramar, FL — Project engineer for this FDOT LAP funded project that involves roadway, landscape, irrigation, and lighting improvements on Miramar Parkway. Additional project improvements include bicycle lanes, drainage modifications, landscaping, lighting, hardscaping, driveway apron regrading, sidewalk replacement, ADA improvements at the intersections, and a mid-block pedestrian crossing/emergency signal modification.

Village Transportation Master Plan, Pinecrest, FL — Project engineer for the development of a Village wide transportation master plan. Project includes the identification, development, and conceptual design of improvements along corridors and intersections focusing on traffic operations, traffic calming, and multimodal enhancements. Tasks include operational analysis, future traffic forecasting, improvement design, public outreach and cost estimating.

Professional Credentials

- B.S., Engineering, Syracuse University, 2013
- Professional Engineer in Florida, #84325, December 16, 2017

Special Qualifications

- Has five years of engineering experience, including water/wastewater utility design, water/wastewater/reuse master planning, advanced water treatment processes and facilities design, hydraulic modeling, environmental remediation, preparation of engineering drawings, permitting, and site/plan preparation and review
- Experience with AutoCAD, InfoWater, and ArcGIS

Professional Organizations

- American Water Works Association (AWWA)
- Florida Water Environment Association (FWEA)

6. Table of Current and Recently Completed Projects

To list all current and recently completed projects for all clients for whom the Kimley-Horn team has provided work of similar size and scope would be voluminous. Instead, we offer a sampling below of currently or recently completed similar projects in Florida.

Project	Contract Length	Scope of Services/Specific Accomplishments	Type of Contract	Contact Name, Phone, Email
Kimley-Horn				
Safe Routes to School Sidewalk Improvements, Town of Cutler Bay	April 2016 – March 2018	Design and preparation of construction documents for twenty-one 5-foot-wide sidewalks in the vicinity of Cutler Bay Middle School. Services included preliminary design, permitting, environmental services, FDOT/LAP coordination and construction phase services. Improvements included pedestrian crossing flashers, roadway striping, and school zone signing upgrades.	Project-based fee	Alfredo Quintero, E.I., CFM, Dir. Public Works, 305-234-4262, aquintero@cutlerbay-fl.gov
Continuing Contract for Transportation Engineering Services, City of Pompano Beach	Oct. 2016 – ongoing	Providing transportation support services for the City and CRA. Assignments include traffic engineering analysis support for a City-initiated land use plan amendment, corridor operations analysis, transportation systems management/geometric improvements, neighborhood protection and enhancement plans, and community outreach/workshops for transportation issues, site plan reviews, and parking garage/loading area maneuverability analyses.	Project-based fee	Horacio Danovich, CIP Director, 954-786-7834, horacio.danovich@copbfl.com
City of Aventura General Engineering Services	July 2019 – ongoing	Providing on-call engineering services for site planning, traffic studies, permitting, bid/award, cost estimating, program management, GIS, CEI, and environmental services for city buildings, lands, parks, utilities, beautification purposes, and regulatory matters.	Project-based fee	Joseph S Kroll MPA, CPM, CFM, Public Works & Transportation Director, 305-466-8970, jkroll@cityofventura.com
Wiles Road Design from Riverside Drive to Rock Island Road	May 2013 – Sept. 2019	Complete contract plans for the widening of Wiles Road to a 6-lane divided urban arterial. Improvements included roadway design, Complete Streets design, drainage, lighting, landscaping, irrigation, bicycle lanes, signalization, utility coordination, permitting coordination with the City of Coral Springs and detailed traffic control plans. Our team provided tree mitigation permit services and coordinated with both County and City forester.	Project-based fee	Manuel Fontan, P.E., PTOE, 954-577-4654, mfontan@broward.org
Town of Miami Lakes General Engineering Services	June 2000 – ongoing	The Town has contracted with Kimley-Horn to serve as Town Engineer, including providing staff to fill the positions of Public Works Director and Stormwater Utility Director. Services have included a stormwater master plan, development of a stormwater utility. We also prepare the stormwater, roadway, and park portions of their yearly Capital Improvement Plan and Budgets and review applications for work in the public R/W.	Project-based fee	Carlos Acosta, MBA, PE, PMP, Public Works Dir., 305-364-6100, ext 1129 acostac@miamilakes-fl.gov
Clematis Streetscape Improvements, City of West Palm Beach	June 2017 – Nov. 2019	Landscape architecture and civil engineering services. After several public input meetings with Clematis Street merchants, stakeholders, residents, and visitors, the City Commission voted to implement recommendations from the design team to implement a transformative change to this destination street in downtown West Palm Beach. The design features a paver-covered, curbless street with narrowed travel lanes, premium paver sidewalks, permeable paver parking spaces, custom-designed seating areas, and a landscape featuring large Live Oaks to provide significant shade for pedestrians.	Project-based fee	Alison Justice, Interim Dir, West Palm Beach CRA, 561-822-1553, ajustice@wpb.org

Project	Contract Length	Scope of Services/Specific Accomplishments	Type of Contract	Contact Name, Phone, Email
OB Johnson Park Design, City of Hallandale Beach	July 2014 – July 2018	This 6.4-acre park in Hallandale Beach Park was part of the City-wide park master plan that set forth a program to enhance 13 of the City's parks and recreation areas in support of community-wide goals and neighborhood needs.	Project-based fee	Cathie Schanz, CPRE, Parks & Rec. Director, 954-457-1452, cschanz@cohb.org
Village of Palmetto Bay Stormwater Improvements and Stormwater Master Plan Update	April 2015 – ongoing	As part of the stormwater master plan, Kimley-Horn assisted the Village in developing a capital improvement program to prioritize improvements based on flood management needs and associated costs.	Project-based fee	Danny Casals; 305-969-5011, dcasals@palmettobay-fl.gov
City of Miramar General Consulting Services	July 2015 – ongoing	Providing general civil engineering, traffic engineering, landscape architecture and park design consulting services to the City of Miramar on an ongoing basis. Areas of assistance include review of traffic impact analyses and parking studies specific to development applications, park design services, reclaimed water line design, water main design, and site civil engineering.	Project-based fee	Bissy Vempala, P.E., City Engineer, 954-602-3320, bjvempala@miramarfl.gov
Village of Pinecrest On-Call GIS Services	Jan. 2016 – ongoing	Serving the Village as an on-call GIS consultant. We provide on-site training and have helped them develop and organize their interagency database. Recent support has included zoning and land use updates, website development coordination, and stormwater utility updates. Services include GIS software support and onsite system maintenance, and digitization of existing paper maps, and blueprints.	Project-based fee	Gabriela Wilson, IT Manager, 305-234-2121, gwilson@pinecrest-fl.gov
Village of Pinecrest Transportation Master Plan	Aug. 2017 – March 2018	Professional services for the development of a Village-wide transportation master plan. Project included the identification, development, and conceptual design of improvements along corridors and intersections focusing on traffic operations, traffic calming, and multi-modal enhancements. Tasks included operational analysis, future traffic forecasting, improvement design, public outreach and cost estimating.	Project-based fee	Mark Spanioli, P.E., Public Works Dir., 305-669-6916, mspanioli@pinecrest-fl.gov
64th Ave. Bike Lane Addition (LAP Project), City of Sunrise	Mar. 2016 – Jan. 2019	Design and landscape services for the addition of bike lanes on NW 64th Avenue in Sunrise. Also providing lighting, drainage, pedestrian enhancements. This includes developing design, permitting, and construction documents. Additionally, our environmental scientists will review natural, social, and physical resource data in the area and complete a Type 1 and Programmatic Categorical Exclusion (CE) checklist.	Project-based fee	Alan Gavazzi, AIA, Capital Projects Director, 954-572-2487, agavazzi@cityofsunrise.org
Stoner & Associates, Inc. (surveying support)				
City of Sunrise Surveying Services	2013 – 2019	Professional Surveying Services	Project-based fee	Alan Gavazzi, AIA, 954-572-2487, agavazzi@sunrisefl.gov
Tierra South Florida, Inc. (geotechnical support)				
Geotechnical/Engineering Testing Services	April 2015 – ongoing	TSF provides geotechnical engineering and material testing services for various projects to the City of Sunrise on a TWO basis.	Annual contract	Alan Gavazzi, AIA, Capital Projects Director; 954-572-2487, AGavazzi@sunrisefl.gov

7. Projects Completed On Time and Within Budget

The team members we have assembled for our core team are all located in Miami-Dade and Broward County. We are available by phone at any time. Kimley-Horn's team maintains an effective and accurate accounting of projected staff hours for up to a six-month time period. We know at any given moment what our availability is and we can assure you that we have the required resources for any task at any time.

We recognize that budget and schedule control are critical to the success of your projects. Meeting your schedule for deliverables is not just a goal to us—it is a requirement. Both cost and schedule control are inherently tied to resources (i.e., Kimley-Horn's team). Their experiences, vision, management styles, and philosophies all affect significant components of a project approach and its execution. Our approach will include identifying realistic goals, developing the specific activities that must be performed to produce the various project deliverables, anticipating the implications of decisions made in early phases to future phases, and preparing a mechanism for addressing unexpected challenges. This approach builds the framework for completing successful projects including those listed below, within budget and on schedule.

Meeting your schedule for deliverables is not just a goal to us—it is a requirement.

Paramount to the success of any project is a continued partnering throughout the project to adapt as necessary to unforeseen circumstances. We will include critical decision-making points in our work plans so that the project team and the Town can agree upon the best course of action to keep the project on track. There will always be unexpected challenges unique to any given project; it is critical that an approach be developed that controls what can be controlled and builds in mechanisms for dealing with the unexpected.

Kimley-Horn is well suited to manage and administer projects. We are prepared to commit the necessary resources to ensure the success of your efforts. With our experienced team of local resources, we have unequaled ability to perform on this assignment. Our local presence makes access to these resources simple. To assist our project managers in efficient administration of projects, Kimley-Horn maintains a detailed project management system. This system, designed primarily to focus on schedule adherence and cost control, has proven to be a valuable tool.

We understand that the largest costs to our clients are those related to construction of projects, so we work hard to prepare thorough plans and specifications that accurately and completely define the project requirements. We then break down the project into discreet pay items with specific descriptions of what is included in them to avoid misunderstandings by the contractor during bidding and construction. We then carefully monitor the contractors' progress during construction and assist them in interpreting the contract requirements whenever a question arises. We also review proposals from the contractor to modify elements of construction that offer cost or schedule benefits to the client. This attention to detail throughout the project ensures that our clients receive real value from our services.

Projects completed on time and in budget for the past five (5) years

Project 1

Stormwater Master Plan Update # 3, City of Miami Lakes — Kimley-Horn is currently providing all aspects of engineering assistance to the Town of Miami Lakes. When Miami Lakes incorporated in 2000, they obtained the responsibility and ownership of the roadway and drainage infrastructure within the Town limits. To develop Miami Lakes' own stormwater utility, Kimley-Horn prepared a stormwater master plan that outlined the deficiencies of their current stormwater system. The recommendations from this assessment included a prioritization of the improvements along with a five-year capital improvement program (CIP). Additionally, we developed the stormwater utility fee methodology and established the range of rates for the utility to implement improvements. A critical part of the planning efforts was to assist the Town in joining the National Flood Insurance Program (NFIP). Joining the NFIP is required for the community to obtain federally funded flood insurance and be part of the Community Rating System (CRS) to help reduce insurance rates for the community. Kimley-Horn was successful in helping the Town obtain an unprecedented CRS rating of 6 for a newly incorporated municipality. Kimley-Horn has completed three updates to the Town's original stormwater master plan. The Stormwater Master Plan Updates provide the Town with a comprehensive look at completed stormwater improvements throughout the Town and provides an update to the CIP and a reprioritization of remaining stormwater work. Since incorporation, Kimley-Horn has also provided support to assess the condition of roads, sidewalks, signing, and striping throughout the Town limits. The recommendations from this assessment also included a prioritization of the improvements along with a five-year CIP. To facilitate implementing all identified Town improvements, Kimley-Horn provided construction documents, assisted in obtaining bids from contractors to implement the projects, and provided limited construction phase services. ***All tasks assigned under this project were completed on-time and within budget.***

Project 2

Continuing Engineering Design Services, Stormwater Master Plan and Five-Year Update, Village of Palmetto Bay —

Kimley-Horn provided professional engineering services for the development of a stormwater master plan for the Village of Palmetto Bay to address flood protection activities for its residents, and to protect the environmental quality of its many canals. In addition to addressing stormwater management issues, Kimley-Horn developed a stormwater management report to assist the Village in creating a stormwater utility. A stormwater utility generates a dedicated stream of revenue to implement capital improvements and maintain an operation and maintenance program associated with the stormwater system. The project tasks primarily consisted of data compilation, development of a stormwater master plan, development of a stormwater management report, and assisting the Village in joining the National Flood Insurance Program (NFIP) so that federally funded flood insurance is available to the community. **All tasks assigned under this project were completed on-time and within budget.**

The following table includes additional Kimley-Horn team projects of similar scope that based on following the above project management approach, have also been completed on time and within budget.

Project	On Time	Within Budget
Continuing Engineering Services for Transportation & General Civil Engineering Projects, Broward County	Yes	Yes
St. Pete Beach Master Pump Stations No. 1, No. 2, and No. 3 Rehabilitation	Yes	Yes
City of West Palm Beach On-Call Transportation Engineering	Yes	Yes
Multimodal Transportation Planning and Engineering Consulting Services, Coral Gables	Yes	Yes
City of Greenacres On-Call Traffic Engineering Services	Yes	Yes
FAU Stormwater Management System Update	Yes	Yes
Longboat Key Village Stormwater Master Plan Peer Review	Yes	Yes
Crystal River Community Redevelopment Area (CRA) Stormwater Quality Master Plan	Yes	Yes
Doral North Park	Yes	Yes
Doral Legacy Park	Yes	Yes
North Bay Village Baywalk Plaza Design	Yes	Yes

Quality Assurance/Quality Control

We systematically listen to your needs, document the project's requirements, and formally develop a set of quality standards by which the project will be measured. Kimley-Horn's QA/QC measures are built in to our project management processes. These measures include:

- ✓ Internal project quality controls
- ✓ Project peer reviews

Internal QC Measures. Our internal QA/QC program includes a kickoff meeting with key team members to clearly define the scope, outline subtask responsibilities, establish schedules, and identify project milestones and goals. Our QA/QC manager, **Amy Wicks, P.E.**, will maintain a strict review of all plans, calculations, and reports.

The quality review is continuous so that deliverables meet your needs. At the end of each phase, a QA/QC review will be conducted internally as one of several checks to make sure that the project deliverable is not only technically correct, but also consistent with your objectives.

Peer Reviews. Project processes, work plans, documents, and deliverables often are reviewed by senior staff not necessarily involved with the project on a day-to-day basis. This peer review is routine for all projects, and it becomes a formal process for larger projects. The QA/QC program is based upon assigning experienced, senior professionals who are otherwise qualified to manage a similar project to serve in this independent quality control role. The depth of the Kimley-Horn team allows us to provide such personnel, who provide a fresh perspective and critical eye. Any changes or modifications required to respond to the comments and recommendations of the peer review team will be incorporated prior to submitting deliverables.

Our project team makes a habit of establishing a quality control plan at the beginning of each project, keeping the focus where it should be throughout the project—on producing quality results for our clients.

*Kimley-Horn's
QA/QC measures
are built in
to our project
management
processes and key.*

8. Similar Projects – Past 5 Years

The projects below highlight our key team members experience providing the requested services for this contract.

General Civil Engineering

North Bay Village Water Main Rehabilitation Program — The project included developing bid documents for the rehabilitation of the Village's complete water distribution system. The project objective was to determine water leak locations throughout the water distribution system by means of an electronic leak detection process. The bid documents included the leak detection process requirements performed by the Contractor, and the water main rehabilitation program was then developed based on those results. The project also included repairing and replacing defective components of the water distribution system, including the water main, water service connections, isolation valves, air release valves, and fire hydrants. Kimley-Horn also assisted the Village with obtaining \$4.4 million of funding through the State Revolving Fund (SRF) Program. Kimley-Horn also provided construction administration services that include evaluation of the leak detection results, development of the water main rehabilitation program, progress meetings, public involvement assistance, site observations, shop drawing review, contract clarification, pay application review, coordination with the SRF Program, and project close-out. *Completed:* November 2019; *Key Staff:* Gary Ratay



Village of Palmetto Bay General Engineering Consulting Services — Kimley-Horn has worked with the Village of Palmetto Bay since 2004 as their general consultant providing all types of engineering such as planning, general civil engineering, and transportation design services. The Village initially looked to Kimley-Horn to develop a stormwater master plan and associated stormwater management plan to implement a stormwater utility and obtain ownership of the infrastructure. The Village has also asked Kimley-Horn to develop a comprehensive plan as a foundation and framework for the new municipality. A critical part of our planning efforts has been to help the Village join the National Flood Insurance Program (NFIP). Other services have included landscape architecture, land use analyses, environmental consulting (endangered species surveys); drainage design; roadway design; transportation engineering; EAR amendments; and grant application assistance. *Services ongoing since:* 2004; *Key Staff:* Gary Ratay, Stefano Viola, Marissa Maring

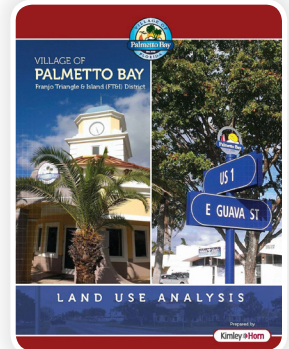

Continuing Engineering Services for the City of Miramar — Kimley-Horn has provided general civil engineering, traffic engineering, landscape architecture and park design consulting services to the City of Miramar on an ongoing basis since the early 2000s. Current projects include streetscape design, traffic impact analyses, parking studies specific to development applications, civic center expansion, pavement management, park design and renovation services, reclaimed water line design, water main design, and site civil engineering. Additional services include involvement as a member of the City of Miramar's land development staff to provide traffic and transportation input to the Planning and Zoning Board and the City Commission for traffic operation issues and proposed development site plans. *Services ongoing since:* 2001; *Key Staff:* Gary Ratay, Stefano Viola, Marissa Maring

Continuing Engineering Services for the City of Coconut Creek — Kimley-Horn has been serving the City of Coconut Creek on miscellaneous projects since 2003. In 2008, we were selected for an on-call continuing engineering services contract. Projects under this contract have included: Sample Road Force Main Valve, US 441 (SR 7)/Hillsboro Boulevard Improvements, Windmill Park Fire Station Design. Other services have included permitting support, utility coordination, landscape design, transportation engineering, drainage improvements and permitting, public involvement, and construction phase services. *Services ongoing since:* 2003; *Key Staff:* Gary Ratay, Stefano Viola



Sistrunk Boulevard Surface Parking Lots, City of Fort Lauderdale — Kimley-Horn provided design plans for four new surface parking lots in Fort Lauderdale. The sites were designed to meet all City code requirements and landscaped with Florida-friendly design concepts. Parking spaces for cars and motorcycles were designed to ADA code and accommodations were also made for bicycle parking. Civil engineering services included paving, grading, drainage design, and signing and pavement marking. Landscaping plans included planting details and irrigation design. *Design completed:* July 2017; *Key Staff:* Stefano Viola, Marissa Maring

Transportation Planning and Engineering

Cutler Bay Middle School Safe Routes to School Design Services — Kimley-Horn provided professional services for the design and preparation of construction documents for the Federally Funded Safe Routes to School (SRTS) project at Cutler Bay Middle School, formally known as Cutler Bay Academy of Advanced Studies. The scope included project management, preliminary design, environmental documentation, permitting assistance, final design services, LAP funding coordination and post design services, as well as construction contract documents including design plans, specifications, cost estimates, and production of the necessary environmental documents for the project. We also prepared construction contract documents that included:

- Installation of 5-foot-wide sidewalks (4" and 6" thick including pedestrian ramps)
- Intermediate school zone flashers
- Installation of detectable warning on existing walking surfaces
- Roadway striping improvements (thermoplastic traffic striping 6", 8", 10", 12", 24" white inclusive of painted crosswalks at key intersections and at school entrance signalized /pedestrian crossing and extend school zone paint on roads)
- Comprehensive signing upgrades and school zone speed feedback signs in front of school

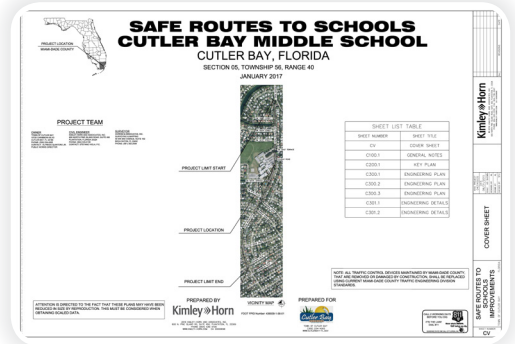

Completed: March 2018; *Key Staff:* Stefano Viola, Marisa Maring

Las Olas Boulevard Corridor Improvements, City of Fort Lauderdale — Kimley-Horn served as lead engineering consultant for site civil design, roadway design, permitting coordination, stormwater, utility, and franchise utility coordination services for this multi-use project for the City of Fort Lauderdale Community Redevelopment Agency. The project consisted of the redevelopment of several pieces of City property from existing surface parking lots to a new multi-story parking garage, active park and plaza areas, and general open space to enhance the pedestrian and beachgoer experience in the Fort Lauderdale beach area. Las Olas Boulevard was being improved to provide a "Complete Streets" design to better connect the shops, restaurants, and other businesses with the new Oceanside Plaza on the south side of the road. Oceanside Plaza was designed so that it can be used for festivals, concerts, and children's play areas and includes a porte cochere drop-off. *Completed:* August 2018; *Key Staff:* Marisa Maring

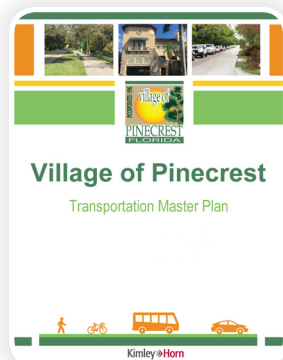

Village of Pinecrest Transportation Master Plan — Kimley-Horn provided professional services for the development of a Village wide transportation master plan. Project includes the identification, development, and conceptual design of improvements along corridors and intersections focusing on traffic operations, traffic calming, and multi-modal enhancements. Tasks include operational analysis, future traffic forecasting, improvement design, public outreach and cost estimating. Our team assessed 35 intersections throughout the Village and made assessments for operational and traffic calming improvements as necessary. *Completed:* March 2019; *Key Staff:* Marisa Maring, Stefano Viola

Bike Lane Addition on NW 64th Avenue from Sunset Strip to Oakland Park Boulevard, City of Sunrise —

The City of Sunrise applied for a \$927,000 Transportation Alternatives Grant administered by the Florida Department of Transportation to construct bicycle lanes and street improvements on NW 64th Avenue from Sunset Strip to Oakland Park Boulevard. The City retained Kimley-Horn for design services for landscape, lighting, drainage, pedestrian and bicycle enhancements. This included developing schematic design, design development, permitting, and construction documents. Additionally, Kimley-Horn's environmental scientists reviewed natural, social, and physical resource data in the area and complete a Type 1 and Programmatic Categorical Exclusion (CE) checklist. Components of the project included milling and resurfacing; re-striping to add buffered bicycle lanes; redesigned landscape with medians; pedestrian scale LED lighting; replacement of existing curb ramps; decorative crosswalk treatments; design for adequate drainage in the roadway. *Design completed:* January 2019; *Key Staff:* Marisa Maring

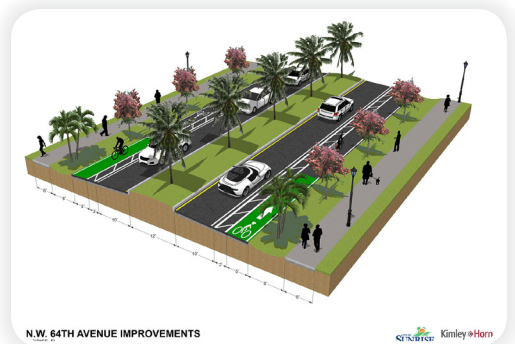

Stormwater Master Planning

SW 212th Street Drainage Improvements, Cutler Bay — Kimley-Horn assisted the Town in addressing flooding issues occurring on SW 212th Street between SW 87th Avenue and SW 85th Avenue. SW 212th Street is adjacent to Cutler Bay Senior High School, so during heavy rain events the flooding was impacting access to the school. Kimley-Horn created a design that included exfiltration trench and an outfall to the L-31E canal on the west side of SW 87th Avenue. The connection to the canal required crossing an Army Corps of Engineers levee which entailed additional agency reviews and project coordination to ensure the levee was not compromised during construction. *Completed:* August 2015; *Key Staff:* Stefano Viola, Gary Ratay



Owl Creek Drainage Study and Remediation, Charlotte County — Kimley-Horn provided design and environmental resource permitting of a conveyance to alleviate existing flooding of SR 31 in Charlotte County. In a request proposed by Lee County as a part of this drainage study, Lee County's North Fort Myers Master Plan was updated to include a more detailed approach to modeling to demonstrate regional improvements to both water quantity and water quality. The partially constructed project is anticipated to reduce localized flooding up to one foot after buildout and improve water quality within the basin by 40 percent. In the aftermath of Hurricane Irma, which produced over 12.5 inches of rainfall in 12 hours in the project location, the partially constructed system demonstrated a reduction of localized flooding of nearly 8 inches over previous recorded events in the area and provided storage and attenuation of potential flood waters to eliminate any potential concerns downstream. *Completed:* April 2016; *Key Staff:* Amy Wicks



Town of Medley Stormwater Master Plan — The Town of Medley is an industrial community in Miami-Dade County, situated northwest of Miami International Airport and abutting several bustling freight corridors. As the Greater Miami Area has increased in population and density, the need to improve failing infrastructure in the Town has become apparent to improve the utilization of land within the tax base. Roads are in poor condition and localized flooding persists throughout the Town during normal rain events, a fact which has deterred some developers from moving into the underutilized areas of the Town. Kimley-Horn was retained to prepare a Stormwater Master plan for the Town, which faces a number of challenges, including a high water table relative to the existing grade (which are generally very flat; numerous pockets of contamination throughout the Town caused by industrial tenants); Florida East Coast Railway, which bisects the Town and thus often makes conveyance of stormwater to the nearby C-6 Canal (the Miami River) cost prohibitive; and the lingering threat of sea level rise and climate change. As part of the Stormwater Master Plan, Kimley-Horn helped prioritize 12 problem areas; planned and modeled improvement projects; provided pollutant loading reduction information for use in grant applications and to ensure eligibility for financial assistance from Miami-Dade County. *Completed:* May 2018; *Key Staff:* Stefano Viola, Gary Ratay



West Lakes A Drainage Improvements, Miami Lakes — As part of the Stormwater Master Plan prepared for the Town of Miami Lakes, Kimley-Horn identified the West Lakes A neighborhood as a critical basin within Miami Lakes that required stormwater infrastructure improvements due to historic flooding in the area. During the master planning effort Kimley-Horn prepared conceptual drainage models and plans for the West Lakes A neighborhood, with our assistance Miami Lakes utilized these concepts to pursue FEMA Grant funding to implement the identified improvements. Miami Lakes was successful in receiving grant funding and as such Kimley-Horn prepared the Construction Documents, which included stormwater infrastructure improvements on NW 89th Avenue from NW 154th Street to NW 138th Street. *Completed:* Sept. 2017; *Key Staff:* Stefano Viola, Gary Ratay



Landscape Architecture

OB Johnson Park, Hallandale Beach — Kimley-Horn provided comprehensive site civil engineering and landscape architecture services for this 6.4-acre park. The park included a 42,000-square-foot multigenerational facility involving a teen center, indoor basketball courts, after school and senior programming, exercise room, administrative offices, and other accessory uses for computer and dance classes, food distribution, and other programming for all ages. The exterior park amenities include a walking trail, playground, tennis courts, a field house, and a football/soccer field. Additionally, the park improvements also included a centrally located surface parking lot, site infrastructure and landscaping. *Completed:* 2016; *Key Staff:* Stefano Viola, Marissa Maring



Optimist Park, Town of Miami Lakes — The Town of Miami Lakes Optimist Park improvements consisted of grant funded improvements identified for Miami Lakes Park as part of the Florida Recreation Development Assistance Program (FRDAP) and land and water grants. The park improvements included the picnic facilities, including two picnic pavilions, a bike path with pathway lighting, a sailboat launch, a fishing pier, light poles, landscaping and irrigation, the renovation of the existing restrooms, resurfacing of the parking lot, a canoe put-in, a water access trail, and renovations to the baseball field, soccer field, and softball field. *Design Completed:* March 2019; *Key Staff:* Stefano Viola, Marisa Maring



Westside Blueway Trail Phases I and II; Miami Gardens — Kimley-Horn provided planning and design services for the development of the Westside Blueway Trail, inclusive of the site amenities and furnishings. The firm was also tasked with providing full construction documents and specifications as required for the bidding, construction observations, and administration of the project. Kimley-Horn's responsibilities included processing applications for construction permits and securing the necessary approvals through all applicable permitting agencies, including FDOT local agency program (LAP) approval. *Completed:* Ongoing; *Key Staff:* Stefano Viola, Gary Ratay

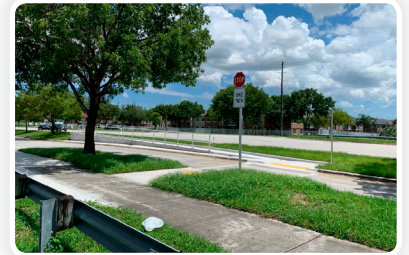

Regatta Park, Miami — The Kimley-Horn team provided landscape architecture services for Regatta Park in the City of Miami, a new 15-acre waterfront passive park that will transform the underutilized waterfront into a more cohesive and vibrant public space that will help connect the general public to the waterfront. The main features of the park include the Expo Lawn, Regatta Lawn, Tropical Gardens, Promenade, Multi-use Path Connector, Tree Alee, and Children's Play Area. Kimley-Horn was tasked with the landscape architectural and civil engineering design of the park from concept through construction administration. *Design Completed:* February 2015; *Key Staff:* Marisa Maring



Doral Legacy Park (NW 114th Avenue Park), Miami — Kimley-Horn prepared the conceptual plan and construction plans of an 18-acre park located on the corner of NW 82nd Street and NW 14th Avenue. The concept for the park consists of two adjacent sites with both active and passive recreational amenities. Park amenities include the following recreational components, community center building, baseball fields, tennis courts, basketball courts, sand volleyball, soccer fields, playground, multi-use field, walkways, boardwalk, and wetlands. *(Project)* *Design Completed:* April 2016; *Key Staff:* Marisa Maring

Vizcaya Park, City of Miramar — The first phases of the park included a soccer/multiuse field, two full-size basketball courts, and a 7,600-square-foot community center. The park's passive features include open picnic areas, a playground, and a jogging/fitness trail along the perimeter of the project site. Phase 3 of the project included the additions of a splash pad, pavilions, a second soccer field, park signage, and overflow parking. Kimley-Horn provided master planning, landscape architecture, engineering design, permitting, and construction observation/administration services. *Design Completed:* January 2016; *Key Staff:* Stefano Viola, Gary Ratay



9. Awards

Honors and Awards

For more than 20 years, **Kimley-Horn** has received a variety of awards for its professional accomplishments in terms of both project excellence and exceptional management practices. Kimley-Horn is recognized nationwide for the quality of its work environment, for its stature as a business enterprise, and for the outstanding work of its consulting staff. The firm's record of technical achievements is enhanced by their reputation for effective management and personal service. While the honors we have received measure our internal culture and abilities within the industry, the benefits Kimley-Horn offers to its clients are equally measurable—your team is made up of high-achieving, dedicated, and reliable consultants who are committed to your project.

Kimley-Horn is recognized nationwide for the quality of our work environment, for our stature as a business enterprise, and for the outstanding work of our consulting staff. Here are just a few of our recent success stories.

2019

People's Choice Award for Best Product — Safe Streets Summit – **Clematis Streetscape Improvements Phase I, West Palm Beach, FL**

Future of the Region — Tampa Bay Regional Planning Council – **Realize Bradenton and the City of Bradenton for the Creating Together Projects, Bradenton, FL**

Award of Merit — American Planning Association Florida; **Outstanding Achievement in Innovation** — Florida Planning and Zoning (FPZA) – **City of Maitland Comprehensive Plan, Maitland, FL**

Public Engagement and Outreach - Honorable Mention — Sun Coast Section - APA Florida – **Drew Street Complete Streets, Clearwater, FL**

Best Plan, Report or Study Honorable Mention — Sun Coast Section - APA Florida Annual – **St. Petersburg Complete Streets Implementation Plan, St. Petersburg, FL**

Membrane Facility of the Year — American Membrane Technology Association (AMTA) – **Town of Jupiter 15.0-MGD Nanofiltration Water Treatment Plant (WTP), Jupiter, FL**

Vernon Deines Merit Award for Outstanding Comprehensive Plan or Special Project (Small Jurisdiction) — American Planning Association (Small Town and Rural Planning Division) – **Economic Development Strategy, Williston, FL**



Clematis Streetscape

2018

National Recognition Award — American Council of Engineering Companies (ACEC) of Florida – **FITTEAM Ballpark of The Palm Beaches Spring Training Facility for the Houston Astros and Washington Nationals, West Palm Beach, FL**

Domestic Wastewater Plant Operations Excellence Award — Department of Environmental Protection – **Tropical Farms Water Treatment Plant, Martin County, FL**

Water Plant Operations Excellence Award — Department of Environmental Protection – **Tropical Farms Water Treatment Plant, Martin County, FL**

Meritorious Achievement in the Field of Infill Design — Florida Trust for Historic Preservation – **Restoration of Memorial Bradley Park, Palm Beach, FL**



Tropical Farms Water Treatment Plant

Award of Honor — Florida Chapter of American Society of Landscape Architects — **Perry Harvey Park, Tampa, FL**

President's Award — Florida Redevelopment Association — **Heritage Square Master Plan, Live Oak, FL**

Roy F. Kenzie Award for "Best Transportation and Transit Enhancements" — Florida Redevelopment Association — **5th Avenue South Bikeway and Pedestrian Trail, Lake Worth, FL**

2018 People's Choice - Great Place in America — American Planning Association — **The Riverwalk at Kennedy Boulevard Plaza, Tampa, FL**

APA Florida/Award of Merit in the Comprehensive Plan (Small Jurisdiction) Category — American Planning Association; FPZA 2018 Grass Roots/Public Involvement award Florida Planning and Zoning Association — **Venice Comprehensive Plan, Venice, FL**

2017

Project of the Year - Historic Restoration/Preservation American Public Works Association — Florida Chapter and National Award — **Restoration of Memorial Fountain in Town Hall Square, Palm Beach, FL**

Agency Excellence for Economic Impact — Florida Recreation and Park Association — **Sims Park, New Port Richey, FL**

General Aviation Airport Project of the Year — Florida Department of Transportation — **Runway 9/27 Rehabilitation Belle Glade State Municipal Airport, Belle Glade, FL**

Engineering Excellence Award for Water and Stormwater — Florida Institute of Consulting Engineers; and **Award of Excellence for Open Space Category** — Florida American Society of Landscape Architects — **Siesta Key Beach Park, Sarasota, FL**

Statewide Outstanding Redevelopment Award of Merit — Florida Planning and Zoning Association (FPZA) — **Baptist MD Anderson Cancer Center, Jacksonville, FL**

Engineering Excellence Award — Florida Institute of Consulting Engineers/ACEC Florida — **Capital Cascades Pedestrian Bridge, Blueprint 2000, Tallahassee, FL**

Envision Platinum Sustainable Infrastructure, Envision — Institution for Sustainable Infrastructure — **I-4 Ultimate Project, FDOT District Five**

Award of Honor — Florida Chapter of American Society of Landscape Architects — **Perry Harvey Park Design, Tampa, FL**

Engineering Excellence Grand Award — Florida Institute of Consulting Engineers/ACEC Florida — **STV/Ralph Whitehead Associates, Scour Evaluations for Bridges with Unknown Foundations, FDOT Districts Two, Five, and Seven**

Award for Design Excellence — AIA Tampa Bay — **The Riverwalk at Kennedy Boulevard Plaza, Tampa, FL**



Siesta Key Beach Park



Perry Harvey Park

2016

Outstanding Study/Plan — Florida Planning and Zoning Association — **Franjo Activity Center, Village of Palmetto Bay, FL**

2017 Florida Institute of Consulting Engineers Engineering Excellence Award — Florida Institute of Consulting Engineers — **Capital Cascades Connector Bridge, Blueprint 2000, Tallahassee, FL**

Roy F. Kenzie Award for "Best Transportation and Transit Enhancements" — Florida Redevelopment Association — **Federal Highway (US 1) Interim and Final Enhancements, Delray Beach, FL**

Award of Merit — Florida Chapter American Society of Landscape Architects — **Regatta Park, Miami, FL**

Outstanding Public Participation Award — Northeast Florida Planning and Zoning Association (FPZA) — **St. Johns Village (River Vue), Jacksonville, FL**

Redevelopment Project Award — Northeast Florida Planning and Zoning Association (FPZA) — **Baptist MD Anderson Cancer Center, Jacksonville, FL**

2015

Disaster or Emergency Construction/Repair — Florida Chapter American Public Works Association — **20-inch Force Main 15D Rehabilitation, Manatee County, FL**

Award of Excellence — Plan Hillsborough; **Public Sector Urban Excellence Award** — Tampa Downtown Partnership, and **H. Dean Rowe, FAIA Award for Design Excellence** — AIA Tampa Bay — **The Riverwalk at Kennedy Boulevard Plaza, Tampa, FL**

Award of Merit — International Downtown Association — **Palmetto Park Road and Boca Promenade, Boca Raton, FL**

Best Project of 2014: Residential/Hospitality — Engineering News-Record — **Streamsong Resort, Polk County, FL**

Project of the Year — ASCE, Florida Section — **Palm Beach Outlets and Marketplace, West Palm Beach, FL**

Project of the Year — American Public Works Association Florida West Coast Branch — **Zephyrhills Skate Park, Zephyrhills, FL**

Project of the Year — Florida Engineering Society Ridge Branch — **City of Lakeland Lake Hollingsworth Roundabout Improvements, Lakeland, FL**



2014

Engineering Excellence Award — Florida Institute of Consulting Engineers — **Miami-Dade Advanced Traffic Management System (ATMS) Project**

Engineering Excellence Award — Florida Institute of Consulting Engineers — **Celery Fields Regional Stormwater Facility, Sarasota County, FL**

Prize Bridge Award — National Steel Bridge Alliance — **Dixie Highway Flyover Design-Build, Boca Raton, FL**

Outstanding Development Award — Florida Planning and Zoning Association — **Nathan Benderson Park, Sarasota, FL**

Redevelopment Project Award — Northeast Florida Planning and Zoning Association (FPZA) — **Seabridge Square Shopping Center, St. Augustine, FL**

Best Tasting Drinking Water for Region VIII — American Water Works Association — **Martin County North Regional Reverse Osmosis Water Treatment Plant (Membrane Water Treatment Plant Expansion), Jensen Beach, FL**

2013

Engineering Excellence Grand Award — Florida Institute of Consulting Engineers — **Dixie Highway Flyover Design-Build, Boca Raton, FL**

Outstanding Project Award — Florida Department of Transportation/Florida Institute of Consulting Engineers — **Dixie Highway Flyover Design-Build, Boca Raton, FL**

Design-Build Honor Award (Transportation) — Design-Build Institute of America Florida Region — **Dixie Highway Flyover Design-Build, Boca Raton, FL**

Planning Award — Heart of Florida (HOF)/Florida American Planning Association — **Polk TPO Complete Streets Program, Polk County, FL**

Best New Installation — Florida Nursery, Growers and Landscape Association — **Bradenton Downtown Riverwalk**



Award of Excellence — Economic Development Division of the American Planning Association; **Award of Excellence** — Florida American Planning Association; **Award of Merit** — County Planning Division of the American Planning Association; **Distinguished Project Award and Public-Private Partnership Award** — Suncoast Section of Florida American Planning Association; and **State Award** — Florida Recreation and Park Association — **Nathan Benderson Park, Sarasota, FL**

Award of Excellence - Architectural Design — Florida Planning Association — **Palm Avenue Parking Garage, Sarasota, FL**

Project of the Year — Big Bend Chapter of the Institute of Transportation Engineers — **Tallahassee Regional Transportation Management Center, Tallahassee, FL**

RFQ #19-10

Professional Engineering Services



10.

Appendices A, B, and C (Forms)

APPENDIX "A"
ACKNOWLEDGEMENT, WARRANTY AND ACCEPTANCE

- A. Consultant warrants that it is willing and able to comply with all applicable State of Florida laws, rules and regulations.
- B. Consultant warrants that they have read, understand and are willing to comply with all of the requirements of the RFQ and the addendum/ addenda nos.
- C. Consultant warrants that it will not delegate or subcontract its responsibilities under an agreement without the prior written permission of the Council.
- D. Consultant warrants that all information provided by it in connection with this proposal is true and accurate.
- E. CONTINGENCY FEE AND CODE OF ETHICS WARRANTY:

Consultant warrants that neither it, nor any principal, employee, agent, representative or family member has promised to pay, and Consultant has not, and will not; pay a fee the amount of which is contingent upon the Town of Cutler Bay awarding this contract. Consultant warrants that neither it, nor any principal, employee, agent, representative has procured, or attempted to procure, this contract in violation of any of the provisions of the Miami-Dade County conflict of interest and code of ethics ordinances. Further, Consultant acknowledges that a violation of this warranty will result in the termination of the contract and forfeiture of funds paid, or to be paid, to the Consultant, if the Consultant is chosen for performance of the contract.

Signature of Official: _____

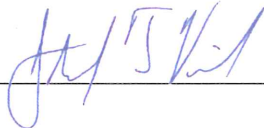

Name (typed): Stefano Viola, P.E.

Title: Vice President

Consultant: Kimley-Horn and Associates, Inc.

Date: November 22, 2019

APPENDIX "B"
NON-COLLUSIVE AFFIDAVIT

STATE OF FLORIDA)
 PALM BEACH) SS:
 COUNTY OF ~~MIAMI-DADE~~)

David W. Walthall being first duly sworn deposes and says that:

- a) He/she is the Representative, (Owner, Partner, Officer, Representative or Agent) of Kimley-Horn and Associates, Inc., the Proposer that has submitted the attached Proposal;
- b) He/she is fully informed respecting the preparation and contents of the attached Proposal and of all pertinent circumstances respecting such Proposal;
- c) Such Proposal is genuine and is not collusive or a sham Proposal;
- d) Neither the said Proposer nor any of its officers, partners, owners, agents, representatives, employees or parties in interest, including this affiant, have in any way colluded, conspired, connived or agreed, directly or indirectly, with any other Proposer, firm, or person to submit a collusive or sham Proposal in connection with the Work for which the attached Proposal has been submitted; or to refrain from proposing in connection with such work; or have in any manner, directly or indirectly, sought by person to fix the price or prices in the attached Proposal or of any other Proposer, or to fix any overhead, profit, or cost elements of the Proposal price or the Proposal price of any other Proposer, or to secure through any collusion, conspiracy, connivance, or unlawful agreement any advantage against (Recipient), or any person interested in the proposed work;
- e) The price or prices quoted in the attached Proposal are fair and proper and are not tainted by any collusion, conspiracy, connivance, or unlawful agreement on the part of the Proposer or any other of its agents, representatives, owners, employees or parties in interest, including this affiant.

Signed, sealed and delivered
 in the presence of:

Marcia Feldman
 Witness

Marcia Feldman

Witness Printed Name

By: David W. Walthall

David W. Walthall, P.E.

Senior Vice President

Title

APPENDIX "C"
SWORN STATEMENT ON PUBLIC ENTITY CRIMES
SECTION 287.133(3) (a), FLORIDA STATUTES

THIS FORM MUST BE SIGNED AND SWORN TO IN THE PRESENCE OF A NOTARY PUBLIC OR OTHER OFFICIAL AUTHORIZED TO ADMINISTER OATHS.

1. This sworn statement is submitted to the Town of Cutler Bay

by

David W. Walthall, P.E.

[Print individual's name and title]

for

Kimley-Horn and Associates, Inc.

[Print name of entity submitting sworn statement]

whose business address is

600 North Pine Island Road, Suite 450

Plantation, Fl 33324

and (if applicable) its Federal Employer Identification Number (FEIN) is
56-0885615

(If the entity has no FEIN, include the Social Security Number of the individual

signing this sworn statement: _____)

2. I understand that a "public entity crime" as defined in Paragraph 287.133(1)9g), Florida Statutes, means a violation of any state or federal law by a person with respect to and directly related to the transaction of business with any public entity or with an agency or political subdivision of any other state or the United States, including, but not limited to, any Proposal or contract for goods and services to be provided to any public entity or an agency or political subdivision of any other state or of the United States involving antitrust, fraud, theft, bribery, collusion, racketeering, conspiracy, or material misrepresentation.
3. I understand that "convicted" or "conviction" as defined in Paragraph 287.133(1) (b), Florida Statutes, means a finding of guilt or a conviction or a public entity crime, with or without an adjudication of guilt, in any federal or state trial court of record relating to charges brought by indictment or information after July 1, 1989, as a result of a jury verdict, non-jury trial, or entry of a plea of guilty or nolo contendere.

APPENDIX "C"
SWORN STATEMENT ON PUBLIC ENTITY CRIMES
SECTION 287.133(3) (a), FLORIDA STATUTES
(CONTINUED)

4. I understand than an "affiliate" as defined in Paragraph 287.133(1) (a), Florida Statutes, means:
- a. A predecessor or successor of a person convicted of a public entity crime; or
 - b. An entity under the control of any natural person who is active in the management of the entity and who has been convicted of a public entity crime. The term "affiliate" includes those officers, directors, executives, partners, shareholders, employees, members, and agents who are active in the management of an affiliate.
 - c. The ownership by one person of shares constituting a controlling interest in another person, or a pooling of equipment or income among persons when not for fair market value under an arm's length agreement, shall be a prima facie case that one person controls another person. A person who knowingly enters into a joint venture with a person who has been convicted of a public entity crime in Florida during the preceding 36 months shall be considered an affiliate.
5. I understand that a "person" as defined in Paragraph 287.133(1) (e), Florida Statutes, means any natural person or entity organized under the laws of any state or of the United States with the legal power to enter into a binding contract and which Proposals or applies to Proposal on contracts for the provision of goods or services let by a public entity, or which otherwise transacts or applies to transact business with a public entity. The term "person" includes those officers, directors, executives, partners, shareholders, employees, members, and agents who are active in the management of an entity.
6. Based on information and belief, the statement that I have marked below is true in relation to the entity submitting this sworn statement. **[Indicate which statement applies.]**

 X Neither the entity submitting this sworn statement, nor any officers, directors, executives, partners, shareholders, employees, members, or agents who are active in the management of the entity, not any affiliate of the entity, has been charged with and convicted of a public entity crime subsequent to July 1, 1989.

 This entity submitting this sworn statement, or one or more of its officers, directors, executives, partners, shareholders, employees, members, or agents who are active in the management of the entity, or an affiliate of the entity has been charged with and convicted of a public entity crime subsequent to July 1, 1989.

 The entity submitting this sworn statement, or one or more of its officers, directors, executives, partners, shareholders, employees, members, or agents who are active in the management of the entity or an affiliate of the entity has been charged with and convicted of a public entity crime subsequent to July 1, 1989. However, there has been a subsequent proceeding before a Hearing Officer of the State of Florida, Division of Administrative Hearings and the Final Order entered by the Hearing Officer determined that it was not in the public interest to place the entity submitting this sworn statement on the convicted vendor list. **[Attach a copy of the final order]**

APPENDIX "C"
SWORN STATEMENT ON PUBLIC ENTITY CRIMES
SECTION 287.133(3) (a), FLORIDA STATUTES
(CONTINUED)

I UNDERSTAND THAT THE SUBMISSION OF THIS FORM TO THE CONTRACTING OFFICER FOR THE PUBLIC ENTITY IDENTIFIED IN PARAGRAPH 1 ABOVE IS FOR THAT PUBLIC ENTITY ONLY AND, THAT THIS FORM IS VALID THROUGH DECEMBER 31 OF THE CALENDAR YEAR IN WHICH IT IS FILED. I ALSO UNDERSTAND THAT I AM REQUIRED TO INFORM THE PUBLIC ENTITY PRIOR TO ENTERING INTO A CONTRACT IN EXCESS OF THE THRESHOLD AMOUNT PROVIDED IN SECTION 287.017, FLORIDA STATUTES, FOR CATEGORY TWO OF ANY CHANGE IN THE INFORMATION CONTAINED IN THIS FORM.

David W. Walthall, P.E.

Proposer's Name Proposer's Signature

STATE OF FLORIDA)
) PALM BEACH) SS:
 COUNTY OF ~~MIAMI-DADE~~)

BEFORE ME, the undersigned authority personally appeared to me well known and known by me to be the person described herein and who executed the foregoing Affidavit and acknowledged to and before me that executed said Affidavit for the purpose therein expressed.

WITNESS, my hand and official seal this 18TH day of NOVEMBER, 2019.

Dixie L. McGaffick State of Florida at Large (Seal)
 Notary Public Signature

DIXIE L. MCGAFFICK
 Notary Name, Printed,

Commission Number: GG 257658

My Commission Expires: 9/24/2022



END OF SECTION

11. Required Firm Licenses, Certificates of Insurance, and Acknowledgement of Addendums

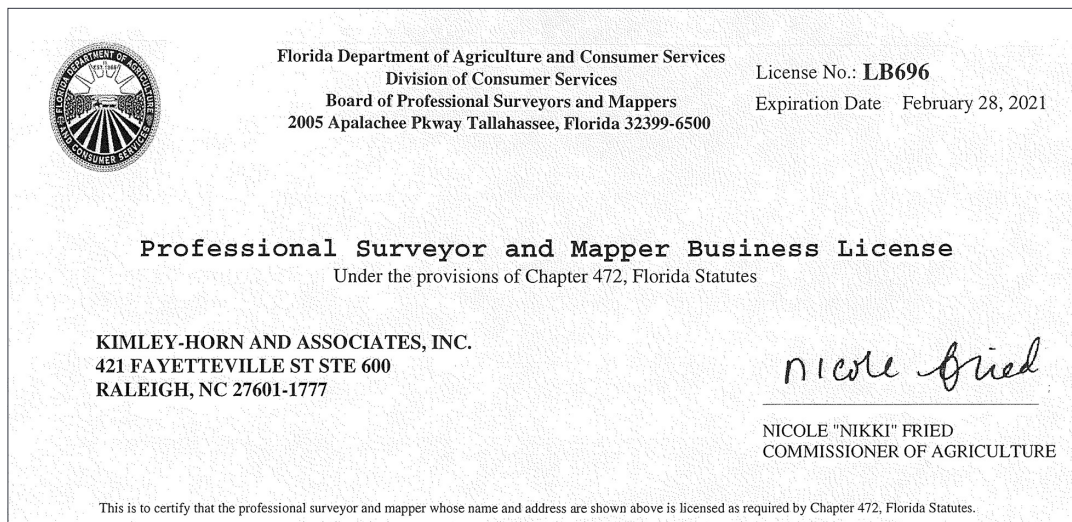
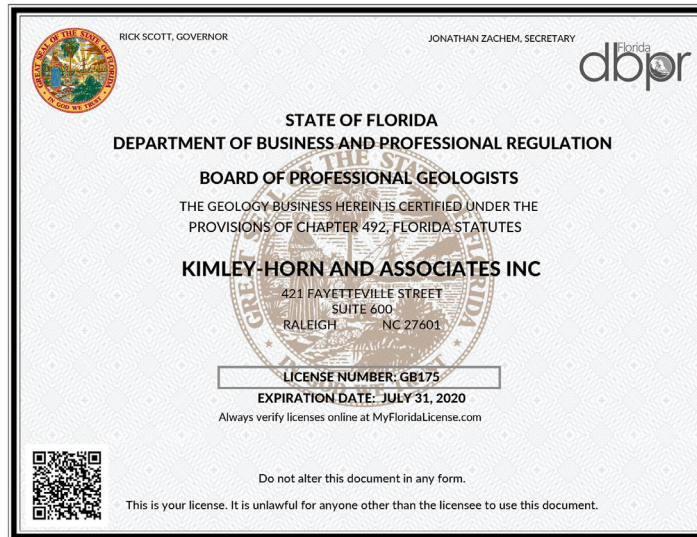
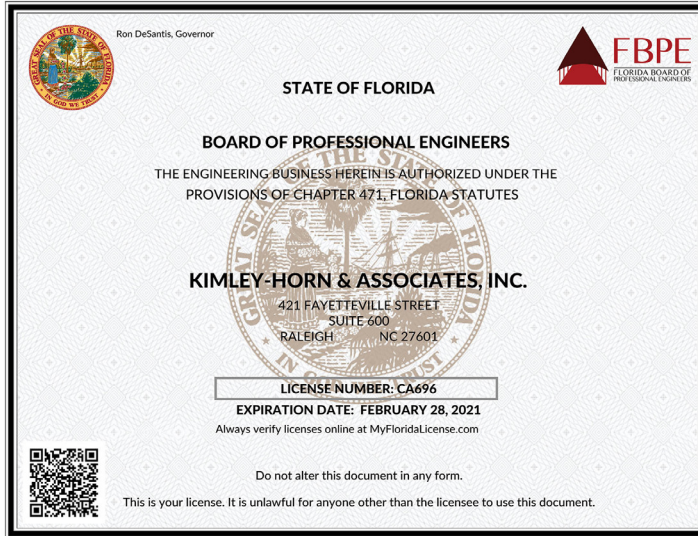

State of Florida

Department of State

I certify from the records of this office that KIMLEY-HORN AND ASSOCIATES, INC. is a North Carolina corporation authorized to transact business in the State of Florida, qualified on April 24, 1968.

The document number of this corporation is 821359.

I further certify that said corporation has paid all fees due this office through December 31, 2019, that its most recent annual report/uniform business report was filed on April 27, 2019, and that its status is active.

I further certify that said corporation has not filed a Certificate of Withdrawal.

*Given under my hand and the
Great Seal of the State of Florida
at Tallahassee, the Capital, this
the Ninth day of May, 2019*



Secretary of State

Tracking Number: 5900845381CU

To authenticate this certificate, visit the following site, enter this number, and then follow the instructions displayed.

<https://services.sunbiz.org/Filings/CertificateOfStatus/CertificateAuthentication>

RFQ #19-10

Professional Engineering Services



Client#: 25320

KIMLHORN

ACORD™

CERTIFICATE OF LIABILITY INSURANCE

DATE (MM/DD/YYYY)
3/26/2019

THIS CERTIFICATE IS ISSUED AS A MATTER OF INFORMATION ONLY AND CONFERS NO RIGHTS UPON THE CERTIFICATE HOLDER. THIS CERTIFICATE DOES NOT AFFIRMATIVELY OR NEGATIVELY AMEND, EXTEND OR ALTER THE COVERAGE AFFORDED BY THE POLICIES BELOW. THIS CERTIFICATE OF INSURANCE DOES NOT CONSTITUTE A CONTRACT BETWEEN THE ISSUING INSURER(S), AUTHORIZED REPRESENTATIVE OR PRODUCER, AND THE CERTIFICATE HOLDER.

IMPORTANT: If the certificate holder is an ADDITIONAL INSURED, the policy(ies) must have ADDITIONAL INSURED provisions or be endorsed. If SUBROGATION IS WAIVED, subject to the terms and conditions of the policy, certain policies may require an endorsement. A statement on this certificate does not confer any rights to the certificate holder in lieu of such endorsement(s).

PRODUCER Greyling Ins. Brokerage/EPIC 3780 Mansell Road, Suite 370 Alpharetta, GA 30022		CONTACT NAME: Jerry Noyola PHONE (A/C, No, Ext): 770-552-4225 FAX (A/C, No): 866-550-4082 E-MAIL ADDRESS: jerry.noyola@greyling.com															
INSURED Kimley-Horn and Associates, Inc. 421 Fayetteville Street, Suite 600 Raleigh, NC 27601		<table border="1"> <thead> <tr> <th>INSURER(S) AFFORDING COVERAGE</th> <th>NAIC #</th> </tr> </thead> <tbody> <tr> <td>INSURER A : National Union Fire Ins. Co.</td> <td>19445</td> </tr> <tr> <td>INSURER B : Aspen American Insurance Company</td> <td>43460</td> </tr> <tr> <td>INSURER C : New Hampshire Ins. Co.</td> <td>23841</td> </tr> <tr> <td>INSURER D : Lloyds of London</td> <td>085202</td> </tr> <tr> <td>INSURER E :</td> <td></td> </tr> <tr> <td>INSURER F :</td> <td></td> </tr> </tbody> </table>		INSURER(S) AFFORDING COVERAGE	NAIC #	INSURER A : National Union Fire Ins. Co.	19445	INSURER B : Aspen American Insurance Company	43460	INSURER C : New Hampshire Ins. Co.	23841	INSURER D : Lloyds of London	085202	INSURER E :		INSURER F :	
INSURER(S) AFFORDING COVERAGE	NAIC #																
INSURER A : National Union Fire Ins. Co.	19445																
INSURER B : Aspen American Insurance Company	43460																
INSURER C : New Hampshire Ins. Co.	23841																
INSURER D : Lloyds of London	085202																
INSURER E :																	
INSURER F :																	

COVERAGES

CERTIFICATE NUMBER: 19-20

REVISION NUMBER:

THIS IS TO CERTIFY THAT THE POLICIES OF INSURANCE LISTED BELOW HAVE BEEN ISSUED TO THE INSURED NAMED ABOVE FOR THE POLICY PERIOD INDICATED. NOTWITHSTANDING ANY REQUIREMENT, TERM OR CONDITION OF ANY CONTRACT OR OTHER DOCUMENT WITH RESPECT TO WHICH THIS CERTIFICATE MAY BE ISSUED OR MAY PERTAIN, THE INSURANCE AFFORDED BY THE POLICIES DESCRIBED HEREIN IS SUBJECT TO ALL THE TERMS, EXCLUSIONS AND CONDITIONS OF SUCH POLICIES. LIMITS SHOWN MAY HAVE BEEN REDUCED BY PAID CLAIMS.

INSR LTR	TYPE OF INSURANCE	ADDL INSR	SUBR WVD	POLICY NUMBER	POLICY EFF (MM/DD/YYYY)	POLICY EXP (MM/DD/YYYY)	LIMITS
A	<input checked="" type="checkbox"/> COMMERCIAL GENERAL LIABILITY <input type="checkbox"/> CLAIMS-MADE <input checked="" type="checkbox"/> OCCUR <input checked="" type="checkbox"/> Contractual Liab. GEN'L AGGREGATE LIMIT APPLIES PER: <input type="checkbox"/> POLICY <input checked="" type="checkbox"/> PROJECT <input checked="" type="checkbox"/> LOC <input type="checkbox"/> OTHER:			5268169	04/01/2019	04/01/2020	EACH OCCURRENCE \$1,000,000 DAMAGE TO RENTED PREMISES (Ea occurrence) \$500,000 MED EXP (Any one person) \$25,000 PERSONAL & ADV INJURY \$1,000,000 GENERAL AGGREGATE \$2,000,000 PRODUCTS - COMP/OP AGG \$2,000,000 \$
A	AUTOMOBILE LIABILITY <input checked="" type="checkbox"/> ANY AUTO OWNED AUTOS ONLY <input checked="" type="checkbox"/> HIRED AUTOS ONLY <input type="checkbox"/> SCHEDULED AUTOS NON-OWNED AUTOS ONLY			4489663	04/01/2019	04/01/2020	COMBINED SINGLE LIMIT (Ea accident) \$1,000,000 BODILY INJURY (Per person) \$ BODILY INJURY (Per accident) \$ PROPERTY DAMAGE (Per accident) \$ \$
B	UMBRELLA LIAB <input checked="" type="checkbox"/> OCCUR EXCESS LIAB <input checked="" type="checkbox"/> CLAIMS-MADE DED <input checked="" type="checkbox"/> RETENTION \$0			CX005FT19	04/01/2019	04/01/2020	EACH OCCURRENCE \$5,000,000 AGGREGATE \$5,000,000 \$
C	WORKERS COMPENSATION AND EMPLOYERS' LIABILITY ANY PROPRIETOR/PARTNER/EXECUTIVE OFFICER/MEMBER EXCLUDED? <input checked="" type="checkbox"/> Y <input checked="" type="checkbox"/> N (Mandatory in NH) If yes, describe under DESCRIPTION OF OPERATIONS below		N/A	015893685 (AOS) 015893686 (CA)	04/01/2019 04/01/2019	04/01/2020 04/01/2020	<input checked="" type="checkbox"/> PER STATUTE <input type="checkbox"/> OTHER E.L. EACH ACCIDENT \$1,000,000 E.L. DISEASE - EA EMPLOYEE \$1,000,000 E.L. DISEASE - POLICY LIMIT \$1,000,000
D	Professional Liab			B0146LDUSA1904949	04/01/2019	04/01/2020	Per Claim \$2,000,000 Aggregate \$2,000,000

DESCRIPTION OF OPERATIONS / LOCATIONS / VEHICLES (ACORD 101, Additional Remarks Schedule, may be attached if more space is required)

Proof of Insurance

CERTIFICATE HOLDER Sample Certificate	CANCELLATION SHOULD ANY OF THE ABOVE DESCRIBED POLICIES BE CANCELLED BEFORE THE EXPIRATION DATE THEREOF, NOTICE WILL BE DELIVERED IN ACCORDANCE WITH THE POLICY PROVISIONS. AUTHORIZED REPRESENTATIVE
---	--

© 1988-2015 ACORD CORPORATION. All rights reserved.

 ACORD 25 (2016/03) 1 of 1 The ACORD name and logo are registered marks of ACORD
 #S1529122/M1513917

JNOY1

RFQ #19-10

Professional Engineering Services



Subconsultants

Stoner and Associates

 Florida Department of Agriculture and Consumer Services
 Division of Consumer Services
 Board of Professional Surveyors and Mappers
 2005 Apalachee Pkway Tallahassee, Florida 32399-6500

License No.: **LB6633**
 Expiration Date February 28, 2021

Professional Surveyor and Mapper Business License
 Under the provisions of Chapter 472, Florida Statutes

STONER & ASSOCIATES INC
 4341 SW 62ND AVE
 DAVIE, FL 33314

Nicole Fried
 NICOLE "NIKKI" FRIED
 COMMISSIONER OF AGRICULTURE

This is to certify that the professional surveyor and mapper whose name and address are shown above is licensed as required by Chapter 472, Florida Statutes.

CERTIFICATE OF LIABILITY INSURANCE
DATE (MM/DD/YYYY)
04/09/2019

THIS CERTIFICATE IS ISSUED AS A MATTER OF INFORMATION ONLY AND CONFERS NO RIGHTS UPON THE CERTIFICATE HOLDER. THIS CERTIFICATE DOES NOT AFFIRMATIVELY OR NEGATIVELY AMEND, EXTEND OR ALTER THE COVERAGE AFFORDED BY THE POLICIES BELOW. THIS CERTIFICATE OF INSURANCE DOES NOT CONSTITUTE A CONTRACT BETWEEN THE ISSUING INSURER(S), AUTHORIZED REPRESENTATIVE OR PRODUCER, AND THE CERTIFICATE HOLDER.

IMPORTANT: If the certificate holder is an ADDITIONAL INSURED, the policy(ies) must have ADDITIONAL INSURED provisions or be endorsed. If SUBROGATION IS WAIVED, subject to the terms and conditions of the policy, certain policies may require an endorsement. A statement on this certificate does not confer rights to the certificate holder in lieu of such endorsement(s).

PRODUCER Iron Ridge Insurance 4971 Royal Gulf Circle Fort Myers FL 33966		CONTACT NAME: Karen Brinkley PHONE (A/C, No, Ext): (800) 775-8526 FAX (A/C, No): (239) 288-7544 E-MAIL ADDRESS: kbrinkley@ironridgeinsurance.com															
INSURED Stoner & Associates Inc 4341 SW 62 Avenue Davie FL 33314		INSURER(S) AFFORDING COVERAGE <table border="1" style="width: 100%; border-collapse: collapse;"> <tr> <th>INSURER</th> <th>NAIC #</th> </tr> <tr> <td>INSURER A: Travelers Property Casualty Co of America</td> <td>25674</td> </tr> <tr> <td>INSURER B: The Travelers Indemnity Company</td> <td>25658</td> </tr> <tr> <td>INSURER C: Travelers Casualty & Surety Company</td> <td>19038</td> </tr> <tr> <td>INSURER D: Liberty Insurance Underwriters, Inc</td> <td>19917</td> </tr> <tr> <td>INSURER E:</td> <td></td> </tr> <tr> <td>INSURER F:</td> <td></td> </tr> </table>		INSURER	NAIC #	INSURER A: Travelers Property Casualty Co of America	25674	INSURER B: The Travelers Indemnity Company	25658	INSURER C: Travelers Casualty & Surety Company	19038	INSURER D: Liberty Insurance Underwriters, Inc	19917	INSURER E:		INSURER F:	
INSURER	NAIC #																
INSURER A: Travelers Property Casualty Co of America	25674																
INSURER B: The Travelers Indemnity Company	25658																
INSURER C: Travelers Casualty & Surety Company	19038																
INSURER D: Liberty Insurance Underwriters, Inc	19917																
INSURER E:																	
INSURER F:																	

COVERAGES **CERTIFICATE NUMBER:** CL194904557 **REVISION NUMBER:**

THIS IS TO CERTIFY THAT THE POLICIES OF INSURANCE LISTED BELOW HAVE BEEN ISSUED TO THE INSURED NAMED ABOVE FOR THE POLICY PERIOD INDICATED. NOTWITHSTANDING ANY REQUIREMENT, TERM OR CONDITION OF ANY CONTRACT OR OTHER DOCUMENT WITH RESPECT TO WHICH THIS CERTIFICATE MAY BE ISSUED OR MAY PERTAIN, THE INSURANCE AFFORDED BY THE POLICIES DESCRIBED HEREIN IS SUBJECT TO ALL THE TERMS, EXCLUSIONS AND CONDITIONS OF SUCH POLICIES. LIMITS SHOWN MAY HAVE BEEN REDUCED BY PAID CLAIMS.

INSR LTR	TYPE OF INSURANCE	ADDL SUBR INSD WVD	POLICY NUMBER	POLICY EFF (MM/DD/YYYY)	POLICY EXP (MM/DD/YYYY)	LIMITS
A	<input checked="" type="checkbox"/> COMMERCIAL GENERAL LIABILITY <input type="checkbox"/> CLAIMS-MADE <input checked="" type="checkbox"/> OCCUR GEN'L AGGREGATE LIMIT APPLIES PER: <input type="checkbox"/> POLICY <input checked="" type="checkbox"/> PROJECT <input type="checkbox"/> LOC <input type="checkbox"/> OTHER:		680-3N344781	04/26/2019	04/26/2020	EACH OCCURRENCE \$ 1,000,000 DAMAGE TO RENTED PREMISES (Ea occurrence) \$ 1,000,000 MED EXP (Any one person) \$ 10,000 PERSONAL & ADV INJURY \$ 1,000,000 GENERAL AGGREGATE \$ 2,000,000 PRODUCTS - COMP/OP AGG \$ 2,000,000 \$
B	<input checked="" type="checkbox"/> AUTOMOBILE LIABILITY <input checked="" type="checkbox"/> ANY AUTO <input type="checkbox"/> OWNED AUTOS ONLY <input type="checkbox"/> SCHEDULED AUTOS <input checked="" type="checkbox"/> HIRED AUTOS ONLY <input checked="" type="checkbox"/> NON-OWNED AUTOS ONLY <input type="checkbox"/> AUTOS ONLY		BA-2N129733	04/26/2019	04/26/2020	COMBINED SINGLE LIMIT (Ea accident) \$ 1,000,000 BODILY INJURY (Per person) \$ BODILY INJURY (Per accident) \$ PROPERTY DAMAGE (Per accident) \$ \$
A	<input checked="" type="checkbox"/> UMBRELLA LIAB <input checked="" type="checkbox"/> OCCUR <input type="checkbox"/> EXCESS LIAB <input type="checkbox"/> CLAIMS-MADE <input type="checkbox"/> DED <input checked="" type="checkbox"/> RETENTION \$ 10,000		CUP-3N346215	04/26/2019	04/26/2020	EACH OCCURRENCE \$ 5,000,000 AGGREGATE \$ 5,000,000 \$
C	WORKERS COMPENSATION AND EMPLOYERS' LIABILITY ANY PROPRIETOR/PARTNER/EXECUTIVE OFFICER/MEMBER EXCLUDED? (Mandatory in NH) If yes, describe under DESCRIPTION OF OPERATIONS below	Y/N N/A	UB9K576125-19-47-G	05/15/2019	05/15/2020	<input checked="" type="checkbox"/> PER STATUTE <input type="checkbox"/> OTHER E.L. EACH ACCIDENT \$ 1,000,000 E.L. DISEASE - EA EMPLOYEE \$ 1,000,000 E.L. DISEASE - POLICY LIMIT \$ 1,000,000 Per Claim \$2,000,000 Aggregate \$2,000,000
D	Professional Liability		AEXNYABMOQH001	04/26/2019	04/26/2020	Aggregate \$2,000,000

DESCRIPTION OF OPERATIONS / LOCATIONS / VEHICLES (ACORD 101, Additional Remarks Schedule, may be attached if more space is required)
 Professional Liability is written on a claims-made basis

CERTIFICATE HOLDER For Proposal Purposes	CANCELLATION SHOULD ANY OF THE ABOVE DESCRIBED POLICIES BE CANCELLED BEFORE THE EXPIRATION DATE THEREOF, NOTICE WILL BE DELIVERED IN ACCORDANCE WITH THE POLICY PROVISIONS. AUTHORIZED REPRESENTATIVE 
--	---

© 1988-2015 ACORD CORPORATION. All rights reserved.

ACORD 25 (2016/03) The ACORD name and logo are registered marks of ACORD

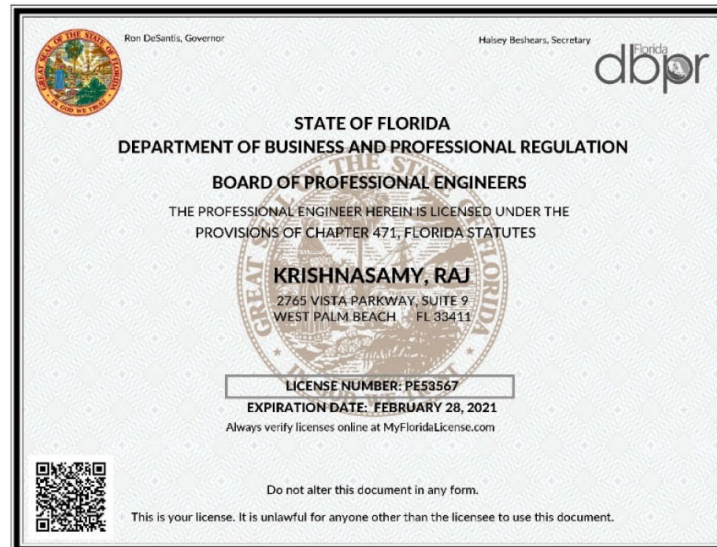
Tierra South Florida

RFQ #19-10

Professional Engineering Services



State of Florida Department of State

I certify from the records of this office that TIERRA SOUTH FLORIDA, INC. is a corporation organized under the laws of the State of Florida, filed on October 7, 2003, effective October 17, 2003.

The document number of this corporation is P03000110144.

I further certify that said corporation has paid all fees due this office through December 31, 2019, that its most recent annual report/uniform business report was filed on January 2, 2019, and that its status is active.

I further certify that said corporation has not filed Articles of Dissolution.



Given under my hand and the
Great Seal of the State of Florida
at Tallahassee, the Capital, this
the Second day of January, 2019

Ken Detjen
Secretary of State

Tracking Number: C3350331283

To authenticate this certificate, visit the following site, enter this number, and then follow the instructions displayed.

<https://services.sunbiz.org/Filings/CertificateOfStatus/CertificateAuthentication>



CERTIFICATE OF LIABILITY INSURANCE

TIERSOU-01

NGONZALEZ

DATE (MM/DD/YYYY)
5/21/2019

THIS CERTIFICATE IS ISSUED AS A MATTER OF INFORMATION ONLY AND CONFERS NO RIGHTS UPON THE CERTIFICATE HOLDER. THIS CERTIFICATE DOES NOT AFFIRMATIVELY OR NEGATIVELY AMEND, EXTEND OR ALTER THE COVERAGE AFFORDED BY THE POLICIES BELOW. THIS CERTIFICATE OF INSURANCE DOES NOT CONSTITUTE A CONTRACT BETWEEN THE ISSUING INSURER(S), AUTHORIZED REPRESENTATIVE OR PRODUCER, AND THE CERTIFICATE HOLDER.

IMPORTANT: If the certificate holder is an ADDITIONAL INSURED, the policy(ies) must have ADDITIONAL INSURED provisions or be endorsed. If SUBROGATION IS WAIVED, subject to the terms and conditions of the policy, certain policies may require an endorsement. A statement on this certificate does not confer rights to the certificate holder in lieu of such endorsement(s).

PRODUCER Ames & Gough 8300 Greensboro Drive Suite 980 McLean, VA 22102		CONTACT NAME PHONE (A/C, No, Ext): (703) 827-2277 E-MAIL Address: admin@amesgough.com		FAX (A/C, No): (703) 827-2279	
INSURED Tierra South Florida, Inc 2765 Vista Parkway, H7-H10 West Palm Beach, FL 33411		INSURER(S) AFFORDING COVERAGE INSURER A: National Union Fire Insurance Company		NAIC # 19445	
		INSURER B: National Union Fire Ins. Co. of Pittsburgh, PA A (XV)		19445	
		INSURER C: Continental Insurance Company A(XV)		35289	
		INSURER D: Continental Casualty Company (CNA) A, XV		20443	
		INSURER E:			
		INSURER F:			

COVERAGES		CERTIFICATE NUMBER:		REVISION NUMBER:			
THIS IS TO CERTIFY THAT THE POLICIES OF INSURANCE LISTED BELOW HAVE BEEN ISSUED TO THE INSURED NAMED ABOVE FOR THE POLICY PERIOD INDICATED. NOTWITHSTANDING ANY REQUIREMENT, TERM OR CONDITION OF ANY CONTRACT OR OTHER DOCUMENT WITH RESPECT TO WHICH THIS CERTIFICATE MAY BE ISSUED OR MAY PERTAIN, THE INSURANCE AFFORDED BY THE POLICIES DESCRIBED HEREIN IS SUBJECT TO ALL THE TERMS, EXCLUSIONS AND CONDITIONS OF SUCH POLICIES. LIMITS SHOWN MAY HAVE BEEN REDUCED BY PAID CLAIMS.							
INSR LTR	TYPE OF INSURANCE		ADOL SUBR INSD WVD	POLICY NUMBER	POLICY EFF (MM/DD/YYYY)	POLICY EXP (MM/DD/YYYY)	LIMITS
A	X	COMMERCIAL GENERAL LIABILITY					
		CLAIMS-MADE X OCCUR		9925653	6/1/2019	6/1/2020	EACH OCCURRENCE \$ 1,000,000
							DAMAGE TO RENTED PREMISES (Ea occurrence) \$ 500,000
							MED EXP (Any one person) \$ 25,000
							PERSONAL & ADV INJURY \$ 1,000,000
							GENERAL AGGREGATE \$ 2,000,000
							PRODUCTS - COMPOP AGG \$ 2,000,000
	GEN'L AGGREGATE LIMIT APPLIES PER:						
	X	POLICY X PROJECT LOC					
		OTHER:					
B		AUTOMOBILE LIABILITY					
	X	ANY AUTO OWNED AUTOS ONLY SCHEDULED AUTOS		4544957	6/1/2019	6/1/2020	COMBINED SINGLE LIMIT (Ea accident) \$ 1,000,000
		HIREN AUTOS ONLY NON-OWNED AUTOS					BODILY INJURY (Per person) \$
							BODILY INJURY (Per accident) \$
							PROPERTY DAMAGE (Per accident) \$
C	X	UMBRELLA LIAB X OCCUR					
		EXCESS LIAB CLAIMS-MADE		6072223686	6/1/2019	6/1/2020	EACH OCCURRENCE \$ 5,000,000
		DED X RETENTION \$ 10,000					AGGREGATE \$ 5,000,000
B		WORKERS COMPENSATION AND EMPLOYERS' LIABILITY					
		ANY PROPRIETOR/PARTNER/EXECUTIVE OFFICER/MEMBER EXCLUDED? (Mandatory in WA)	Y/N N/A	039326871	6/1/2019	6/1/2020	X PER STATUTE OR OTHER \$ 1,000,000
		If yes, describe under DESCRIPTION OF OPERATIONS below					E.L. EACH ACCIDENT \$ 1,000,000
							E.L. DISEASE - EA EMPLOYEE \$ 1,000,000
							E.L. DISEASE - POLICY LIMIT \$ 1,000,000
D		Professional		MCH591879490	6/1/2019	6/1/2020	Per Claim \$ 1,000,000
D		Liability		MCH591879490	6/1/2019	6/1/2020	Aggregate \$ 2,000,000

DESCRIPTION OF OPERATIONS / LOCATIONS / VEHICLES (ACORD 101, Additional Remarks Schedule, may be attached if more space is required)

CERTIFICATE HOLDER	CANCELLATION
For Proposal Purposes	SHOULD ANY OF THE ABOVE DESCRIBED POLICIES BE CANCELLED BEFORE THE EXPIRATION DATE THEREOF, NOTICE WILL BE DELIVERED IN ACCORDANCE WITH THE POLICY PROVISIONS.
	AUTHORIZED REPRESENTATIVE

ACORD 25 (2016/03)

© 1988-2015 ACORD CORPORATION. All rights reserved.

The ACORD name and logo are registered marks of ACORD