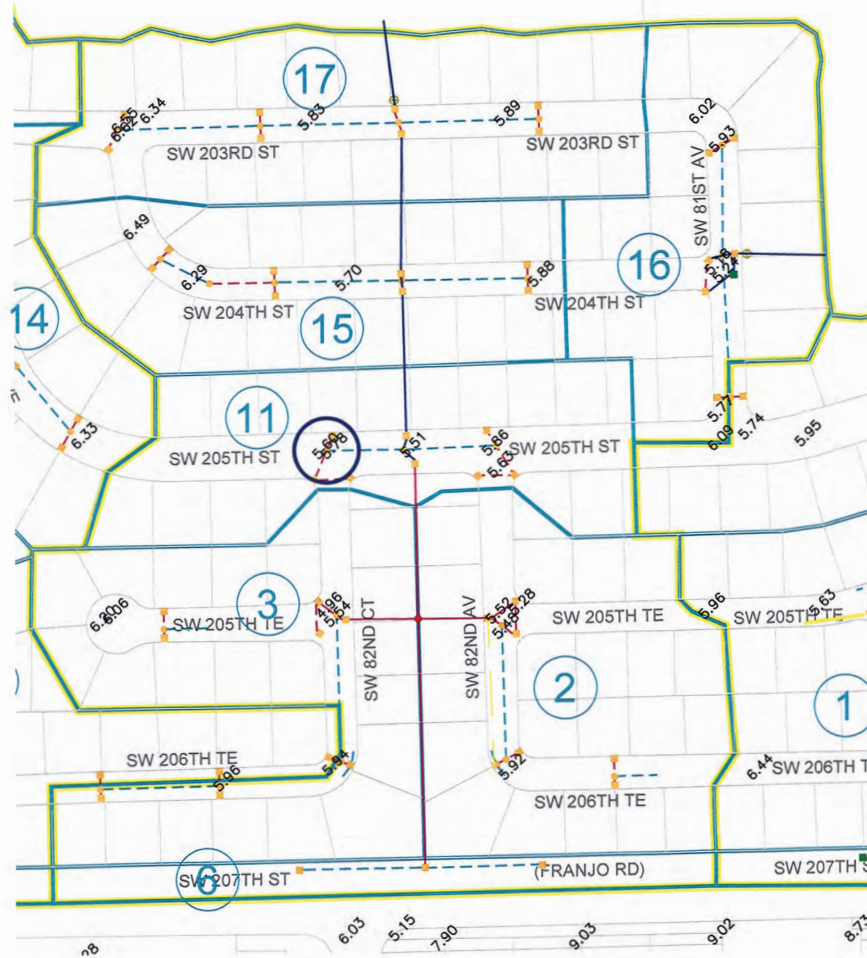
**LEGEND**

- EXIST./PROP. OUTFALL PIPE
- EXIST./PROP. DRAINAGE PIPE
- EXIST./PROP. FRENCH DRAIN
- AREA DELINEATION
- SUB-BASIN GROUP
- EXIST./PROP. CATCH BASIN
- EXIST./PROP. MANHOLE
- PROP. REGRADING
- # AREA NUMBER
- KHA OBSERVED PONDING
- KHA OBSERVED FLOODING
- TOWN COMPLAINT LOCATIONS

SUMMARY OF PROPOSED MODIFICATIONS

- REPLACE 2 C.B. WITH WEIR STRUCTURES
- REPLACE 15 EXISTING CATCH BASINS
- REPLACE 1 EXISTING MANHOLE
- ADD 13 MANHOLES
- ADD 3 CATCH BASINS
- ADD 610 LF 18" PIPE
- ADD 1,400 LF FRENCH DRAIN

**AREA 2 PROPOSED MODIFICATIONS**

- REPLACE 3 EXIST. CATCH BASINS
- ADD 2 MANHOLES
- ADD 65 LF OF 18" PIPE
- ADD 220 LF OF FRENCH DRAIN

AREA 3 PROPOSED MODIFICATIONS

- REPLACE 3 EXIST. CATCH BASINS
- ADD 2 MANHOLES
- ADD 110 LF OF 18" PIPE
- ADD 230 LF OF FRENCH DRAIN

AREA 6 PROPOSED MODIFICATIONS

- REPLACE 1 EXIST. CATCH BASIN
- ADD 1 MANHOLE
- ADD 20 LF OF 18" PIPE
- ADD 85 LF OF FRENCH DRAIN

AREA 11 PROPOSED MODIFICATIONS

- REPLACE 2 EXIST. CATCH BASINS
- REPLACE 1 EXIST. MANHOLE
- ADD 2 MANHOLES
- ADD 3 CATCH BASINS
- ADD 200 LF OF 18" PIPE
- ADD 190 LF OF FRENCH DRAIN

AREA 15 PROPOSED MODIFICATIONS

- REPLACE 2 EXIST. CATCH BASINS
- ADD 2 MANHOLES
- ADD 45 LF OF 18" PIPE
- ADD 210 LF OF FRENCH DRAIN

AREA 16 PROPOSED MODIFICATIONS

- REPLACE 1 C.B. WITH WEIR STRUCTURE
- REPLACE 3 EXIST. CATCH BASINS
- ADD 2 MANHOLES
- ADD 115 LF OF 18" PIPE
- ADD 205 LF OF FRENCH DRAIN

AREA 17 PROPOSED MODIFICATIONS

- REPLACE 1 C.B. WITH WEIR STRUCTURE
- REPLACE 1 EXIST. CATCH BASINS
- ADD 2 MANHOLES
- ADD 55 LF OF 15" PIPE
- ADD 260 LF OF FRENCH DRAIN



© 2007 KIMLEY-HORN AND ASSOCIATES, INC.
5200 NW 33rd Avenue, Suite 109, Fort Lauderdale, FL 3309
PHONE (954) 535-5100 FAX (954) 739-2247
WWW.KIMLEY-HORN.COM CA 00000696

TOWN OF CUTLER BAY STORMWATER MASTER PLAN

SAGA BAY 1.7 SUB-BASIN

FIGURE 21