



***Application No.:***

***V-2018-025(d)***

## **Attachment "C"**

**Advertisement, Courtesy Notice, and Posting**

**Ross Stores Inc**

**VARIANCE**

**V-2018-025(d)**

A RESOLUTION OF THE MAYOR AND TOWN COUNCIL OF THE TOWN OF CUTLER BAY, FLORIDA, APPROVING A VARIANCE APPLICATION FOR ROSS LOCATED AT 18437 S. DIXIE HIGHWAY, TO **PERMIT SIX (6) BANNER SIGNS WHERE FOUR (4) PER YEAR ARE PERMITTED**; AND PROVIDING FOR AN EFFECTIVE DATE.



MOVIES

# ‘Ant-Man’ sequel brings female characters to the forefront

BY MIKE CIDONI LENNOX  
Associated Press

LOS ANGELES

The “Ant-Man” sequel may be about tiny super-heroes, but the film is making a big statement about female empowerment by featuring Evangeline Lilly’s The Wasp not only in the title, but giving her a larger stake in Marvel’s sprawling movie franchise.

“Ant-Man and The Wasp” — the 20th film in the Marvel cinematic universe, which includes “Black Panther,” “Iron Man,” and “Avengers: Infinity War” — is the first one in the series to include a female character in a title role. The prominence of The Wasp, a character who has major roles in the “Ant-Man” and “Avengers” comic books, comes after years of fan anticipation for a female Marvel superhero to get her own film. Scarlett Johansson has expressed her desire to see her character, Black Widow, get a standalone film, but Marvel Studios has kept her primarily in its marquee “Avengers” films.

“You know, I’ve asked myself the same question: Are we making a mountain out of a molehill?” Lilly said during a recent interview when asked about being featured in a Marvel film’s title. She said after considering it

more closely, “ ‘No, actually, this is kind of a big deal, and this is about time.’ ”

The film is the sequel to 2015’s “Ant-Man,” which introduced Paul Rudd as a thief enlisted by Michael Douglas’ Hank Pym to become a do-gooder. The original earned more than \$180 million in North America and \$500 million at the global box office. The sequel is the third Marvel Films release this year, but it largely steers clear of the developments in the blockbuster “Avengers: Infinity War.”

The Wasp was a comic-book favorite of director Peyton Reed, who teased her appearance in future Marvel films with a cameo of her supersuit at the end of “Ant-Man.”

He said it was important that The Wasp be a fully-formed hero and not bound by stereotypes.

“I worked really closely with Evangeline, and we talked about, ‘Now we’re going to have a chance to make a fully-formed hero, and we want her to be as dimensional as possible. And we don’t want her to be a hero who is always glammed up with hair and makeup. We wanted her to be a little sweaty. And we want her, like, when that helmet comes off, her hair is in a ponytail, because that’s the practical thing you would do,’ ” Reed said.

Lilly’s role isn’t the



Disney/Marvel Studios via AP

Paul Rudd, top, Evangeline Lilly, below left, and Hannah John-Kamen, below right, in ‘Ant-Man and the Wasp.’



Disney/Marvel Studios via AP



BEN ROTHSTEIN Disney/Marvel Studios via AP

only prominent female character in the film. Hannah John-Kamen plays Ghost, a villain bent

on sowing discord among powerful institutions, in a role that was initially written for a man.

“It’s amazing, as a female, to play such a strong character ... so that people can look up to that and see that, ‘Yeah, this is a progression,’ ” said John-Kamen, who is in her biggest role yet after starring in the Canadian sci-fi series “Killjoys” and having small roles in “Ready Player One” and “Tomb Raider.”

“There is so much more going on in this film that represents female energy, that represents female stories, that represents female struggle, and that represents female power,” Lilly said.

“In this film, I’m very proud to say I recognize authentic female power in that it’s powerful to be vulnerable, it’s powerful to be elegant, it’s powerful to be graceful and nurturing and kind and forgiving and compas-

sionate and generous ... things that tend to be typically categorized as weaknesses.”

Marvel’s first film based solely on a female superhero will be the 1990s’ set “Captain Marvel,” which stars Brie Larson in the title role and is slated for release next year.

“Ant-Man and The Wasp” is the first Marvel film to be released after April’s “Infinity War,” which upended the franchise and set up a fourth “Avengers” film that will be released next summer.

The “Ant-Man and The Wasp” cast are keeping any secrets about that film closely guarded. During a recent interview, Rudd started to answer a question about his character’s role going forward in Marvels films.

“A funny story, because, you know, in ‘Avengers 4,’ ” he said, before pretending to be hit in the neck with a dart

and falling out of his chair.

Douglas said before his first Comic-Con panel about the original “Ant-Man,” he underwent secrecy tests — and thought he might have to give blood — to prove that he could keep from spoiling that film’s secrets.

While he thought it was a bit much at the time, Douglas said he has grown to appreciate what Marvel Films has done and the care they take to avoid spoilers for fans.

“Marvel has done this amazing job of creating buzz just for people not knowing what exactly is going to happen,” Douglas said.

“We do not want to spoil things for people. There are people out there hired to try and find things out,” Rudd said. “It’s an amazing, intense thing to be a part of.”



## TOWN OF CUTLER BAY NOTICE OF PUBLIC HEARING

The Town of Cutler Bay will be holding a public hearing on **Wednesday, July 18, 2018 at 8:00 p.m.**, or as soon thereafter as possible, in the Town Hall Council Chambers, 10720 Caribbean Boulevard, Cutler Bay, Florida. The purpose of the public hearing(s) is to consider the adoption of the Resolution(s) described below:

**A RESOLUTION OF THE MAYOR AND TOWN COUNCIL OF THE TOWN OF CUTLER BAY, FLORIDA, APPROVING A VARIANCE APPLICATION FOR ROSS STORES INC., LOCATED AT 18437 S. DIXIE HIGHWAY, TO PERMIT FOUR (4) WALL SIGNS WHERE ONE (1) IS PERMITTED; AND PROVIDING FOR AN EFFECTIVE DATE.**

**A RESOLUTION OF THE MAYOR AND TOWN COUNCIL OF THE TOWN OF CUTLER BAY, FLORIDA, APPROVING A VARIANCE APPLICATION FOR ROSS STORES INC., LOCATED AT 18437 S. DIXIE HIGHWAY, TO PERMIT A WALL SIGN TO BE 511 SQUARE FEET WHERE 60 SQUARE FEET IS PERMITTED; AND PROVIDING FOR AN EFFECTIVE DATE.**

**A RESOLUTION OF THE MAYOR AND TOWN COUNCIL OF THE TOWN OF CUTLER BAY, FLORIDA, APPROVING A VARIANCE APPLICATION FOR ROSS STORES INC., LOCATED AT 18437 S. DIXIE HIGHWAY, TO PERMIT A WALL SIGN TO BE 144 SQUARE FEET WHERE NO SIGN IS PERMITTED; AND PROVIDING FOR AN EFFECTIVE DATE.**

**A RESOLUTION OF THE MAYOR AND TOWN COUNCIL OF THE TOWN OF CUTLER BAY, FLORIDA, APPROVING A VARIANCE APPLICATION FOR ROSS STORES INC., LOCATED AT 18437 S. DIXIE HIGHWAY, TO PERMIT SIX (6) BANNER SIGNS PER YEAR WHERE FOUR (4) PER YEAR ARE PERMITTED; AND PROVIDING FOR AN EFFECTIVE DATE.**

**A RESOLUTION OF THE MAYOR AND TOWN COUNCIL OF THE TOWN OF CUTLER BAY, FLORIDA, APPROVING A VARIANCE APPLICATION FOR ROSS STORES INC., LOCATED AT 18437 S. DIXIE HIGHWAY, TO PERMIT TWO (2) BANNER SIGNS TO BE 144 SQUARE FEET WHERE SIXTEEN (16) SQUARE FEET IS PERMITTED; AND PROVIDING FOR AN EFFECTIVE DATE.**

**A RESOLUTION OF THE MAYOR AND TOWN COUNCIL OF THE TOWN OF CUTLER BAY, FLORIDA, APPROVING A VARIANCE APPLICATION FOR ROSS STORES INC., LOCATED AT 18437 S. DIXIE HIGHWAY, TO PERMIT FOUR (4) BANNER SIGNS TO BE FORTY EIGHT (48) SQUARE FEET WHERE SIXTEEN (16) SQUARE FEET IS PERMITTED; AND PROVIDING FOR AN EFFECTIVE DATE.**

The Town Council may continue or defer the hearing(s) to a new date and time certain without further notice provided the date and time of the continuance or deferral is announced at the hearing(s). The Resolution(s) in its entirety may be inspected at the Office of the Town Clerk during regular business hours.

Persons wishing to appeal any decisions made by the Town Council with respect to any matter considered at such hearing(s) will need a record of the proceedings and; for such purpose, may need to ensure that a verbatim record of the proceedings is made; which includes the testimony and evidence upon which the appeal is to be based (F.S. 286.0105).

Any and all interested parties may appear at the above meeting and be heard with respect to the proposed items.

In accordance with the Americans with Disabilities Act of 1990 (ADA), persons needing special accommodations to participate in these proceedings should contact the Town Clerk’s Office for assistance at (305) 234-4262, no later than four (4) business days prior to such proceeding.

Debra E. Eastman, MMC  
Town Clerk

# Russia WORLD CUP 2018

WATCH THE GAMES ON THE BIG SCREEN

## GRILL Argentino

**5 BEERS & 4 EMPANADAS & 2 CHORIZOS FOR ONLY \$35**

**7744 N KENDALL DR MIAMI FL 33156 305 274 8850**

FACEBOOK / GRILL-ARGENTINO

GRILL ARGENTINO

INSTAGRAM / GRILLARGENTINO

FIND US ON YELP, TRIPADVISOR & OPEN TABLE





**TOWN OF CUTLER BAY  
PLANNING AND ZONING DIVISION**

**AFFIDAVIT OF MAILING - COURTESY NOTICE**

On 6/29/2018, I Kathryn Lyon,  
mailed 406 Courtesy Notices via First Class Mail. The mailing  
labels were provided by Cutro & Associates (copy attached),  
for the purpose of informing adjacent property owners of an upcoming Public  
Hearing for Application # V-2018-025 (a) thru (f).

---

For Office Use

KATHRYN LYON  
(Planning & Zoning Director)

K Lyon  
(Signature)

7/2/18  
(Date)



## CERTIFICATION LETTER

**City of Cutler Bay**

**Date:** April 12, 2018

**Applicant:** It's Permittable, for Ross Dress for Less

**Legal Description:** Portion of Tract A of South Dade Shopping Center as recorded in Plat Book 123 Page 68 of the Public Records of Miami-Dade County, Florida.

**Location:** 18437 S. Dixie Highway

**Type of Application:** Sign Variance

This letter certifies that the attached list of property owners was prepared using the latest tax folio rolls supplied by the Miami-Dade County GIS Office as of April 10, 2018. This list includes all properties within 1,000 feet from each property line of the subject site in compliance with the City of Cutler Bay notification regulations.

Thank You,

Christina Mathews

Sworn and subscribed before me this 12<sup>th</sup> day of April, 2018. She is personally known to me.

Signature of Notary

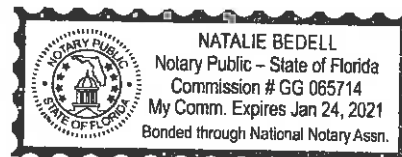

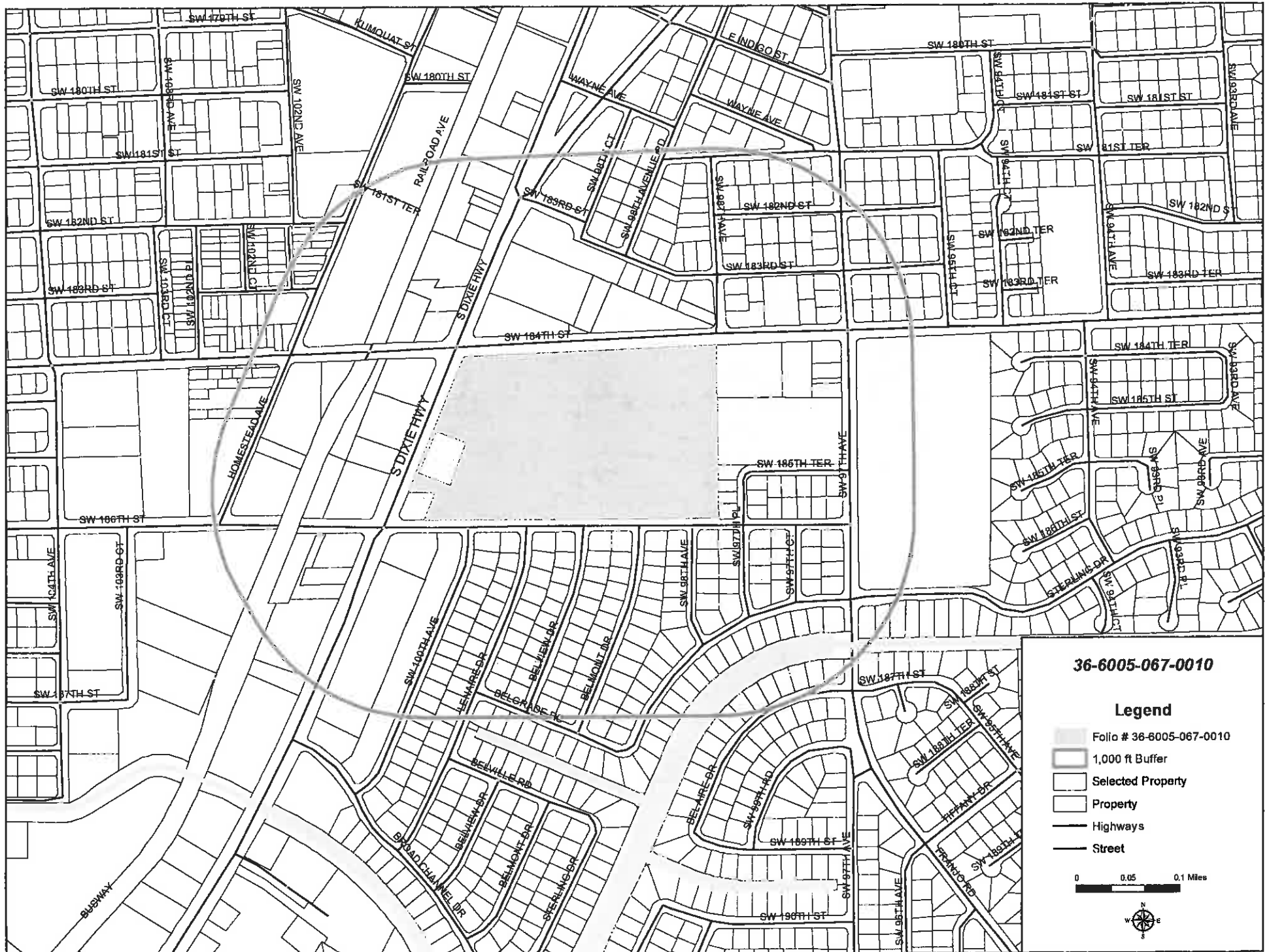

FOLIO	SITE ADDRESS	NAME	MAILING ADD	CITY STATE ZIP	LEGAL
3050320001451	18398 S DIXIE HWY	EUREKA SERVICE STATION LLC	9701 NW 89 AVE	MEDLEY, FL 33178	32° 55' 40" S 1° 01' 00" W 1/4 BEG 54.54 FT NELY OF X OF S 1/4 OF SEC 5 & W R/W/L SR 5 CONT NELY 133.99 FT W 150 FT SWLY 150 FT E 133.99 FT N 55 DEG E 26.96 FT TO POB OR 16450-3778 0794 2 (3) COC 26044-0410 11 2007 2
3050320001452	18300 S DIXIE HWY	EUREKA SERVICE STATION LLC	9701 NW 89 AVE	MEDLEY, FL 33178	32° 55' 40" 902 AC M/L BEG 394.79 FT E & 38.54 FT NELY OF SW COR OF SE 1/4 TH N 22 DEG E 298.93 FT S 67 DEG E 128.71 FT S 45.42 FT S 17 DEG W 38.29 FT S 22 DEG W 150 FT W 166.21 FT TO POB LOT SIZE 39292 SQ FT OR 16450-3778 0794 2 (3) COC 26044-0410 11 2007 2
3050320001453	18300 S DIXIE HWY	EUREKA SERVICE STATION LLC	9701 NW 89 AVE	MEDLEY, FL 33178	32° 55' 40" 686 AC M/L BEG 711 FT E & 188.54 FT NELY OF SW COR OF SE 1/4 TH N 22 DEG E 143.29 FT W 165 FT N 22 DEG E 40 FT W 151.58 FT S 22 DEG W 33.51 FT S 67 DEG E 128.71 FT S 45.42 FT S 17 DEG W 38.29 FT E 150 FT TO POB OR 16450-3778 0794 2 (3) COC 26044-0410 11 2007 2
3050320001462	18200 S DIXIE HWY	18200 DIXIE LLC	6218 N FEDERAL HWY	FORT LAUDERDALE, FL 33308	32° 55' 40" 344 AC PT SW 1/4 OF SE 1/4 BEG X NWLY R/W/L SR 5 & S/L N 1/2 OF S 1/2 OF SW 1/4 OF SE 1/4 NELY 250 FT TO POB CONT NELY 100 FT NWLY 150 FT SWLY 100 FT SELY 150 FT TO POB LOT SIZE 100.000 X 150 OR 18447-2621 1298 5 COC 24476-4949 04 2006 5
3050320001463	18100 S DIXIE HWY	AEI NATIONAL INCOME FUND VIII LP	30 E 7 ST	ST PAUL, MN 55101	32° 55' 40" 1.32 AC BEG AT A PT ON W/L SR 5 & S 1/4 OF N 1/2 OF NY 2 OF SW 1/4 OF SE 1/4 CONT SWLY 200 FT TH NWLY AT RA FOR 287.32 FT TO R/W REC TH NELY 200 FT SELY 287.32 FT TO POB OR 15543-0438 0692 1 COC 22150-3265 03 2004 5
3050320001490	18250 S DIXIE HWY	SONNENKLAR LTD PARTNERSHIP	2390 NW 107 AVE	MIAMI, FL 33172-2103	32° 55' 40" 34 AC BEG AT X OF NW R/W/L SR 5 & S/L OF N 1/2 OF S 1/2 OF SW 1/4 OF SE 1/4 TH NE ALG R/W/L 150 FT TO POB TH CONT NE 100 FT NW 150 FT SW 100 FT SE 150 FT TO POB LOT SIZE 100.000 X 150 OR 18746-0515 THRU 518 0899 5
3050320001510		CONSTANCE GILBERT & JAMES ROLLIE JR	3348 WILLIAMS AVE	MIAMI, FL 33133-5834	32° 55' 40" 47 AC BEG AT X OF HMSTD AVE & S/L OF NW 1/4 SW 1/4 W ALG S/L 100 FT NE 150 FT E 100 FT TO W/L HMSTD AVE SW 150 FT TO POB LOT SIZE: 150.000 X 95 OR 9536 651 COC 22072-4147 02 2004 4
3050320001520		MIAMI-DADE COUNTY MIAMI-DADE TRANSIT	701 NW 1 CT STE 1700	MIAMI, FL 33136-3902	32° 55' 40" 10 AC 100 FT REC R/W ACROSS SEC FORMERLY PEC RR/COMPTROLLER DOT OR 13936-2071 0688 3 OR 20119-0538 12-01 3 COR OF LOT 1 BLK 20 OF PB B-79 TH S 22 DEG W 383.19 FT NELY AD 91.51 FT N 27 DEG E 200 FT NELY AD 82.8 FT N 22 DEG E 9.91 FT N 67 DEG W 25 FT TO
3050320140010	18200 HOMESTEAD AVE	LOUISE BAKER	13731 VAN BUREN ST	MIAMI, FL 33176-6248	PLAT OF BLOCKS 2-3-4-5 OF MIDWAY PB 6-109 LOT 1 LESS SELY 5 FT R/W BLK 2 LOT SIZE 40.000 X 112 OR 20258-0791 1101 1
3050320140020	18210 HOMESTEAD AVE	DO IT WELL CONSTRUCTION INC	10410 SW 182 ST	MIAMI, FL 33157-5210	PLAT OF BLOCKS 2-3-4-5 OF MIDWAY PB 6-109 LOT 2 LESS SELY 5 FT R/W BLK 2 LOT SIZE 40.000 X 95 COC 24686-3006 01 2006 4
3050320140030	18214 HOMESTEAD AVE	OTIS ARMSTRONG JR	18214 HOMESTEAD AVE	MIAMI, FL 33157-5532	PLAT OF BLOCKS 2-3-4-5 OF MIDWAY PB 6-109 LOT 3 LESS SELY 5 FT R/W BLK 2 LOT SIZE 40.000 X 78 OR 16579-1197 1094 4
3050320140040	18216 SW 102 AVE	ELIZABETH A CRYER KAREN CRYER DOUTHIT	3701 BAHAMA DR	MIRAMAR, FL 33023	PLAT OF BLOCKS 2-3-4-5 OF MIDWAY PB 6-109 LOT 4 LESS SELY 5 FT BLK 2 LOT SIZE 40.000 X 160
3050320140050	18222 HOMESTEAD AVE	A M A DEVELOPMENT GROUP LLC	20900 NE 30 AVE	AVENTURA, FL 33180	PLAT OF BLOCKS 2-3-4-5 OF MIDWAY PB 6-109 LOT 5 LESS SELY 5 FT R/W BLK 2 LOT SIZE 40.000 X 141 COC 26122-1504 12 2007 4
3050320140060	18234 HOMESTEAD AVE	A M A DEVELOPMENT GROUP LLC	20900 NE 30 AVE	AVENTURA, FL 33180	PLAT OF BLOCKS 2-3-4-5 OF MIDWAY PB 6-109 LOT 6 LESS SELY 5 FT R/W BLK 2 LOT SIZE 40.000 X 128 OR 13724-1867 0688 3 COC 26122-1506 12 2007 6
3050320140070		A M A DEVELOPMENT GROUP LLC	20900 NE 30 AVE	AVENTURA, FL 33180	PLAT OF BLOCKS 2-3-4-5 OF MIDWAY PB 6-109 LOT 7 LESS SELY 5 FT R/W BLK 2 LOT SIZE 30.000 X 113 COC 26135-3568 12 2007 6
3050320140080		A M A DEVELOPMENT GROUP LLC	20900 NE 30 AVE	AVENTURA, FL 33180	PLAT OF BLOCKS 2-3-4-5 OF MIDWAY PB 6-109 LOT 8 LESS SELY 5 FT R/W BLK 2 LOT SIZE 30.000 X 100 COC 26135-3568 12 2007 6
3050320140090	18215 SW 102 AVE	MOSES WORD & W SARAH	18215 SW 102 AVE	MIAMI, FL 33157-5218	PLAT OF BLOCKS 2-3-4-5 OF MIDWAY PB 6-109 LOT 9 BLK 2 LOT SIZE 40.000 X 100 OR 16405-5182 1293 4 OR 16405-5183 1293 4 OR 16405-5183 0594 4 COC 25607-4653 04 2007 5
3050320140100	18211 SW 102 AVE	KARLA J CAREY	776 THIGPEN TRL	DOERUN, GA 31744	23° 55' 40" PB 6-109 PLAT OF BLOCKS 2-3-4-5 OF MIDWAY LOT 10 BLK 2 LOT SIZE 40.000 X 100 OR 19775-2447 0198 1
3050320140170	18290 SW 102 AVE	BIBLEWAY CH OF THE APOS FAITH INC	18290 SW 102 AVE	MIAMI, FL 33157-5219	PLAT OF BLOCKS 2-3-4-5 OF MIDWAY PB 6-109 LOTS 7 & 8 BLK 3 LOT SIZE 60.600 X 100 OR 14424-2777 0190 4
3050320150030	10200 SW 183 ST	C & A CREDIT FUNDING CORP	140 NE 2 AVE	MIAMI, FL 33132	MIDWAY PB 3-177 LOTS 1-2-3-26-27 & 28 LESS SELY 5 FT OF \$49.51 FT OF LOT 2 & SELY 5 FT OF LOT 3 FOR R/W LOT SIZE 28904 SQ FT
3050320150040	18334 HOMESTEAD AVE	EVERET P WATSON & W JULIE B	12441 SW 194 ST	MIAMI, FL 33177-6547	32° 55' 40" MIDWAY PB 3-177 LOT 4 LESS ELY 5 FT & LOT 5 LESS ELY 5 FT & 515 FT FOR R/W OR 16574-1327 1094 6
3050320150050	10203 SW 184 ST	EVERET WATSON & W JULIE	7741 SW 184 TERR	MIAMI, FL 33157-7464	32° 55' 40" MIDWAY PB 3-177 LOT 6 LOT SIZE 40.000 X 145 OR 20616-0571 082002 1
3050320150060	10215 SW 184 ST	EMMA JEAN MATHIS BOUIE	10295 SW 182 ST	MIAMI, FL 33157	MIDWAY PB 3-177 LOT 7 LESS 515 FT LOT SIZE 40 X 130
3050320150070	10219 SW 184 ST	EMMA JANE BOUIE	10295 SW 182 ST	MIAMI, FL 33157-5248	32° 55' 40" LOT 8 LESS 515 FT LOT SIZE 40 X 130 LOT SIZE 40.000 X 145 75R 29550
3050320150080	10221 SW 184 ST	MIAMI-DADE COUNTY SD RE MGMT	111 NW 1 ST STE 2460	MIAMI, FL 33128	32° 55' 40" MIDWAY PB 3-177 LOT 9 LESS 515 FT LOT SIZE 40 X 130
3050320150220		CAZO CONSTRUCTION CORP	3461 SW 8 ST	MIAMI, FL 33135	MIDWAY PB 3-177 LOT 25 LOT SIZE 40.000 X 145 OR 16771-0418 0395 3
3050320340010	18240 S DIXIE HWY	CLINTON & EISENHOWER LLC	19370 COLLINS AVE CU1	SUNNY ISLES BEACH, FL 33160	1.565 AC M/L TENDRICH TRACT PB 99-40 TRACT A LOT SIZE IRREGULAR OR 11638- 78 1182 5
3050320420010	18190 S DIXIE HWY	S J M PERRINE LLC	7425 BROOKSTONE CIRCLE	FLOWERY BRANCH, GA 30542	BLUMENFELD SUB PB 106-81 TRACT A LESS SLY 33.52 FT LOT SIZE 50.000 X 160 OR 15484-2885 0492 5 COC 23851-0485 04 2005 4
3050320420020		JAMES H MULHOLLAND	18210 S DIXIE HWY	MIAMI, FL 33157-5525	BLUMENFELD PB 106-81 SLY 33.52 OF TRACT A LOT SIZE 33.520 X 160 OR 12911- 2206 0486 2



3050320610010	18055 HOMESTEAD AVE	MIAMI-DADE COUNTYOCED	701 NW 1 CT 14TH FLOOR	MIAMI, FL 33136	ANDREW PERRINE SUB PB 157-49 T-19769 TRACT A LOT SIZE 4.08 AC M/L FAU 30-5032-011-0010 THRU 0590
3050320610020	18255 HOMESTEAD AVE	MIAMI-DADE COUNTYOCED	701 NW 1 CT 14TH FLOOR	MIAMI, FL 33136	ANDREW PERRINE SUB PB 157-49 T-19769 TRACT B LOT SIZE 5.46 AC M/L FAU 30-5032-011-0010 THRU 0590
3050320770010	18210 S DIXIE HWY	ISABEL R MULHOLLAND TR & GARY V SMITH TR & SOUTH DADE	14621 SW 65 AVE	MIAMI, FL 33158-1821	BUSY BEE SOUTH PB 170-094 PORT OF TR A BEG MOST SELY COR OF TR A TH N 24 DEG E 135FT N 65 DEG W 235FT S 24 DEG W 135FT S 65 DEG E 235FT TO POB LOT SIZE 31725 SQ FT M/L FAU 30 5032 077 0010
3050320770020		ISABEL R MULHOLLAND TR & GARY V SMITH TR & SOUTH DADE	14621 SW 65 AVE	MIAMI, FL 33158	BUSY BEE SOUTH PB 170-094 PORT OF TR A BEG MOST SELY COR OF TR A TH N 65 DEG W 137.22FT N 24 DEG E 418.22FT S 65 DEG E 52.32FT S 24 DEG W 135FT S 65 DEG E 75FT S 24 DEG W 83.52FT S 65 DEG E 10FT S 24 DEG W 200FT FOR POB LOT SIZE 45110 SQ FT M/L FAU 30 503
3060050010070	18590 S DIXIE HWY	TALWAG INVESTMENTS LIMITED% WALGREEN CO MS # 1435	104 WILMOT RD	DEERFIELD, IL 60015	5'56'40"1.58'AC SUB OF PB 1-4 PORT OF LOT 4 DESC BEG 54.67FTNELY OF X OF C/L QUAIL ROOST DR & NWLY R/W/L ST RD #5 CONT NELY 240.4/1T N 69 DEG W 237.14FT SWLY ALG SELY R/W/L REC RR 353.68FT E236.78FT NELY AD 30.11FT TO POB FT TO POB LOT SIZE 61083 SQ FT 0
3060050010071	18494 S FEDERAL HWY	OAKLAND PARK ESTATES LLC	2900 W 84 ST	MIAMI, FL 33018	5'56'40"1.713'AC M/L SUB OF PB 1-4 PORT OF LOT 4 DESC BEG 295.24FTNELY OF X R/W/L SR 5 & C/L QUAIL ROOST DR ALG NWLY/L OF SR 5 CONT NELY 130FT W237.14FT SWLY 130FT E237.14FT TO POB LOT SIZE 30829 SQ FT OR 21229 0388 042003 1
3060050010090		MIAMI DADE COUNTYMIAMI DADE TRANSIT DEPT	701 NW 1 CT STE 1700	MIAMI, FL 33136	5'56'40.832'AC SUB OF PB 1-4 BEG NW COR OF NE 1/4 OF SEC TH N 87 DEG E 201.31FT SWLY AD 137.97FT S 30 DEG W 200FT SWLY AD 69.38FT N 00 DEG W 347.84FT TO POB & BEG 339.47FTS OF NE COR OF NW 1/4 OF SEC CONT S 00 DEG E 8.37FT SWLY AD 83.12FT N 22 DEG E 90.73F
3060050010100	18400 S DIXIE HWY	JEANNE BARBER GODWIN TRS	3109 GRANDE AVE #345	MIAMI, FL 33133	5'56'40'1.217'AC SUB OF PB 1-4 BEG AT X OF N/L SEC 5 & WLY R/W/L OF US #1 TH SWLY 83.09FT FOR POB CONT SWLY ALG SD WLY R/W/L OF US #1 233.92FT TH N 68 DEG 28 MIN 35 SEC W FOR 237.51FT TO ELY R/W/L OF REC RR TH NELY ALG SD R/W/L 177.02FT TH E ALG A LINE 40
3060050010130	18430 S DIXIE HWY	FRIEDMAN-MARCUS GARNET PTNR	18430 S DIXIE HWY	MIAMI, FL 33157-6816	5'56'40'1.29'AC SUB OF PB 1-4 FROM AN IRON PIPE 25' N OF C/L OF PETERS ROAD & W/L OF FEDERAL HWY R/W NELY 395.2FT TO POB NELY 236.42FT NWLY AT ANGLE OF 86 DEG 44 MIN W237.5 SWLY ALG R/W/L OF REC RAILROAD 239.93FT SELY 237.9' TO POB BEING PART OF LOT 4
3060050010140		MIAMI DADE COUNTYPUBLIC HOUSING & COMMUNITY	701 NW 1ST CT 16TH FLOOR	MIAMI, FL 33136	5'56'40'2.88'AC SUB OF PB 1-4 LOT 5 LYING WLY OF HOMESTEAD AVE N OF INGRAHAM HWAY EXCEPTING N300FT LESS BEG SW COR OF LOT 5 TH N35FT E126.44FT NELY A/D 29.02FT N 22 DEG E 71.30FT SELY A/D 50FT SW106.221FT W133.27FT TO POB FOR R/W COC 23452-1833 06/05 234
3060050010150	18422 HOMESTEAD AVE	EUREKA 184 LLC	18271 SW 109 AVE	MIAMI, FL 33157-5045	5'56'40'.84'AC SUB OF PB 1-4 S50FT OF N250FT & S50FT OF N200FT LESS W100FT LOT 5 W OF HOMESTEAD AVE OR 19579-4701-08 032001 4 (27)
3060050010170	10216 EUREKA DR	EUREKA 184 LLC	1450 MADRUGA AVE 209	CORAL GABLES, FL 33146	5'56'40'.030'AC SUB OF PB 1-4 E129FT AS MEASURED ALG N/L OF N50FT OF LOT 5 LYG W OF HMSTD AVE LESS N35FT FOR R/W LOT SIZE IRREGULAR OR 9395 531
3060050010180		EUREKA 184 LLC	1450 MADRUGA AVE 209	CORAL GABLES, FL 33146	5'56'40'.028'AC SUB OF PB 1-4 BEG 129FTW OF X OF W R/W/L HMSTD AVE EXT & N/L LOT 5 S50FT W100FT N50FT E100FT TO POB LESS BEG 170FT M/L W OF X OF W R/W/L HMSTD AVE EXT & N/L LOT 5 S50FT W100FT N50FT E10FT TO POB LESS N35.01FT FOR R/W OR 18048-3063 0498 3
3060050010250	18412 HOMESTEAD AVE	EUREKA 184 LLC	1450 MADRUGA AVE 209	CORAL GABLES, FL 33146	5'56'40'.47'AC SUB OF PB 1-4 S50FT OF N150FT LOT 5 LESS E100FT OF W250FT W OF CO RD OR 16053-2308 0993 1
3060050010260	18408 HOMESTEAD AVE	GEORGIA BELLE THOMPSON (EST OF)	18408 HOMESTEAD AVE	MIAMI, FL 33157-6820	5'56'40'.167'AC M/L SUB OF PB 1-4 E150FT OF S50FT OF N100FT OF LOT 5 LYG W OF HMSTD AVE LESS BEG 55.03FTS OF N/L LOT 5 & W/L OF HMSTD AVE W9.24FT SELY ALG A/D 21.10FT TO A PT ON W/L OF HMSTD AVE NELY 22.5FT TO POB
3060050010270	10208 EUREKA DR	EUREKA 184 LLC	1450 MADRUGA AVE 209	CORAL GABLES, FL 33146	5'56'40'.112'AC SUB OF PB 1-4 E100FT OF W323FT OF S50FT OF N100FT OF LOT 5 & 10FT X 15FT STRIP DESC BEG 170FT M/L W OF X OF W RWL HMSTD AVE EXT & 35FT S OF N/L LOT 5 S15FT W100FT N15FT E10FT TO POB OR 16094-2468 1093 1
3060050010290	10235 SW 186 ST	MIAMI DADE COUNTYPUBLIC HOUSING & COMMUNITY	701 NW 1 CT 16TH FLOOR	MIAMI, FL 33136	5'56'40'.202'AC M/L SUB OF PB 1-4 PART AKA PT OF LOT 5 LYG BETW REC R/R & HOMESTEAD AVE EXT OF ING HWY LESS N542.87FT AS MEAS ALG W/L OF PROPERTY LOT SIZE 87692 SQ FT OR 17798-4158 0997 3 COC 26487-2339 07 2008 4
3060050010291	18411 HOMESTEAD AVE	MIAMI DADE COUNTYMIAMI DADE TRANSIT DEPT	701 NW 1 CT STE 1700	MIAMI, FL 33136	5'56'40'.234'AC M/L SUB OF PB 1-4 BEG 35FT S OF NE COR LOT 5 TH S303.78FT SWLY ALG NWLY R/W REC 285.10FT N 65 DEG W249.98FT NELY 488.33FT N 55 DEG E26.96FT E127.95FT TO POB LESS SWLY 76.60FT OF LOT 5 LOT SIZE 102081 SQ FT OR 18575-1003 1197 6 COC 23452-18
3060050010292		MIAMI DADE COUNTYPUBLIC HOUSING AND COMMUNITY	701 NW 1ST CT 16 FLOOR	MIAMI, FL 33136	5'56'40'.44'AC M/L SUB OF PB 1-4 BEG 35FT S OF NE COR LOT 5 TH S303.78FT SWLY ALG NWLY R/W REC 208.50 FOR POB TH SWLY 76.60FT N 65 DEG W 249.98FT NELY 76.60FT N 89 DEG E 249.98FT TO POB LOT SIZE 19148 SQ FT FAU 30 6005 001 0291
3060050010320	18440 HOMESTEAD AVE	EUREKA 184 LLC	1450 MADRUGA AVE 209	CORAL GABLES, FL 33146	5'56'40'.35'AC SUB OF PB 1-4 S50FT OF N300FT OF LOT 5 LESS W100FT OR 19579-4701-08 032001 4 (27)
3060050010451		MIAMI DADE COUNTYMIAMI-DADE TRANSIT	701 NW 1 CT STE 1700	MIAMI, FL 33136-3902	5'56'40'10.24'AC SUB OF PB 1-4 100FT REC R/W ACROSS SEC FORMERLY REC RR/COMPTROLLER/ DOT OR 13936-2071 0688 3 OR 20110-0538 1201 3
3060050180010	10200 SW 186 ST	FRENCHTEX INC	15715 S Dixie Hwy Ste 414	Miami, FL 33157-1884	5'56'40'5.79'AC M/L POINT WEST PB 96-25 TR A LESS BEG SE COR TH N 67 DEG W450.44FT TO SW COR TH N217.60FT S 67 DEG E536.07FT TH S 22 DEG W200FT TO POB LOT SIZE 25200/ SQ FT OR 19016-2849 0300 1

3060050760010	10160 SW 184 ST	QUASAR COMMUNICATIONS INC	9771 WAYNE AVE	PERRINE, FL 33157-5540	QUASAR TRACT PB 141-63 T-17798 TR A LOT SIZE .93 AC M/L F/A/U 30-6005-001-0093 OR 15546-0132 1291 5
3060050820010	10195 SW 186 ST	HAROLD E RILEY & W ROCIO	11745 SW 102 AVE	MIAMI, FL 33176-4128	BAILEY PARK PB 147-71 T-18317 TRACT A LOT SIZE 35271 SQ FT M/L F/A/U 30-6005-001-0092 OR 16989-2818 1195 1
3350320070250	18131 SW 98 AVENUE RD	ALPHONSE F MASSO & JOCELYN R KELLOW (TRUSTEES)	15501 SW 88 AVE	MIAMI, FL 33157-2017	MORNINGSIDE ACRES PB 46-7 LOT 1 BLK 3 LOT SIZE 120.000 X 128 OR 17306-3857 0796 4 F/A/U 30-5032-007-0250
3350320070270	9785 SW 181 TER	MORNINGSIDE APARTMENTS LLC	1401 BAY RD #310	MIAMI BEACH, FL 33139	32' 55' 40" MORNINGSIDE ACRES PB 46-7 LOTS 2 & 3 BLK 3 LOT SIZE 26084 SQ FT OR 19648-0060 03 2001 5 F/A/U 30-5032-007-0270 COC 24497-0821 04 2006 4
3350320070280	9740 WAYNE AVE	ANGELA H RUSSELL	18433 SW 87 PL	MIAMI, FL 33157-7268	MORNINGSIDE ACRES PB 46-7 LOT 4 BLK 3 LOT SIZE 15200 SQUARE FEET OR 19784-2355 0701 4 F/A/U 30-5032-007-0280
3350320070310	9799 SW 182 ST	9799 SW 182 STREET LLC	9500 THANKSGIVING DR	CUTLER BAY, FL 33157	32' 55' 40" MORNINGSIDE ACRES PB 46-7 LOT 1 & S1/2 OF LOT 14 BLK 4 LOT SIZE 100.000 X 125 OR 19144-4136 032000 1 F/A/U 30-5032-007-0310
3350320070320	9755 SW 182 ST	CHARLES PRISTON NESS	9755 SW 182 ST	PERRINE, FL 33157-5515	MORNINGSIDE ACRES PB 46-7 LOT 2 BLK 4 LOT SIZE 96.800 X 125 OR 13008-2889 0886 1 F/A/U 30-5032-007-0320
3350320070330	9745 SW 182 ST	9745SW182ST LLC	13800 SW 82 AVE	PALMETTO BAY, FL 33158	32' 55' 40" MORNINGSIDE ACRES PB 46-7 LOT 3 BLK 4 LOT SIZE 96.810 X 125 F/A/U 30-5032-007-0330 COC 25674-0964 05 2007 4
3350320070340	9735 SW 182 ST	CHARLES NESS	27340 S DIXIE HWY	HOMESTEAD, FL 33032	MORNINGSIDE ACRES PB 46-7 LOT 4 BLK 4 LOT SIZE 96.810 X 125 F/A/U 30-5032-007-0340 COC 23093-0136 02 2005 5
3350320070350	9725 SW 182 ST	MEHDI AJABSHIR	9725 SW 182 ST	MIAMI, FL 33157-5515	MORNINGSIDE ACRES PB 46-7 LOT 5 BLK 4 LOT SIZE 96.810 X 125 OR 16201-1630 1193 1 F/A/U 30-5032-007-0350 COC 21938-4381 12 2003 1
3350320070360	18140 SW 97 AVE	18140 LLC	18140 SW 97 AVE	MIAMI, FL 33137	MORNINGSIDE ACRES PB 46-7 LOT 6 & S1/2 OF LOT 7 BLK 4 LOT SIZE 100.000 X 125 F/A/U 30-5032-007-0360 OR 21077-1902 0103 6
3350320070370	18100 SW 97 AVE	GUERRERO INVESTMENT GROUP LLC	13727 SW 152 ST #233	MIAMI, FL 33177	32' 55' 40" MORNINGSIDE ACRES PB 46-7 LOT 8 & N1/2 OF LOT 7 BLK 4 LOT SIZE 100.000 X 125 OR 16737-2316 0395 5 F/A/U 30-5032-007-0370
3350320070380	9720 SW 181 TER	LAURA KETTLE	9720 SW 181 TERR	MIAMI, FL 33157-5513	32' 55' 40" MORNINGSIDE ACRES PB 46-7 LOT 9 BLK 4 LOT SIZE 96.070 X 125 OR 20661-4434 092002 1 F/A/U 30-5032-007-0380
3350320070390	9740 SW 181 TER	CHARLES P NESS & SCOTT NESS	27340 S DIXIE HWY	NARANJA, FL 33032-8211	32' 55' 40" MORNINGSIDE ACRES PB 46-7 LOT 10 & E1/5 FT LOT 11 BLK 4 LOT SIZE 111.240 X 125 OR 17050-0972 1295 1 F/A/U 30-5032-007-0390 COC 25747-2431 05 2007 4
3350320070400	9750 SW 181 TER	CHARLES P NESS	7500 SW 173 ST	PALMETTO BAY, FL 33157	32' 55' 40" MORNINGSIDE ACRES PB 46-7 LOT 11 LESS E15 FT & E15 FT LOT 12 BLK 4 LOT SIZE 96.070 X 125 OR 19907-0622 092001 1 F/A/U 30-5032-007-0400
3350320070410	9760 SW 181 TER	NADINE GILLES	PO BOX 925030	HOMESTEAD, FL 33092	32' 55' 40" MORNINGSIDE ACRES PB 46-7 LOT 12 LESS E15 FT & E15 FT LOT 13 & E15 FT OF N1/2 LOT 14 BLK 4 OR 12481-333 0485 1 LOT SIZE 96.080 X 125 OR 20249-3210 022002 6 F/A/U 30-5032-007-0410 OR 23014-0420 102004 6 COC 25403-2805/26155-1006 0207 5
3350320070420	9780 SW 181 TER	9780 SW 181 TERRACE LLC	9500 THANKSGIVING DR	CUTLER BAY, FL 33157	32' 55' 40" MORNINGSIDE ACRES PB 46-7 LOT 13 LESS E15 FT & N1/2 OF LOT 14 LESS E15 FT BLK 4 LOT SIZE 85.000 X 125 OR 17141-3304 0396 1 F/A/U 30-5032-007-0420
3350320070430	18245 SW 98 AVE	CARLOS ROSELL	18245 SW 98 AVE	MIAMI, FL 33157-5505	32' 55' 40" MORNINGSIDE ACRES PB 46-7 LOT 1 & W22 FT LOT 2 LESS N41.7 FT BLK 5 LOT SIZE 83.300 X 122 OR 19107-1215 052000 1 F/A/U 30-5032-007-0430 COC 21857-1275 11 2003 1
3350320070440	9759 SW 183 ST	CHARLES P NESS	7500 SW 173 STREET	PALMETTO BAY, FL 33157	MORNINGSIDE ACRES PB 46-7 LOT 2 LESS W22 FT & W11 FT LOT 3 BLK 5 LOT SIZE 85.800 X 125 OR 18841-1371 1099 1 F/A/U 30-5032-007-0440 COC 21994-0078 01 2004 1
3350320070450	18225 SW 98 AVE	STEPHEN A KREISHER	18201 SW 98 AVE	PALMETTO BAY, FL 33157-5505	32' 55' 40" MORNINGSIDE ACRES PB 46-7 W22 FT OF N41.7 FT LOT 2 & W22 FT OF S41.7 FT LOT 12 & ALL LOT 14 BLK 5 LOT SIZE 83.400 X 122 OR 20654-3936 082002 4 F/A/U 30-5032-007-0450
3350320070460	9747 SW 183 ST	DHANA MOORE & W CLAIRE MOORE & CYRIL MOORE JTRS	9747 SW 183 ST	MIAMI, FL 33157-5517	32' 55' 40" MORNINGSIDE ACRES PB 46-7 LOT 3 LESS W11 FT BLK 5 LOT SIZE 85.810 X 125 OR 16456-3595 0794 1 F/A/U 30-5032-007-0460 COC 26027-2609 10 2007 5
3350320070470	9731 SW 183 ST	MARIA J LLERENA MOLINA	9731 SW 183 ST	MIAMI, FL 33157-5517	32' 55' 40" MORNINGSIDE ACRES PB 46-7 LOT 4 BLK 5 LOT SIZE 10726 SQ FT FAU 30-5032 007 0470 OR 25749 3093 94 05 2007 01
3350320070480	9725 SW 183 ST	ELLIOTT LEE NESS & CHARLES P NESS	27340 S DIXIE HWY	NARANJA, FL 33032-8211	MORNINGSIDE ACRES PB 46-7 E11 FT LOT 4 & LOT 5 LESS E22 FT BLK 5 LOT SIZE 85.810 X 125 OR 16335-2038 0394 1 F/A/U 30-5032-007-0480
3350320070490	18240 SW 97 AVE	CHARLES P NESS ELLIOTT L NESS	7500 SW 173 ST	PALMETTO BAY, FL 33157	MORNINGSIDE ACRES PB 46-7 LOT 6 & S83 FT OF E22 FT OF LOT 5 BLK 5 LOT SIZE 83.300 X 122 F/A/U 30-5032-007 0490 OR 21115-1459 022003 1 COC 23586-0309 07 2005 1
3350320070500	18220 SW 97 AVE	JAMES V & ANGELICA ATKINSON (TRS)	14350 SW 232 ST	MIAMI, FL 33170-7107	MORNINGSIDE ACRES PB 46-7 LOT 7 & N41.7 FT OF E22 FT LOT 5 & S41.7 FT OF E22 FT LOT 9 BLK 5 LOT SIZE 83.400 X 122 OR 19894-4071 0801 5 F/A/U 30-5032-007-0500
3350320070510	18200 SW 97 AVE	JUAN P DUARTE & WCLAUDIA P ARROYAVE OBRIEN	8350 SW 184 ST	MIAMI, FL 33157-7317	MORNINGSIDE ACRES PB 46-7 LOT 8 & N83 FT OF E22 FT OF LOT 9 BLK 5 LOT SIZE 83.300 X 125 OR 18166-4591 0698 1 F/A/U 30-5032-007-0510 COC 24345-3268 03 2006 1
3350320070520	9720 SW 182 ST	CHARLES P NESS DONNA GLAZEBROOK NESS	7500 SW 173 ST	MIAMI, FL 33157	MORNINGSIDE ACRES PB 46-7 LOT 9 LESS E22 FT & E11 FT LOT 10 BLK 5 LOT SIZE 85.470 X 125 OR 14511-1800 0490 1 F/A/U 30-5032-007-0520
3350320070530	9730 SW 182 ST	MARIA J LLERENA MOLINA	9731 SW 183 ST	MIAMI, FL 33157-5517	MORNINGSIDE ACRES PB 46-7 LOT 10 LESS E11 FT BLK 5 LOT SIZE 85.630 X 125 F/A/U 30-5032-007-0530 OR 20765-2989 102002 4 COC 24173-3349 08 2005 5 FAU 33 5032 007 0470
3350320070540	9748 SW 182 ST	JEFFERY C OUSLEY	9748 SW 182 ST	PERRINE, FL 33157-5516	32' 55' 40" MORNINGSIDE ACRES PB 46-7 LOT 11 LESS W11 FT BLK 5 LOT SIZE 85.630 X 125 OR 10547-2150 1079 6 F/A/U 30-5032-007-0540
3350320070550	9760 SW 182 ST	JEFFREY C OUSLEY	9760 SW 182 ST	MIAMI, FL 33157-5516	MORNINGSIDE ACRES PB 46-7 W11 FT LOT 11 & LOT 12 LESS W22 FT BLK 5 LOT SIZE 85.470 X 125 OR 15761-5419 1292 1 F/A/U 30-5032-007-0550



3350320070560	18201 SW 98 AVE	STEPHEN A KREISHER	18201 SW 98 AVE	PALMETTO BAY, FL 33157-5505	MORNINGSIDE ACRES PB 46-7 W22FT LOT 12 LESS 541.7FT & ALL LOT 13 BLK 5 LOT SIZE 83.300 X 122 OR 11036-1579 0381 1 F/A/U 30-5032-007-0560
3350320070570	9765 SW 184 ST	JULES G MINKES & W LINDA	9765 SW 184 ST	MIAMI, FL 33157-6932	MORNINGSIDE ACRES PB 46-7 LOT 1 & LOT 2 LESS N41.7FT OF W22FT & W11FT LOT 3 BLK 6 LOT SIZE 21657 SQ FT OR 20734 4519 0902 4 (2) F/A/U 30-5032-007-0570
3350320070590	9745 SW 184 ST	EUREKA DRIVE HOLDINGS INC	14150 SW 119 AVE	MIAMI, FL 33186-6012	32' 55" 40" MORNINGSIDE ACRES PB 46-7 LOT 3 LESS W11FT & LOT 4 LESS E11FT & LOT 10 LESS E11FT & LOT 11 LESS W11FT BLK 6 LOT SIZE 43017 SQ FT M/L FAU 30 5032 007 0590
3350320070610	9725 SW 184 ST	CLAIRE MESSAM WEBB	11900 SW 199 ST	MIAMI, FL 33177-4308	32' 55" 40" MORNINGSIDE ACRES PB 46-7 LOT 4 & LOT 5 LESS E22FT BLK 6 LOT SIZE 86.100 X 125 OR 17622-4905 0497 1 F/A/U 30-5032-007-0610
3350320070620	18330 SW 97 AVE	EDWARD P MACDOUGALL & W BARBARA	7955 SW 201 TERR	MIAMI, FL 33189-2117	MORNINGSIDE ACRES PB 46-7 LOT 6 & E 22 FT LOT 5 BLK 6 LOT SIZE 83.300 X 122 F/A/U 30-5032-007-0620 OR 20773-3572 1002 1
3350320070630	18320 SW 97 AVE	EDWARD P MACDOUGALL	18320 SW 97 AVE	MIAMI, FL 33157-5503	MORNINGSIDE ACRES PB 46-7 E22FT OF N41.7FT LOT 5 & ALL LOT 7 & E22FT OF S41.7FT LOT 9 BLK 6 LOT SIZE 83.400 X 122 OR 18048-3905 0398 1 F/A/U 30-5032-007-0630
3350320070640	18301 SW 98 AVE	GUSTAVO A MEJIDO SR	18301 SW 98 AVE	PALMETTO BAY, FL 33157-5507	32' 55" 40" MORNINGSIDE ACRES PB 46-7 W22FT LOT 12 LESS 541.7FT & ALL LOT 13 BLK 6 LOT SIZE 83.300 X 122 OR 19695-0337 062001 4 F/A/U 30-5032-007-0640 COC 23193-2725 03 2005 1
3350320070650	9700 SW 183 ST	MASTERS HOMES LLC	4342 SW 145 AVE	MIAMI, FL 33175	MORNINGSIDE ACRES PB 46-7 LOT 8 & E22FT LOT 9 LESS 541.7FT BLK 6 LOT SIZE 83.300 X 122 F/A/U 30-5032-007-0650 OR 20797-3725 112002 1 COC 24030-2431 11 2005 1
3350320070660	9720 SW 183 ST	MASTERS HOMES LLC	4342 SW 145 AVE	MIAMI, FL 33175	MORNINGSIDE ACRES PB 46-7 LOT 9 LESS E22FT & E11FT LOT 10 BLK 6 LOT SIZE 86.030 X 125 OR 18883-1557 1199 1 F/A/U 30-5032-007-0660 COC 25731-1480 05 2007 1
3350320070690	9740 SW 183 ST	JULES G MINKES LINDA MINKES	11760 SW 72 PL	PINECREST, FL 33156	MORNINGSIDE ACRES PB 46-7 W11FT LOT 11 & LOT 12 LESS W22FT BLK 6 LOT SIZE 85.870 X 125 OR 19982-3496 102001 1 F/A/U 30-5032-007-0690 COC 23180-3799 03 2005 1
3350320070700		JULES G MINKES & W LINDA	9765 SW 184 ST	MIAMI, FL 33157-6932	MORNINGSIDE ACRES PB 46-7 W22FT OF N41.7FT LOT 2 & W22FT OF S41.7FT LOT 12 & ALL LOT 14 BLK 6 LOT SIZE 83.400 X 122 OR 20734-4519 0902 4 (2) F/A/U 30-5032-007-0700
3350320070710	9845 SW 183 ST	HERNAN LOPEZ	PO BOX 83-5481	MIAMI, FL 33255-5481	MORNINGSIDE ACRES PB 46-7 LOT 1 LESS S22.5FT BLK 7 LOT SIZE 87.500 X 120 F/A/U 30-5032-007-0710 OR 20738-0412 102002 1
3350320070720	9835 SW 183 ST	HAIHE LLC	7951 SW 35 TER	MIAMI, FL 33155	32' 55" 40" MORNINGSIDE ACRES PB 46-7 S22.5FT LOT 1 & W85FT LOT 2 BLK 7 LOT SIZE 87.500 X 120 F/A/U 30-5032-007-0720 COC 23075-0738 02 2005 5
3350320070730	9825 SW 183 ST	RICHARD MARTINEZ JUDICE ESCALONA	9825 SW 183 ST	PALMETTO BAY, FL 33157	MORNINGSIDE ACRES PB 46-7 S25FT LOT 2 & S18.75FT LOT 10 LESS E150FT & LOT 12 LESS E50FT BLK 7 LOT SIZE 10505 SQ FT M/L F/A/U 30-5032-007-0730
3350320070740	18201 SW 98 AVENUE RD	HAIHE LLC	7951 SW 35 TER	MIAMI, FL 33155	MORNINGSIDE ACRES PB 46-7 LOT 3 BLK 7 LOT SIZE 91.000 X 180 OR 20515-0239 052002 1 F/A/U 30-5032-007-0740
3350320070750	18185 SW 98 AVENUE RD	VICTOR M DE JESUS JR	27840 SW 160 AVE	HOMESTEAD, FL 33031	MORNINGSIDE ACRES PB 46-7 LOT 4 BLK 7 LOT SIZE 91.060 X 151 OR 13906-2362 1188 5 F/A/U 30-5032-007-0750
3350320070760	18175 SW 98 AVENUE RD	CHARLES P NESS	7500 SW 173 ST	MIAMI, FL 33175	MORNINGSIDE ACRES PB 46-7 LOT 5 BLK 7 LOT SIZE 91.000 X 131 OR 14934-127 0291 1 F/A/U 30-5032-007-0760
3350320070770	9820 SW 181 TER	CHARLES P NESS	7500 SW 173 ST	MIAMI, FL 33175	MORNINGSIDE ACRES PB 46-7 LOT 6 BLK 7 LOT SIZE 109.000 X 123 OR 12261-727 0884 4 F/A/U 30-5032-007-0770
3350320070780	9800 SW 181 TER	CHARLES P NESS	7500 SW 173 ST	PALMETTO BAY, FL 33157	32' 55" 40" MORNINGSIDE ACRES PB 46-7 LOT 7 LESS S18.75FT BLK 7 LOT SIZE 114.000 X 113 OR 15512-1604 0492 1 F/A/U 30-5032-007-0780
3350320070790	18170 SW 98 AVE	JORGE A QUINTANILLA & W ANA	18170 SW 98 AVE	MIAMI, FL 33157-5504	32' 55" 40" MORNINGSIDE ACRES PB 46-7 S18.75FT LOT 7 & N56.25FT LOT 8 BLK 7 LOT SIZE 75.000 X 141 OR 16869-1802 0795 1 F/A/U 30-5032-007-0790 COC 22959-0381 12 2004 4
3350320070800	18180 SW 98 AVE	CAPITAL HOMES LENDING LLC	18180 SW 98 AVE	MIAMI, FL 33157	32' 53" 40" MORNINGSIDE ACRES PB 46-7 S48.75FT LOT 8 & N26.25FT LOT 9 BLK 7 LOT SIZE 75.000 X 150 F/A/U 30-5032-007-0800 COC 26220-2590 02 2008 5
3350320070810	18200 SW 98 AVE	SCOTT NESS & CHARLES NESS & ELLIOT NESS	18200 SW 98 AVE	MIAMI, FL 33165	MORNINGSIDE ACRES PB 46-7 S73.75FT LOT 9 & N1.25FT LOT 10 BLK 7 LOT SIZE 75.000 X 166 F/A/U 30-5032-007-0810 COC 23974-3280 10 2005 5
3350320070820	18220 SW 98 AVE	REMBERTO FERIA	18220 SW 98 AVE	MIAMI, FL 33157-5506	MORNINGSIDE ACRES PB 46-7 LOT 10 LESS S18.75FT & LESS N1.25FT BLK 7 LOT SIZE 75.000 X 188 OR 20575-2195/26525-1580 072002 1 F/A/U 30-5032-007-0820
3350320070830	9801 SW 183 ST	LINDA D SNOWDENTHOMAS JAMES SNOWDEN JR	12460 SW 147 TER	MIAMI, FL 33186	MORNINGSIDE ACRES PB 46-7 E75FT OF S18.75FT LOT 10 & LOT 11 LESS W25FT BLK 7 LOT SIZE 75.000 X 139 F/A/U 30-5032-007-0830
3350320070840	9815 SW 183 ST	SERGIO E AMADOR & W NUBIA SALGADO	9815 SW 183 ST	MIAMI, FL 33157-5519	32' 55" 40" MORNINGSIDE ACRES PB 46-7 W75FT OF E150FT OF S18.75FT LOT 10 & W25FT LOT 11 & E50FT LOT 12 BLK 7 LOT SIZE 75.000 X 139 OR 19112-4656 052000 1 F/A/U 30-5032-007-0840
3350320070850	9875 SW 183 ST	ERROL D JAMES & W OLIVE V	19348 SW 79 PL	CUTLER BAY, FL 33157	MORNINGSIDE ACRES PB 46-7 LOT 1 BLK 8 LOT SIZE 126.410 X 100 OR 15737-5136 1292 1 F/A/U 30-5032-007-0850
3350320070860	18161 SW 98 CT	ANTHONY VAN SMITH & W DIANE	18161 SW 98 CT	MIAMI, FL 33157-5509	32' 55" 40" MORNINGSIDE ACRES PB 46-7 LOT 2 BLK 8 LOT SIZE 100.000 X 100 OR 13035-1988 0886 1 F/A/U 30-5032-007-0860
3350320070870	18151 SW 98 CT	SW 98TH CT HOLDING LLC/O LRET HOLDING LLC	169 E FLAGLER ST #PH	MIAMI, FL 33131	32' 55" 40" MORNINGSIDE ACRES PB 46-7 LOT 3 BLK 8 LOT SIZE 100.000 X 100 OR 15010-2248 0491 6 F/A/U 30-5032-007-0870 COC 21376-1164 05 2003 1
3350320070880	18131 SW 98 CT	BARRY T MITZNER & W SHELLEY	9721 SW 148 ST	MIAMI, FL 33176-7838	32' 55" 40" MORNINGSIDE ACRES PB 46-7 LOT 4 BLK 8 LOT SIZE 100.000 X 100 OR 12755-729 1285 1 F/A/U 30-5032-007-0880
3350320070890	18101 SW 98 CT	MADJAM LLC	13900 SW 86 CT	PALMETTO BAY, FL 33158	MORNINGSIDE ACRES PB 46-7 LOTS 5 & 6 BLK 8 LOT SIZE 225.000 X 100 OR 15727 1663 1192 4 F/A/U 30-5032-007-0890
3350320070910	9810 WAYNE AVE	DP REAL ESTATE HOLDINGS LLC	2700 SW 8 STREET	MIAMI, FL 33135	MORNINGSIDE ACRES PB 46-7 LOT 7 BLK 8 LOT SIZE 125.000 X 100 OR 20204-2180 0202 4 F/A/U 30-5032-007-0910

3350320070920	18120 HOLCOMB AVE	CHARLES P NESSSCOTT F NESS	7500 SW 173 ST	MIAMI, FL 33157-4839	32 55 40 MORNINGSIDE ACRES PB 46-7 LOT 8 BLK 8 LOT SIZE 100.000 X 100 OR 14554-3872 0590 1 F/A/U 30-5032-007-0920 COC 22991-2152 11 2004 4
3350320070930	18130 HOLCOMB AVE	ELIZABETH M LOPEZ	7951 SW 35 TERRACE	MIAMI, FL 33155	MORNINGSIDE ACRES PB 46-7 LOT 9 BLK 8 LOT SIZE 100.000 X 100 75R 269340 F/A/U 30-5032-007-0930 COC 21998-2475 01 2004 5
3350320070940	18150 HOLCOMB AVE	VICTOR M DE JESUS SR	18150 SW 98 AVE RD	MIAMI, FL 33157	MORNINGSIDE ACRES PB 46-7 LOT 10 BLK 8 LOT SIZE 100.000 X 100 OR 18014-4731 0398 4 F/A/U 30-5032-007-0940
3350320070950	18200 HOLCOMB AVE	ANTHONY VAN SMITH & W DIANE	16061 SW 86 AVE	MIAMI, FL 33157-3622	MORNINGSIDE ACRES PB 46-7 LOT 11 BLK 8 LOT SIZE 100.000 X 100 OR 13319-3083 0687 1 F/A/U 30-5032-007-0950
3350320070960	9871 SW 183 ST	ERROL D JAMES & W OLIVE V	19348 SW 79 PL	CUTLER BAY, FL 33157	MORNINGSIDE ACRES PB 46-7 LOT 12 BLK 8 LOT SIZE 126.000 X 100 OR 15737-5137 1292 1 F/A/U 30-5032-007-0960
3350320071030	18301 S DIXIE HWY	183 PALMETTO HOLDINGS LLC	4949 SW 75 AVE	MIAMI, FL 33155	32 55 40 MORNINGSIDE ACRES PB 46-7 LOT 1 LESS R/W & LOTS 2 & 3 & PORT OF RD LYG NE & ADJ CLOSED BY RES 9519 & ALL OF LOTS 4 & 5 & NWLY 50.5FT OF LOT 6 BLK 10 & PT OF SE 1/4 OF SEC 32 55 40 DE SC BEG NE COR OF LOT 1 BLK 10 PB 46-7 TH NELY 145FT NWLY 200FT SWL
3350320071090	9840 MORNINGSIDE AVE	STEVEN MICHAEL SPAYD	9840 MORNINGSIDE AVE	MIAMI, FL 33157-5520	32 55 40 MORNINGSIDE ACRES PB 46-7 ELY 49.5FT LOT 6 & W 34FT LOT 7 BLK 10 LOT SIZE 83.500 X 120 OR 18805-3591 0899 1 F/A/U 30-5032-007-1090
3350320071100	9830 SW 183 ST	DERRICK SHIM	9830 SW 183 ST	PERRINE, FL 33157-5520	32 55 40 MORNINGSIDE ACRES PB 46-7 ELY 66FT LOT 7 & WLY 17.5FT LOT 8 BLK 10 LOT SIZE 83.500 X 120 OR 13960-2159 1288 4 F/A/U 30-5032-007-1100
3350320071110	9820 SW 183 ST	SOUTHERN 7645 LLC	7072 SW 10 ST	MIAMI, FL 33144	MORNINGSIDE ACRES PB 46-7 ELY 82.5FT LOT 8 & WLY 10FT LOT 9 BLK 10 LOT SIZE 83.500 X 120 OR 20095-1489 122001 1 F/A/U 30-5032-007-1110 COC 22922-4103 12 2004 5
3350320071120	9810 SW 183 ST	FRANK HERNANDEZ	8575 SW 115 CT	MIAMI, FL 33173	MORNINGSIDE ACRES PB 46-7 LOT 9 LESS WLY 10FT & LESS ELY 15.5FT BLK 10 LOT SIZE IRREGULAR F/A/U 30-5032-007-1120 OR 20951-3668 112002 1 COC 23503-4492 05 2005 4
3350320071121	18300 SW 98 AVE	SOUTH DADE DEVELOPMENT INC	9041 SW 57 TER	MIAMI, FL 33173	MORNINGSIDE ACRES PB 46-7 BEG AT NE COR LOT 10 BLK 10 TH WLY ALG NWLY LOTS 10 & 9 FOR 114.36FT TH SLY PARR TO E/L LOT 9 78.29FT TH ELY TO E/L LOT 10 TH NLY 140.27FT TO POB LOT SIZE 109.280 X 147 F/A/U 30-5032-007-1121 OR 20952-0263 112002 1 COC 23503-449
3350320071122	18320 SW 98 AVE	SOUTH DADE DEV INC	PO BOX 55-8515	MIAMI, FL 33255	32 55 40 MORNINGSIDE ACRES PB 46-7 BEG 140.27FT OF NE COR LOT 10 BLK 10 TH SE TO SE COR LOT 10 TH WLY ALG S/L LOTS 10 & 9 201.35FT TH NLY PARR TO E/L LOT 9 A DIST OF 75FT TH SLY TO POB LOT SIZE 13,739 SQ FT F/A/U 30-5032-007-1122 OR 20900-2284 1102 1
3350320310010	18295 S DIXIE HWY	MCDONALD'S CORP 009/0119% MCDONALD'S #01856	13349 SW 131 ST	MIAMI, FL 33186	R PIERCE CHATHAM SUB PB 91-42 TR A & LOT 1 & S18.29FT OF LOT 2 BLK 1 LOT SIZE IRREGULAR OR 12835-1095 0186 5 F/A/U 30-5032-031-0010
3350320310020	18099 S DIXIE HWY	JORGAR CORPDANATUR CORP	169 E FLAGLER STREET STE 300	MIAMI, FL 33131	R PIERCE CHATHAM SUB PB 91-42 N36.71FT LOT 2 & ALL LOTS 3 THRU 7 BLK 1 F/A/U 30-5032-031-0020 OR 13934-1490 12/88 1
3350320470010	18325 S DIXIE HWY	PNS STORES INC% PROPERTY TAX CONSULTANTS	300 PHILLIPI RD PO BOX 28512	COLUMBUS, OH 43228-0512	BARNETT LINDSLEY SUB PB 117-100 TR A LOT SIZE 131997 SQ FT OR 14454-1991 0290 5 (2) F/A/U 30-5032-047-0010
3350320470020	9821 SW 184 ST	EUREKA PLAZA LLC	9861 SW 184 ST	PALMETTO BAY, FL 33157 6934	BARNETT LINDSLEY SUB PB 117-100 TR B LESS BEG MOST NWLY COR OF TR B TH S 69 DEG E 100.40FT SLY 209.86FT S 20 DEG W 80.43FT N 69 DEG W 100FT N 20 DEG E 80.43FT NELY 209.84FT TO POB LOT SIZE 88398 SQ FT F/A/U 30-5032-047-0020 COC 26248-0564 02 2008 5
3350320470021		PNS STORES INC% BIG LOTS STORE INC	300 PHILLIPI RD DEPT 10051	COLUMBUS, OH 43228	BARNETT LINDSLEY SUB PB 117-100 PORT OF TR B DESC BEG MOST NWLY COR OF TR B TH S 69 DEG E 100.40FT SLY 209.86FT S 20 DEG W 80.43FT N 69 DEG W 100FT N 20 DEG E 80.43FT NELY 209.84FT TO POB LOT SIZE 29029 SQ FT OR 14454-1991 0290 5 (2) F/A/U 30-5032-047-0021
3350320470030	18341 S DIXIE HWY	BARNETT BANK OF HOMESTEAD CO NC1-001-03-81	101 N TRYON ST	CHARLOTTE, NC 28255	BARNETT LINDSLEY SUB PB 117-100 TR C LOT SIZE 64894 SQ FT F/A/U 30-5032-047-0030
3350320470040	9885 SW 184 ST	MIAMI-DADE COUNTY WATER AND SEWER	3071 SW 38 AVE	MIAMI, FL 33146-1520	BARNETT LINDSLEY SUB PB 117-100 TR D LOT SIZE 1684 SQ FT OR 11531-505 0882 3 F/A/U 30-5032-047-0040
3350330080110	9635 SW 182 ST	WAYNE R HEW & WJOY P HEW	11111 SW 170 TER	MIAMI, FL 33157	FRANJO PARK SEC 1 PB 65-25 LOT 6 BLK 2 LOT SIZE 95.000 X 119 OR 17295-0772 0796 1 F/A/U 30-5033-008-0110 COC 25534-0570 03 2007 1
3350330080190	9620 SW 182 ST	JAVIER DIAZ	20235 HIGHLAND LAKES BLVD	AVENTURA, FL 33179	FRANJO PARK SEC 1 PB 65-25 LOT 4 BLK 3 LOT SIZE 85.000 X 119 OR 16454-5372/25400 4319 0694 4 F/A/U 30-5033-008-0190 COC 25400-4322 01 2007 5
3350330080200	9630 SW 182 ST	BARBARA J GOLOB	9630 SW 182 ST	MIAMI, FL 33157-5633	FRANJO PARK SEC 1 PB 65-25 LOT 5 BLK 3 LOT SIZE 95.000 X 119 OR 15771-3578 1292 1 F/A/U 30-5033-008-0200
3350330080210	9635 SW 183 ST	LUIS E LEMA & W MARIA D & FRANCISCO A LEMA & W GLORIA I	9635 SW 183 ST	MIAMI, FL 33157-5634	FRANJO PARK SEC 1 PB 65-25 LOT 6 BLK 3 LOT SIZE 95.000 X 119 OR 18442-1279 0199 4 F/A/U 30-5033-008-0210
3350330080220	9625 SW 183 ST	ANDREW CIURO	9625 SW 183 ST	MIAMI, FL 33157-5634	FRANJO PARK SEC 1 PB 65-25 LOT 7 BLK 3 LOT SIZE 85.000 X 119 OR 16607-2281 1294 1 F/A/U 30-5033-008-0220
3350330080230	9601 SW 183 ST	ANA DELLA BELLO	9601 SW 183 ST	PALMETTO BAY, FL 33157	FRANJO PARK SEC 1 PB 65-25 LOT 8 BLK 3 LOT SIZE 85.000 X 119 73R-215725 F/A/U 30-5033-008-0230 COC 24266-0045 02 2006 1
3350330080270	9560 SW 183 ST	LUIS DE JESUS MENENDEZ TELVINA M MEANA	9560 SW 183 ST	PALMETTO BAY, FL 33157	FRANJO PARK SEC 1 PB 65-25 LOT 2 BLK 4 LOT SIZE 85.000 X 119 OR 17085-1377 0296 1 F/A/U 30-5033-008-0270 COC 24865-4266 08 2006 1
3350330080280	9600 SW 183 ST	RICHARD TORRES	9600 SW 183 ST	MIAMI, FL 33157-5635	FRANJO PARK SEC 1 PB 65-25 LOT 3 BLK 4 LOT SIZE 85.000 X 119 OR 16891-0721 0895 1 F/A/U 30-5033-008-0280
3350330080290	9620 SW 183 ST	THOMAS C WYSS TRS	13621 DEERING BAY DR APT 1004	CORAL GABLES, FL 33158	FRANJO PARK SEC 1 PB 65-25 LOT 4 BLK 4 LOT SIZE 85.000 X 119 OR 20313-1179 032002 1 F/A/U 30-5033-008-0290
3350330080300	9630 SW 183 ST	CARLOS COMAS & W MARGARITA B	9630 SW 183 ST	MIAMI, FL 33157-5635	33 55 40 FRANJO PARK SEC 1 PB 65-25 LOT 5 BLK 4 LOT SIZE 95.000 X 119 74R-79702 F/A/U 30-5033-008-0300



3350330080310	9635 SW 184 ST	JOE W LONGWITH &W MYRTICE	9635 SW 184 ST	MIAMI, FL 33157-7020	33 55 40 FRANJO PARK SEC 1 PB 65-25 LOT 6 BLK 4 LOT SIZE 95.000 X 119 F/A/U 30-5033-008-0310
3350330080320	9625 SW 184 ST	ROLANDO BOCOS	9625 SW 184 ST	MIAMI, FL 33157-7020	FRANJO PARK SEC 1 PB 65-25 LOT 7 BLK 4 LOT SIZE 85.000 X 119 OR 13852-2817 1088 1 F/A/U 30-5033-008-0320
3350330080330	9601 SW 184 ST	FARRELL M SIPPEL &W CAROL L	9601 SW 184 ST	PERRINE, FL 33157-7020	FRANJO PARK SEC 1 PB 65-25 LOT 8 BLK 4 LOT SIZE 85.000 X 119 F/A/U 30-5033-008-0330
3350330080340	9555 SW 184 ST	ROSIBEL MARTINEZ	9555 SW 184 ST	MIAMI, FL 33157-7018	33 55 40 FRANJO PARK SEC 1 PB 65-25 LOT 9 BLK 4 LOT SIZE 85.000 X 119 OR 16790-3838-39-40 0595 1 F/A/U 30-5033-008-0340
3660040000010	19760 SW 103 CT	SOUTH FLA WATER MANAGEMENT DISTATTN: REAL ESTATE MGNT SECTION	3301 GUN CLUB RD	WEST PALM BEACH, FL 33406	4 56 40 7.96 AC M/L 80FT R/W THRU W3/4 OF N1/2 OF SEC FOR C-100-B CANAL R/W LOT SIZE IRREGULAR F/A/U 30-6004-000-0010
3660040010030	9525 STERLING DR	EDW A MCCARTHY-ARCHBISHOP	9401 BISC BLVD	MIAMI, FL 33138-2970	4 56 40 19.75 AC SUB OF PB 1-11 LOT 8 & N290.95FT LOT 9 & THAT PT OF LOT 7 LYG W OF LINE WHICH IS 714.5FTE OF W/L OF SEC 4 & N 290.95FT OF LOT 10 LYG W OF LINE WHICH IS 714.5FTE OF W/L OF SEC 4 LESS W40FT & LESS N40FT OF LOT 8 FOR R/W & LESS EXT AREA OF
3660040150010	9615 SW 187 ST	OMAR SISTO	9615 SW 187 ST	MIAMI, FL 33157	BELAIRE SEC 7 PB 84-63 LOT 1 BLK 40 LOT SIZE 100.000 X 145 OR 10466-1428 0779 6 F/A/U 30-6004-015-0010
3660040210500	9638 STERLING DR	WILLIAM SCOTT	9638 STERLING DR	CUTLER BAY, FL 33157	BEL AIRE SEC 13 PB 86-91 LOT 1 BLK 52 LOT SIZE 85.000 X 168 COC 23370-0736 05 2005 1 F/A/U 30-6004-721-0500 COC 25162-2581/25342 4588 1206 4
3660040210510	9624 STERLING DR	MADELINE ILLA	9624 STERLING DR	CUTLER BAY, FL 33157	BEL AIRE SEC 13 PB 86-91 LOT 2 BLK 52 LOT SIZE 75.000 X 175 OR 12741-2190 1285 1 COC 23739-0005 08 2005 5 F/A/U 30-6004-021-0510
3660040210520	9618 STERLING DR	DEAN GORDONVANESSA PONS	9618 STERLING DR	MIAMI, FL 33157	BEL AIRE SEC 13 PB 86-91 LOT 3 BLK 52 LOT SIZE 75.000 X 185 OR 14182-1583 & 14135-419 0689 1 F/A/U 30-6004-021-0520
3660050000010		SOUTH FLA WATER MANAGEMENT DISTATTN: REAL ESTATE MGNT SECTION	3301 GUN CLUB RD	WEST PALM BEACH, FL 33406	5 56 40 32.31 AC M/L R/W FOR C-1-N CANAL LESS THAT PORT OF C-1-N CANAL R/W LYG WLY OF SEC F/A/U 30-6005-000-0010
3660050010010	18500 SW 97 AVE	TOWN OF CUTLER BAY	10720 CARIBBEAN BLVD	CUTLER BAY, FL 33189-1218	5 56 40 SUB OF PB 1-4 CENTER 342FT LOT 1 LOT SIZE 230432 SQ FT F/A/U 30-6005-001-0010 COC 25964-4432 09 2007 3
3660050010020	18454 SW 97 AVE	EDNA M THOMAS	1151 SANDUSKY STREET SE	PALM BAY, FL 32909	5 56 40 .09 AC M/L SUB OF PB 1-4 BEG 235FTS & 35FT W OF NE COR OF LOT 1 W150FT S25FT E150FT N25FT TO POB LOT SIZE 25.000 X 150 OR 12129-600 0384 1 F/A/U 30-6005-001-0020
3660050010021	9720 SW 184 ST	VILLAS OF CUTLER BAY LLC	320 MIRACLE MILE STE 201	CORAL GABLES, FL 33134	5 56 40 SUB OF PB 1-4 PORT OF LOT 1 DESCR BEG NE COR OF LOT 1 TH S342.69FT W336.77FT N329.31FT E336.90FT TO POB LESS E185.01FT & LESS N40FT FOR R/W LOT SIZE 43674 SQ FT OR 20466-0685 0602 4 F/A/U 30-6005-001-0021
3660050010022	18400 SW 97 AVE	EDWARD P MACDOUGALL &W BARBARA J	18400 FRANJO ROAD	MIAMI, FL 33157-7023	5 56 40 .40 AC SUB OF PB 1-4 N160FT OF E185FT LOT 1 LESS N & E40FT & EXT AREA OF CURVE IN NE COR FOR R/W LOT SIZE 17266 SQ FT OR 18030-4987 0398 6 FAU 30 6005 001 0022
3660050010023	18460 SW 97 AVE	JOSE A & EVA SANABRIA CO-TRS	12850 SW 4 CT # 1 405	PEMBROKE PINES, FL 33027	5 56 40 .282 AC M/L SUB OF PB 1-4 S82FT OF E185FT OF N342FT OF LOT 1 LESS E35FT FOR ST LOT SIZE 82.000 X 150 OR 15939-3352 0493 5 COC 22244-4566 04 2004 4 F/A/U 30-6005-001-0023 COC 24878-0098 05 2006 5
3660050010024	18450 SW 97 AVE	HUBERT A & MICHAEL G THOMAS	21950 SW 184 AVE	MIAMI, FL 33170	5 56 40 .26 AC M/L SUB OF PB 1-4 BEG 160FTS & 35FT W OF NE COR OF LOT 1 W150FT S75FT E150FT N75FT TO POB LOT SIZE 75.000 X 150 OR 16090-0489 0993 1 F/A/U 30-6005-001-0024
3660050010080	18545 S DIXIE HWY	SONY INVESTMENT REAL ESTATE INC	1553 SAN IGNACIO AVE	CORAL GABLES, FL 33146 3006	5 56 40 .47 AC SUB OF PB 1-4 BEG 42FT N OF S/L TR 4 & E/L US 1 PB 50-89 TH NELY187.9FT TH E PARR C/L QUAIL ROOST DR 150FT SWLY187.9FT W150FT TO POB LESS S35FT FOR R/W OR 21579-3357 082003 6 F/A/U 30-6005-001-0080
3660050010091		CUTLER BAY TOWN CENTRE LLC	15715 S DIXIE HWY	PALMETTO BAY, FL 33157	5 56 40 SUB OF PB 1-4 PORT OF TR 12 DEF BEG AT NE COR OF TR 12 TH S 89 DEG W 32.25FT S 22 DEG W 370FT S 89 DEG W 108.27FT N 22 DEG E 390.19FT S 88 DEG E 132.68FT S 00 DEG E 15.02FT TO POB LOT SIZE 39307 SQ FT F/A/U 30-6005-001-0091 COC 23424-0601 04/2005
3660050010410	18600 S DIXIE HWY	SUNSHINE DADE INVEST LLC	1650 NW 87 AVE	DORAL, FL 33125	5 56 40 .849 AC SUB OF PB 1-4 PT OF LOTS 4 12 13 BEG X OF W/L US 1 & C/L SW 186 ST SWLY237.48FT DUE W200FT NELY237.48FT E ALG C/L SW 186 ST 200FT TO POB LESS N35FT FOR ST PR ADD 18600 US 1 LOT SIZE IRREGULAR OR 18316-1488-1559 1098 5 (79) F/A/U 30-6005-0
3660050010460	18660 S DIXIE HWY	COSINUS PROPERTIES INCC/O JACK THOMAS INC	338 MINORCA AVE	CORAL GABLES, FL 33134	5 56 40 .748 AC M/L SUB OF PB 1-4 PT LOTS 12 & 13 BEG 237.48FT SWLY OF X OF W/L US 1 & C/L SW 186 ST CONT SWLY 100FT W232.4FT NELY 99.99FT E232.5FT TO POB LOT SIZE 20924 SQ FT OR 12001-750 1283 5 F/A/U 30-6005-001-0460
3660050040980	18740 LENAIRE DR	GONZALO RAMOS	PO BOX 970614	MIAMI, FL 33197	5 56 40 BEL-AIRE SEC 1 PB 65-36 LOT 8 BLK 5 LOT SIZE 75.400 X 110 OR 16890-4182 0895 1 F/A/U 30-6005-004-0980
3660050040990	18730 LENAIRE DR	MICHAEL S HANDSCHMANN &W MARIA E	18730 LENAIRE DR	MIAMI, FL 33157-6960	BEL-AIRE SEC 1 PB 65-36 LOT 9 BLK 5 LOT SIZE 75 X 110 OR 15708-2466 1192 1 F/A/U 30-6005-004-0990
3660050041000	18720 LENAIRE DR	GABRIEL ARANGO &W ARACELLY	11756 SW 117 PL	MIAMI, FL 33186	BEL-AIRE SEC 1 PB 65-36 LOT 10 BLK 5 LOT SIZE 75.000 X 110 OR 1970-1218 0 2001 1 F/A/U 30-6005-004-1000
3660050041010	18710 LENAIRE DR	EVAN D MCLEAN & W MARTA	18710 LENAIRE DR	PERRINE, FL 33157-6960	BEL-AIRE SEC 1 PB 65-36 LOT 11 BLK 5 LOT SIZE 75.000 X 110 73R-305718 F/A/U 30-6005-004-1010
3660050041020	18700 LENAIRE DR	CESARFO FERNANDEZ	18700 LENAIRE DR	MIAMI, FL 33157-6960	5 56 40 BEL-AIRE SEC 1 PB 65-36 LOT 12 BLK 5 LOT SIZE 75.000 X 110 OR 14875-835 0191 5 F/A/U 30-6005-004-1020
3660050041030	18680 LENAIRE DR	MEDEROS INVESTMENTS L L C	13873 SW 41 TER	MIAMI, FL 33175	5 56 40 BEL-AIRE SEC 1 PB 65-36 LOT 13 BLK 5 LOT SIZE 75.000 X 110 OR 18385-0186 1298 4 F/A/U 30-6005-004-1030
3660050041040	18670 LENAIRE DR	SARA PRENDES	18670 LENAIRE DR	MIAMI, FL 33157-6961	BEL-AIRE SEC 1 PB 65-36 LOT 14 BLK 5 LOT SIZE 75.000 X 110 OR 19254-0969 072000 1 COC 21446-1737 06 2003 1 F/A/U 30-6005-004-1040

3660050041050	18660 LENAIRE DR	GERMANO CARREIRA & WPEGGY CARREIRA	18660 LENAIRE DR	MIAMI, FL 33157-6961	5 56 40 BEL-AIRE SEC 1 PB 65-36 LOT 15 BLK 5 LOT SIZE 75.000 X 110 CASE# 03-0516 CP F/A/U 30-6005-004-1050 COC 23725-2654 07 2005 1
3660050041060	18650 LENAIRE DR	JUAN M FERNANDEZ Y FENIA FERNANDEZ	18650 LENAIRE DR	CUTLER BAY, FL 33157-6961	BEL-AIRE SEC 1 PB 65-36 LOT 16 BLK 5 LOT SIZE IRREGULAR OR 14717-2961 0990 1 F/A/U 30-6005-004-1060 COC 26282-1907 03 2008 5
3660050041070	18640 LENAIRE DR	KEVIN ARMSTRONG	18640 LENAIRE DR	MIAMI, FL 33157-6961	BEL-AIRE SEC 1 PB 65-36 LOT 17 BLK 5 LOT SIZE 75.000 X 110 OR 16720-1415 0395 1 F/A/U 30-6005-004-1070
3660050041080	18630 LENAIRE DR	RAY B TEACHEY & W EVELYN	18630 LENAIRE DR	MIAMI, FL 33157-6961	BEL-AIRE SEC 1 PB 65-36 LOT 18 BLK 5 LOT SIZE 75.000 X 110 OR 18456-3556 0199 5 F/A/U 30-6005-004-1080
3660050041090	18620 LENAIRE DR	EDWIN TINOCO JESSICA CABRERA	11041 SW 161 ST	MIAMI, FL 33157	5 56 40 BEL-AIRE SEC 1 PB 65-36 LOT 19 BLK 5 LOT SIZE 81.500 X 110 OR 16510-2344 0894 1 F/A/U 30-6005-004-1090
3660050041100	18610 LENAIRE DR	DOLORES BATKO JEAN F BATKO	18610 LENAIRE DR	CUTLER BAY, FL 33157	5 56 40 BEL-AIRE SEC 1 PB 65-36 LOT 20 BLK 5 LOT SIZE 82.360 X 110 OR 16295-5410 0394 1 F/A/U 30-6005-004-1100
3660050041110	18600 LENAIRE DR	ALFJANDRO MEDINAGLORIA INES MEDINA	18600 LENAIRE DR	CUTLER BAY, FL 33157	BEL-AIRE SEC 1 LOT 21 LOT SIZE 10485 SQ FT OR 11058-899 0281 4 F/A/U 30-6005-004-1110
3660050041120	9970 BELGRADE RD	BETTY A DUNNING	9970 BELGRADE RD	MIAMI, FL 33157-6910	BEL-AIRE SEC 1 PB 65-36 LOT 1 BLK 6 LOT SIZE 99.000 X 125 F/A/U 30-6005-004-1120
3660050041130	9960 BELGRADE RD	CHRISTIAN G WILSON	130 HICKORY RD	WESTON, MA 02493	BEL-AIRE SEC 1 PB 65-36 LOT 2 BLK 6 LOT SIZE 75.000 X 125 OR 18165-1462 0698 1 COC 22776-0739 10 2004 4 F/A/U 30-6005-004-1130
3660050041140	9950 BELGRADE RD	MURRAY R CHINNERS EST OF	9950 BELGRADE RD	MIAMI, FL 33157-6910	5 56 40 BEL-AIRE SEC 1 PB 65-36 LOT 3 BLK 6 LOT SIZE 75.000 X 125 F/A/U 30-6005-004-1140
3660050041250	9844 STERLING DR	ANTONIO TERAN	9844 STERLING DR	MIAMI, FL 33157-6950	5 56 40 BEL-AIRE SEC 1 PB 65-36 LOT 14 BLK 6 LOT SIZE 78.000 X 125 OR 18808-3903 0999 1 F/A/U 30-6005-004-1250
3660050041260	9836 STERLING DR	OJ JOHNSON INC	7521 SW 165 TERR	MIAMI, FL 33157-3846	5 56 40 BEL-AIRE SEC 1 PB 65-36 LOT 15 BLK 6 LOT SIZE 78.000 X 125 OR 19257-3126 082000 1 F/A/U 30-6005-004-1260
3660050041270	9830 STERLING DR	LESLIA GARCIA	9830 STERLING DR	MIAMI, FL 33157	BEL-AIRE SEC 1 PB 65-36 LOT 16 BLK 6 LOT SIZE 78.000 X 125 OR 14301-3115 1089 1 F/A/U 30-6005-004-1270
3660050041280	9820 STERLING DR	JUDITH E CLIFFORD LEREM JAMES PHILLIP CLIFFORD	9820 STERLING DRIVE	MIAMI, FL 33157	BEL-AIRE SEC 1 PB 65-36 LOT 17 BLK 6 LOT SIZE 78.000 X 125 F/A/U 30-6005-004-1280
3660050041290	9810 STERLING DR	BEVERLY F WALTON LEREM CHRISTINE M CLARKE	9810 STERLING DR	MIAMI, FL 33157-6950	5 56 40 BEL-AIRE SEC 1 PB 65-36 LOT 18 BLK 6 LOT SIZE 78.000 X 125 OR 17277-2766 0796 1 F/A/U 30-6005-004-1290 COC 24737-2197 05 2006 5
3660050041300	9800 STERLING DR	EMERSON M GAITANJOANNA M GAITAN	9800 STERLING DR	CUTLER BAY, FL 33157	5 56 40 BEL-AIRE SEC 1 PB 65-36 LOT 19 BLK 6 LOT SIZE 78.000 X 125 OR 21052-2865 022003 4 F/A/U 30-6005-004-1300
3660050041310	9780 STERLING DR	ANA CRISTINA RODRIGUEZ	9780 STERLING DR	CUTLER BAY, FL 33157	BEL-AIRE SEC 1 PB 65-36 LOT 20 BLK 6 LOT SIZE 78.000 X 125 OR 18736-4473 0799 1 COC 21660-3861 08 2003 4 F/A/U 30-6005-004-1310
3660050041320	9770 STERLING DR	ELIZABETH SISI GARLAND DOUGLAS NATHANIEL GARLAND	9770 STERLING DR	CUTLER BAY, FL 33157	5 56 40 BEL-AIRE SEC 1 PB 65-36 LOT 21 BLK 6 LOT SIZE 78.000 X 125 OR 19165-2365 062000 1 F/A/U 30-6005-004-1320
3660050041330	9760 STERLING DR	DANIELLE CHRISTINE DIVO	9760 STERLING DR	CUTLER BAY, FL 33157	5 56 40 BEL-AIRE SEC 1 PB 65-36 LOT 22 BLK 6 LOT SIZE 78.000 X 125 OR 9407-1018 F/A/U 30-6005-004-1330 COC 25492-3998 / 3996 0307 6
3660050041340	9750 STERLING DR	JENNIFER HOLCOMBEDAVID L HOLCOMBE III	9750 STERLING DR	CUTLER BAY, FL 33157	BEL-AIRE SEC 1 PB 65-36 LOT 23 BLK 6 LOT SIZE 78.000 X 125 OR 15802-4149 0193 1 COC 23053-1403 01 2005 1 F/A/U 30-6005-004-1340
3660050041350	9740 STERLING DR	BI LIAN CHEN LEREM YONG PEI CHEN	9555 TIFFANY DRIVE	MIAMI, FL 33157	5 56 40 BEL-AIRE SEC 1 PB 65-36 LOT 24 BLK 6 LOT SIZE 78.000 X 125 COC 22797-1705 10 2004 6 F/A/U 30-6005-004-1350 COC 24052-0822 12 2005 4
3660050041360	9730 STERLING DR	JOYCE M GROSS	8413 GROVE ST	SILVER SPRING, MD 20910	BEL-AIRE SEC 1 PB 65-36 LOT 25 BLK 6 LOT SIZE 78.000 X 125 OR 20602-3114 082002 6 COC 22800-1676 11 2004 1 F/A/U 30-6005-004-1360 COC 26005-3521 10 2007 5
3660050041370	9720 STERLING DR	ISMAEL LLERA MENA	9720 STERLING DR	MIAMI, FL 33157	5 56 40 BEL-AIRE SEC 1 PB 65-36 LOT 26 BLK 6 LOT SIZE 78.000 X 125 OR 16933-2185 0995 1 COC 21386-2233 05 2003 4 F/A/U 30-6005-004-1370
3660050041380	9710 STERLING DR	EDWIN ORTIZ & W LILIAN	9710 STERLING DR	MIAMI, FL 33157-6948	BEL-AIRE SEC 1 PB 65-36 LOT 27 BLK 6 LOT SIZE 78.000 X 125 OR 17493-1294 1296 1 F/A/U 30-6005-004-1380
3660050041390					5 56 40 BEL-AIRE SEC 1 PB 65-36 LOT 28 BLK 6 LOT SIZE 78.000 X 125 OR 18080-1817 0498 1 F/A/U 30-6005-004-1390
3660050041400	18691 LENAIRE DR	MARIO J PEREZ & W TERESA M	18691 LENAIRE DR	MIAMI, FL 33157-6955	5 56 40 BEL-AIRE SEC 1 PB 65-36 LOT 1 BLK 7 LOT SIZE 100.000 X 110 OR 17295-2716 0696 1 F/A/U 30-6005-004-1400 COC 24520-2387 05 2006 5
3660050041410	18681 LENAIRE DR	JANICE DIKE LEREM WATCHTOWE BIBLE & TRACT	9941 BELVILLE RD	PERRINE, FL 33157-6924	5 56 40 BEL-AIRE SEC 1 PB 65-36 LOT 2 BLK 7 LOT SIZE 80.000 X 110 OR 10124-1840 0578 4 F/A/U 30-6005-004-1410
3660050041420	18671 LENAIRE DR	JANICE G DIKE LEREM WATCHTOWER BIBLE AND TRACT	9941 BELVILLE RD	PERRINE, FL 33157	5 56 40 BEL-AIRE SEC 1 PB 65-36 LOT 3 BLK 7 LOT SIZE 80.000 X 110 OR 15879-1973 0393 1 F/A/U 30-6005-004-1420
3660050041430	18661 LENAIRE DR	GALE S NELSON & W SHAUNTELL D	4255 SW 153 TERR	MIRAMAR, FL 33027	5 56 40 BEL-AIRE SEC 1 PB 65-36 LOT 4 BLK 7 LOT SIZE 80.00 X 110 OR 17625-0675 0497 1 F/A/U 30-6005-004-1430
3660050041440	18651 LENAIRE DR	GERMAN SANCHEZ MARILYN SANCHEZ	10163 SW 199 ST	CUTLER BAY, FL 33157	BEL-AIRE SEC 1 PB 65-36 LOT 5 BLK 7 LOT SIZE 80.000 X 110 OR 15874-3828 0493 1 F/A/U 30-6005-004-1440
3660050041450	18641 LENAIRE DR	JOAN LOIS REESE	18641 LENAIRE DR	PERRINE, FL 33157-6955	BEL-AIRE SEC 1 PB 65-36 LOT 6 BLK 7 LOT SIZE 80.000 X 110 F/A/U 30-6005-004-1450
3660050041460	18631 LENAIRE DR	EUSEBIO & DANIEL GONZALEZ	18610 BELVIEW DR	MIAMI, FL 33157-6920	BEL-AIRE SEC 1 PB 65-36 LOT 7 BLK 7 LOT SIZE 84.000 X 110 OR 12514-1222 0185 1 F/A/U 30-6005-004-1460
3660050041470	18621 LENAIRE DR	DEBORAH S RICHARDS	18621 LENAIRE DR	MIAMI, FL 33157-6955	BEL-AIRE SEC 1 PB 65-36 LOT 8 BLK 7 LOT SIZE 86.000 X 110 OR 10832-1034 0880 5 F/A/U 30-6005-004-1470
3660050041480	18611 LENAIRE DR	WILLIAM L MOSS	18611 LENAIRE DR	CUTLER BAY, FL 33157	BEL-AIRE SEC 1 PB 65-36 LOT 9 BLK 7 LOT SIZE 86.000 X 110 OR 13127-1872 1186 1 F/A/U 30-6005-004-1480
3660050041490	18601 LENAIRE DR	O M D NEW BEGINNINGS INC	11225 SW 95 ST	MIAMI, FL 33176	BEL-AIRE SEC 1 PB 65-36 LOT 10 BLK 7 LOT SIZE 99.330 X 110 F/A/U 30-6005-004-1490



3660050041500	18600 BELVIEW DR	CINDY L DRISKA	18600 BELVIEW DR	MIAMI, FL 33157-6920	5'56'40" BEL-AIRE SEC 1 PB 65-36 LOT 11 BLK 7 LOT SIZE 102.110 X 110 OR 20603-2837 082002 1 F/A/U 30-6005-004-1500
3660050041510	18610 BELVIEW DR	JOSEFINA GONZALEZ	18610 BELVIEW DR	MIAMI, FL 33157-6920	BEL-AIRE SEC 1 PB 65-36 LOT 12 BLK 7 LOT SIZE 90.000 X 110 74R-139704 F/A/U 30-6005-004-1510
3660050041520	18620 BELVIEW DR	MARTIN ERRAZOLAVILMA RODRIGUEZ	18620 BELVIEW DRIVE	CUTLER BAY, FL 33157	BEL-AIRE SEC 1 PB 65-36 LOT 13 BLK 7 LOT SIZE 90.000 X 110 OR 17176-0635 0396 1 F/A/U 30-6005-004-1520
3660050041530	18630 BELVIEW DR	ROBERT METZLER & W PEGI	18630 BELVIEW DR	MIAMI, FL 33157-6920	BEL-AIRE SEC 1 PB 65-36 LOT 14 BLK 7 LOT SIZE 90.000 X 110 OR 11945-1276 1083 1 F/A/U 30-6005-004-1530
3660050041540	18640 BELVIEW DR	HECTOR LUIS COLON VELEZ JRDIANA MARIE ARVELO	18640 BELVIEW DR	CUTLER BAY, FL 33157	5'56'40" BEL-AIRE SEC 1 PB 65-36 LOT 15 BLK 7 LOT SIZE 77.140 X 110 OR 19914-0270 092001 4 COC 22121-2134 03 2004 1 F/A/U 30-6005-004-1540
3660050041550	18650 BELVIEW DR	JOSE HRAIZ	18650 BELVIEW DR	MIAMI, FL 33157-6920	BEL-AIRE SEC 1 PB 65-36 LOT 16 BLK 7 LOT SIZE 75.000 X 110 OR 13086-1505 1186 1 F/A/U 30-6005-004-1550
3660050041560	18660 BELVIEW DR	VICTOR R PENA	18660 BELVIEW DR	MIAMI, FL 33157	BEL-AIRE SEC 1 PB 65-36 LOT 17 BLK 7 LOT SIZE 75.000 X 110 OR 17902-0925 0297 4 F/A/U 30-6005-004-1560
3660050041570	18670 BELVIEW DR	ELVIRA J MOSCOSO	18670 BELVIEW DR	MIAMI, FL 33157	5'56'40" BEL-AIRE SEC 1 PB 65-36 LOT 18 BLK 7 LOT SIZE 75.000 X 110 COC 22412-1690 06 2004 5 F/A/U 30-6005-004-1570 COC 25502-0304 04 2007 5
3660050041580	18680 BELVIEW DR	GLENDIA TREJOALFREDO TREJO	18680 BELVIEW DR	MIAMI, FL 33157-6920	5'56'40" BEL-AIRE SEC 1 PB 65-36 LOT 19 BLK 7 LOT SIZE 75.000 X 110 OR 18859-1916 1099 1 COC 22244-3032 04 2004 4 F/A/U 30-6005-004-1580
3660050041590	18690 BELVIEW DR	LINA URENA	18690 BELVIEW DR	MIAMI, FL 33157-6920	BEL-AIRE SEC 1 PB 65-36 LOT 20 BLK 7 LOT SIZE 75.000 X 110 OR 19641-0940 042001 1 F/A/U 30-6005-004-1590
3660050041600	18700 BELVIEW DR	STEPHEN T HUNT & JORGE L MUNOZ & AMAPARO JIMENEZ	18700 BELVIEW DR	MIAMI, FL 33157-6952	5'56'40" BEL-AIRE SEC 1 PB 65-36 LOT 21 BLK 7 LOT SIZE 100.000 X 110 OR 17883-0066 1197 1 F/A/U 30-6005-004-1600
3660050041610	18711 BELVIEW DR	CARLOS M DE J PRADO IIIJAMIE F PRADO	18711 BELVIEW DR	MIAMI, FL 33157	BEL-AIRE SEC 1 LOT 1 BLK 8 PB 65-36 LOT SIZE 100.000 X 110 F/A/U 30-6005-004-1610 COC 24901-1838 08 2006 1
3660050041620	18701 BELVIEW DR	STUART LONES & DIANE SABO	18701 BELVIEW DR	MIAMI, FL 33157-6958	5'56'40" BEL-AIRE SEC 1 PB 65-36 LOT 2 BLK 8 LOT SIZE 75.000 X 110 OR 19553-1542 032001 1 F/A/U 30-6005-004-1620
3660050041630	18691 BELVIEW DR	DONALD J BELLINGERTERA N FANNIN ETALS	18691 BELVIEW DRIVE	CUTLER BAY, FL 33157	BEL-AIRE SEC 1 PB 65-36 LOT 3 BLK 8 LOT SIZE 75.000 X 110 OR 20306-3968 032002 4 F/A/U 30-6005-004-1630
3660050041640	18681 BELVIEW DR	JUAN C GARCIA JRJULIE GORDILS	18681 BELVIEW DR	CUTLER BAY, FL 33157	BEL-AIRE SEC 1 PB 65-36 LOT 4 BLK 8 LOT SIZE 75.000 X 110 OR 19670-1931 042001 6 COC 22836-1946 09 2004 4 F/A/U 30-6005-004-1640
3660050041650					BEL-AIRE SEC 1 PB 65-36 LOT 5 BLK 8 LOT SIZE 75.000 X 110 OR 16048-0516 0993 1 F/A/U 30-6005-004-1650
3660050041660	18661 BELVIEW DR	WILLIAM J FEUER & W ANNE E	18661 BELVIEW DR	MIAMI, FL 33157-6919	5'56'40" BEL-AIRE SEC 1 PB 65-36 LOT 6 BLK 8 LOT SIZE 75.000 X 110 OR 15139-2175 0791 1 F/A/U 30-6005-004-1660
3660050041670	18651 BELVIEW DR	ORLANDO V RODRIGUEZ JRPATRICIA PRINS	18651 BELVIEW DR	CUTLER BAY, FL 33157	5'56'40" BEL-AIRE SEC 1 PB 65-36 LOT 7 BLK 8 LOT SIZE 77.000 X 110 OR 19492-4941 012001 6 COC 23410-0003 05 2005 1 F/A/U 30-6005-004-1670
3660050041680	18641 BELVIEW DR	JORGE SEPULVEDACINDY MARIE SEPULVEDA	18641 BELVIEW DR	CUTLER BAY, FL 33157	BEL-AIRE SEC 1 PB 65-36 LOT 8 BLK 8 LOT SIZE 79.000 X 110 OR 21039-3236 112002 5 COC 21533-0807 05 2003 6 F/A/U 30-6005-004-1680
3660050041690	18631 BELVIEW DR	JAIME CASTILLOMYRIAM CASTILLO	16922 SW 112 CT #V-3343	MIAMI, FL 33157	5'56'40" BEL-AIRE SEC 1 PB 65-36 LOT 9 BLK 8 LOT SIZE 79.000 X 110 OR 20472-0207 062002 1 F/A/U 30-6005-004-1690
3660050041700	18621 BELVIEW DR	NELSON GARCIA	18621 BELVIEW DR	CUTLER BAY, FL 33157	BEL-AIRE SEC 1 PB 65-36 LOT 10 BLK 8 LOT SIZE 79.000 X 110 F/A/U 30-6005-004-1700
3660050041710	18611 BELVIEW DR	FELINA PEREZ	18611 BELVIEW DR	MIAMI, FL 33189	BEL-AIRE SEC 1 PB 65-36 LOT 11 BLK 8 LOT SIZE 79.000 X 110 OR 18331-3942 1098 6 F/A/U 30-6005-004-1710
3660050041720	18601 BELVIEW DR	MARIO GUERRA	18601 BELVIEW DR	CUTLER BAY, FL 33157	BEL-AIRE SEC 1 PB 65-36 LOT 12 BLK 8 LOT SIZE 94.480 X 110 OR 18930-1977 1299 4 F/A/U 30-6005-004-1720
3660050041730	18600 BELMONT DR	MICHELLE CORTINAJUAN C CHANQUIN	18600 BELMONT DR	MIAMI, FL 33157-6912	BEL-AIRE SEC 1 PB 65-36 LOT 13 BLK 8 LOT SIZE 101.050 X 110 OR 19308-4599 082000 1 COC 22007-2277 11 2003 1 F/A/U 30-6005-004-1730
3660050041740					BEL-AIRE SEC 1 PB 65-36 LOT 14 BLK 8 LOT SIZE 79.000 X 110 PROB CS# 89-1710(01) 1289 5 F/A/U 30-6005-004-1740
3660050041750					5'56'40" BEL-AIRE SEC 1 PB 65-36 LOT 15 BLK 8 LOT SIZE 79.000 X 110 OR 17582-3328 0397 1 F/A/U 30-6005-004-1750 COC 24109-4076 12 2005 1
3660050041760	18630 BELMONT DR	DAPHNE I MANN LEREM KIMBERLY POGODZINSKI	18630 BELMONT DR	MIAMI, FL 33157	5'56'40" BEL-AIRE SEC 1 PB 65-36 LOT 16 BLK 8 LOT SIZE 79.000 X 110 F/A/U 30-6005-004-1760
3660050041770	18640 BELMONT DR	NURY A CHILMAZA	18640 BELMONT DR	MIAMI, FL 33157	BEL-AIRE SEC 1 PB 65-36 LOT 17 BLK 8 LOT SIZE 79.000 X 110 OR 20600-4947 082002 1 F/A/U 30-6005-004-1770
3660050041780	18650 BELMONT DR	LAZARO TOSCANOJESSICA VIQUEZ	18650 BELMONT DR	CUTLER BAY, FL 33157-6912	BEL-AIRE SEC 1 PB 65-36 LOT 18 BLK 8 LOT SIZE 78.360 X 110 OR 20371-3376 082001 4 COC 23483-4320 05 2005 1 F/A/U 30-6005-004-1780
3660050041790	18660 BELMONT DR	FRANCES T SANSONE TRSFRANCES T SANSONE	18660 BELMONT DR	CUTLER BAY, FL 33157	5'56'40" BEL-AIRE SEC 1 PB 65-36 LOT 19 BLK 8 LOT SIZE 83.000 X 110 F/A/U 30-6005-004-1790
3660050041800	18670 BELMONT DR	FRANK MARTINEZ	18670 BELMONT DR	CUTLER BAY, FL 33157	BEL-AIRE SEC 1 PB 65-36 LOT 20 BLK 8 LOT SIZE 83.000 X 110 F/A/U 30-6005-004-1800
3660050041810	18680 BELMONT DR	DANIEL A RIVERO	18680 BELMONT DR	CUTLER BAY, FL 33157	BEL-AIRE SEC 1 PB 65-36 LOT 21 BLK 8 LOT SIZE 83.000 X 110 OR 16393-2157 0694 5 F/A/U 30-6005-004-1810
3660050041820	18690 BELMONT DR	CHARLES E BENN II	9720 SW 119 ST	MIAMI, FL 33176-4136	BEL-AIRE SEC 1 PB 65-36 LOT 22 BLK 8 LOT SIZE 83.000 X 110 OR 10475-1324 0679 6 F/A/U 30-6005-004-1820
3660050041830	18700 BELMONT DR	RENE RODRIGUEZ	18700 BELMONT DR	CUTLER BAY, FL 33157	5'56'40" BEL-AIRE SEC 1 PB 65-36 LOT 23 BLK 8 LOT SIZE 83.000 X 110 OR 17076-2582 0196 4 COC 21299-4041 23713-2684 0503 1 F/A/U 30-6005-004-1830
3660050041840	18710 BELMONT DR	C P MIGLIACCIO & W MARTHA JEAN	18710 BELMONT DR	MIAMI, FL 33157-6914	BEL-AIRE SEC 1 PB 65-36 LOT 24 BLK 8 LOT SIZE 100.000 X 110 OR 10106 1873 0778 1 F/A/U 30-6005-004-1840

3660050041850	18721 BELMONT DR	MICHELLE JACQUELINE DE LA CRUZ	18721 BELMONT DR	CUTLER BAY, FL 33157	BEL-AIRE SEC 1 PB 65-36 LOT 1 BLK 9 LOT SIZE 100.000 X 110 OR 12648-1927 0985 1 F/A/U 30-6005-004-1850
3660050041860	18711 BELMONT DR	NANCY P SAFREID	18711 BELMONT DR	MIAMI, FL 33157-6913	BEL-AIRE SEC 1 PB 65-36 LOT 2 BLK 9 LOT SIZE 81.000 X 114 OR 13848-0482 0988 1 COC 22080-3375 02 2004 1 F/A/U 30-6005-004-1860
3660050041870	18701 BELMONT DR	TABITHA A ARAGON	18701 BELMONT DR	CUTLER BAY, FL 33157	5 56 40 BEL-AIRE SEC 1 PB 65-36 LOT 3 BLK 9 LOT SIZE 81.000 X 121 OR 14914-2000 0291 1 F/A/U 30-6005-004-1870
3660050041880	18691 BELMONT DR	MARCO PRATA & W ZORAIDA	18691 BELMONT DR	MIAMI, FL 33157-6911	BEL-AIRE SEC 1 PB 65-36 LOT 4 BLK 9 LOT SIZE 81.000 X 128 OR 19140-1350 062000 6 COC 22812-0941 10 2004 1 F/A/U 30-6005-004-1880
3660050041890	18681 BELMONT DR	RENE O RAMOS	18681 BELMONT DR	MIAMI, FL 33157-6911	5 56 40 BEL-AIRE SEC 1 PB 65-36 LOT 5 BLK 9 LOT SIZE 81.000 X 135 OR 18877-2108 1199 1 F/A/U 30-6005-004-1890
3660050041900	18671 BELMONT DR	FRANCIS T SANSONE & MARIA S SMOAK	18660 BELMONT DR	MIAMI, FL 33157-6912	5 56 40 BEL-AIRE SEC 1 PB 65-36 LOT 6 BLK 9 LOT SIZE 81.000 X 141 OR 19974-2921 10 2001 4 F/A/U 30-6005-004-1900
3660050041910	18661 BELMONT DR	ERNESTO DIAZ DE LAS CUEVASLEGNA PEREZ ROJAS	18661 BELMONT DR	CUTLER BAY, FL 33157	BEL-AIRE SEC 1 PB 65-36 LOT 7 BLK 9 LOT SIZE 77.060 X 150 OR 17379-1176 0996 1 F/A/U 30-6005-004-1910
3660050041920	18651 BELMONT DR	STEVEN COPESTICK	18651 BELMONT DR	MIAMI, FL 33157-6911	BEL-AIRE SEC 1 PB 65-36 LOT 8 BLK 9 LOT SIZE 75.000 X 147 OR 11832-1138 0683 1 F/A/U 30-6005-004-1920
3660050041930	18641 BELMONT DR	MARTHA D SUAREZ	18641 BELMONT DR	MIAMI, FL 33177	BEL-AIRE SEC 1 PB 65-36 LOT 9 BLK 9 LOT SIZE 80.000 X 132 OR 17721-2746 0797 1 F/A/U 30-6005-004-1930
3660050041940	18631 BELMONT DR	ANGELA TATIANA PINZON	18631 BELMONT DR	CUTLER BAY, FL 33157	BEL-AIRE SEC 1 PB 65-36 LOT 10 BLK 9 LOT SIZE 79.060 X 119 OR 19471-3861 122000 1 F/A/U 30-6005-004-1940
3660050041950	18621 BELMONT DR	THE REGNA FAMILY TRSCARMINE L REGNA	18621 BELMONT DR	MIAMI, FL 33157	5 56 40 BEL-AIRE SEC 1 PB 65-36 LOT 11 BLK 9 LOT SIZE 78.000 X 110 F/A/U 30-6005-004-1950
3660050041960	18611 BELMONT DR	INGRID S PRAZINKO	18611 BELMONT DR	MIAMI, FL 33157-6911	BEL-AIRE SEC 1 PB 65-36 LOT 12 BLK 9 LOT SIZE 78.000 X 106 F/A/U 30-6005-004-1960
3660050041970	18601 BELMONT DR	JOSEPH W BIANCOLA & WHERIE L	18601 BELMONT DR	MIAMI, FL 33157-6911	5 56 40 BEL-AIRE SEC 1 PB 65-36 LOT 13 BLK 9 LOT SIZE 100.470 X 105 OR 13397-2616 0887 1 F/A/U 30-6005-004-1970
3660050041980	18600 SW 98 AVE	AGUSTIN A LAFONT CASTELLONCELIA J HERNANDEZ	18600 SW 98 AVE	CUTLER BAY, FL 33157	5 56 40 BEL-AIRE SEC 1 PB 65-36 LOT 14 BLK 9 LOT SIZE 100.000 X 113 OR 15755-3508 1292 1 F/A/U 30-6005-004-1980
3660050041990	18610 SW 98 AVE	BRIDGETTE M DESOUZA	18610 SW 98 AVE	CUTLER BAY, FL 33157	5 56 40 BEL-AIRE SEC 1 PB 65-36 LOT 15 BLK 9 LOT SIZE 80.000 X 120 OR 18057-2539 0398 4 F/A/U 30-6005-004-1990
3660050042000	18620 SW 98 AVE	RICARDO CAMPOS MUNOZMARLENE MENENDEZ PINEDA	18620 SW 98 AVE	CUTLER BAY, FL 33157-6947	BEL-AIRE SEC 1 PB 65-36 LOT 16 BLK 9 LOT SIZE 80.000 X 125 OR 18508-2187 0299 4 F/A/U 30-6005-004-2000 COC 25176-3868 12 2006 1
3660050042010	18630 SW 98 AVE	ELIO ROMAN & W BARBARA	11940 NW 23 ST	HOLLYWOOD, FL 33026	5 56 40 BEL-AIRE SEC 1 PB 65-36 LOT 17 BLK 9 LOT SIZE 75.000 X 130 OR 17716-2652 0797 1 F/A/U 30-6005-004-2010
3660050042020	18640 SW 98 AVE	SHATDAL KAMAL & W DEEPTI	15242 SW 146 ST	MIAMI, FL 33196	BEL-AIRE SEC 1 PB 65-36 LOT 18 BLK 9 LOT SIZE 75.000 X 136 OR 18629-2556 0599 1 F/A/U 30-6005-004-2020
3660050042030	18650 SW 98 AVE	ANNALJET TORRES	9955 SW 102 AVENUE RD	MIAMI, FL 33176	BEL-AIRE SEC 1 PB 65-36 LOT 19 BLK 9 LOT SIZE 75.130 X 146 OR 19039-4058 032000 4 F/A/U 30-6005-004-2030
3660050042040	9801 STERLING DR	STEVEN G ENGELMEYER & W JOAN C	9801 STERLING DR	MIAMI, FL 33157-6949	BEL-AIRE SEC 1 PB 65-36 LOT 20 BLK 9 LOT SIZE 15134 SQ FT OR 17626-1721 0497 4 F/A/U 30-6005-004-2040
3660050042050	9815 STERLING DR	THOMAS P FITZGERALD	9815 STERLING DR	MIAMI, FL 33157-6949	BEL-AIRE SEC 1 PB 65-36 LOT 21 BLK 9 LOT SIZE 83.000 X 166 OR 17081-2711 0195 1 F/A/U 30-6005-004-2050
3660050042060	9825 STERLING DR	CARLOS M SILVEIRA	9825 STERLING DR	MIAMI, FL 33157-6949	BEL-AIRE SEC 1 PB 65-36 LOT 22 BLK 9 LOT SIZE 81.000 X 143 OR 20347-0551 042002 1 F/A/U 30-6005-004-2060
3660050042070	9835 STERLING DR	JASON C KIRK JTRS.JESSICA MESA JTRS	9835 STERLING DRIVE	MIAMI, FL 33157	BEL-AIRE SEC 1 PB 65-36 LOT 23 BLK 9 LOT SIZE 81.000 X 126 OR 18546-0150 0399 1 F/A/U 30-6005-004-2070
3660050042080	9845 STERLING DR	JORGE GONZALEZMARIA M ARTILES ABLEDO	9845 STERLING DR	CUTLER BAY, FL 33157	BEL-AIRE SEC 1 PB 65-36 LOT 24 BLK 9 LOT SIZE 81.000 X 115 OR 16500-3060 0894 1 F/A/U 30-6005-004-2080
3660050042090	9855 STERLING DR	YILIAN ESTRADA	9855 STERLING DR	MIAMI, FL 33177	BEL-AIRE SEC 1 PB 65-36 LOT 25 BLK 9 LOT SIZE 80.000 X 109 F/A/U 30-6005-004-2090 COC 26023-2870 10 2007 1
3660050042100	9865 STERLING DR	CRAIG STEBBINS	9865 STERLING DR	CUTLER BAY, FL 33175	5 56 40 BEL-AIRE SEC 1 PB 65-36 LOT 26 BLK 9 LOT SIZE 75.000 X 109 OR 17368-2751 0896 4 COC 22735-4058 09 2004 1 F/A/U 30-6005-004-2100
3660050042120	18651 SW 98 AVE	ESTEBAN GIL & W DARIS DIAZ	18651 SW 98 AVE	MIAMI, FL 33157-6946	BEL-AIRE SEC 1 PB 65-36 LOT 1 BLK 10 LOT SIZE 13759 SQ FT OR 19294-4588 082000 4 COC 23029-3321 01 2005 1 F/A/U 30-6005-004-2120
3660050042130	18641 SW 98 AVE	MATHEW ALLEN STAES	18641 SW 98 AVE	CUTLER BAY, FL 33157	BEL-AIRE SEC 1 PB 65-36 LOT 2 BLK 10 LOT SIZE 75.000 X 110 OR 9970-0934 0378-1 F/A/U 30-6005-004-2130 COC 23949-3093 10 2005 1
3660050042140	18631 SW 98 AVE	CHRISTINE M CINTRON	18631 SW 98 AVE	MIAMI, FL 33157-6946	BEL-AIRE SEC 1 PB 65-36 LOT 3 BLK 10 LOT SIZE 75.000 X 110 OR 18739-4682 0899 4 COC 21546-3636 07 2003 4 F/A/U 30-6005-004-2140
3660050042150	18621 SW 98 AVE	MEDEROS INVESTMENTS LLC	18621 SW 98 AVE	CUTLER BAY, FL 33157	5 56 40 BEL-AIRE SEC 1 PB 65-36 LOT 4 BLK 10 LOT SIZE 75.000 X 110 OR 17719-2173 0797 4 F/A/U 30-6005-004-2150
					5 56 40 BEL-AIRE SEC 1 PB 65-36 LOT 5 BLK 10 LOT SIZE 75.000 X 110 OR 15890-2340 0493 1 COC 23087-2994 01 2005 1 F/A/U 30-6005-004-2160 COC 25743-2005 03 2007 1
3660050042160	18615 SW 98 AVE	YOISIS PEVIDA & DIANFLYS MARTINEZ JTRS	18615 SW 98 AVE	MIAMI, FL 33157	BEL-AIRE SEC 1 PB 65-36 LOT 6 BLK 10 LOT SIZE 100.000 X 110 OR 19768-4554 062001 4 COC 21343-1922 04 2003 4 F/A/U 30-6005-004-2170
3660050042170	18601 SW 98 AVE	MIREYA CABALLERO JTRS.JOSE H CABALLERO JTRS	18601 SW 98 AVE	MIAMI, FL 33157	BEL-AIRE SEC 1 PB 65-36 LOT 7 BLK 10 LOT SIZE 100.000 X 110 OR 17044-0356 0895 4 COC 22529-3855 07 2004 4 F/A/U 30-6005-004-2180 COC 23848-0785 10 2005 4
3660050042180	18600 SW 97 PL	MIAMI305REALESTATE LLC	11301 S DIXIE HWY 5637	MIAMI, FL 33156	BEL-AIRE SEC 1 PB 65-36 LOT 8 BLK 10 LOT SIZE 75.000 X 110 73R-192472 COC 22088-3139 02 2004 1 F/A/U 30-6005-004-2190
3660050042190	18610 SW 97 PL	AVELINA CABANAS	18610 SW 97 PL	MIAMI, FL 33157-6945	5 56 40 BEL-AIRE SEC 1 PB 65-36 LOT 9 BLK 10 LOT SIZE 75.000 X 110 OR 17140-4333 0396 1 F/A/U 30-6005-004-2200
3660050042200	18620 SW 97 PL	KATHY HOUSTON	18620 SW 97 PL	MIAMI, FL 33157-6945	



3660050042210	18630 SW 97 PL	DAYLIN DIAZ	18630 SW 97 PL	CUTLER BAY, FL 33157	BEL-AIRE SEC 1 PB 65-36 LOT 10 BLK 10 LOT SIZE 75.000 X 110 OR 19904-0909 092001 1 F/A/U 30-6005-004-2210
3660050042220	18640 SW 97 PL	RENE M THOMAS & JORGE L VALLE	18640 SW 97 PL	MIAMI, FL 33157-6945	5 56 40 BEL-AIRE SEC 1 PB 65-36 LOT 11 BLK 10 LOT SIZE 14748 SQ FT OR 16599 5188 1294 1 F/A/U 30-6005-004-2220
3660050042230	18631 SW 97 PL	MARIE EVELYN EL BORNO FLORES	18631 SW 97 PL	MIAMI, FL 33157-6944	BEL-AIRE SEC 1 PB 65-36 LOT 1 BLK 11 LOT SIZE 12404 SQ FT OR 16947-1602 0995 4 F/A/U 30-6005-004-2230
3660050042240	18621 SW 97 PL	ESTEVAN DIAZASHLEY NICOLE BARABE	18621 SW 97 PL	CUTLER BAY, FL 33157	BEL-AIRE SEC 1 PB 65-36 LOT 2 BLK 11 LOT SIZE 85.000 X 105 F/A/U 30-6005-004-2240
3660050042250	18611 SW 97 PL	FREDY GAINZA LOPEZNANCY C ALEMAN	18611 SW 97 PL	CUTLER BAY, FL 33157	BEL-AIRE SEC 1 PB 65-36 LOT 3 BLK 11 LOT SIZE 85.000 X 105 OR 12243-439 0884 1 F/A/U 30-6005-004-2250 COC 25574-1094 04 2007 1
3660050042260	18601 SW 97 PL	EDDY MIGUEL A TACTUK	18601 SW 97 PL	MIAMI, FL 33157	5 56 40 BEL-AIRE SEC 1 PB 65-36 LOT 4 BLK 11 LOT SIZE 105.000 X 100 OR 15096-2933 0791 1 F/A/U 30-6005-004-2260
3660050042270	18600 SW 97 CT	MARIO CALCINA	18600 SW 97 CT	MIAMI, FL 33157-6943	BEL-AIRE SEC 1 PB 65-36 LOT 5 BLK 11 LOT SIZE 105.000 X 100 OR 17057-1810 0196 1 F/A/U 30-6005-004-2270
3660050042280	18610 SW 97 CT	OSVALDO AGUILA	18610 SW 97 CT	CUTLER BAY, FL 33157	5 56 40 BEL-AIRE SEC 1 PB 65-36 LOT 6 BLK 11 OR 20134-1598 012002 1 F/A/U 30-6005-004-2280
3660050042290	18620 SW 97 CT	BARBARA G WILLIAMS	18620 SW 97 CT	MIAMI, FL 33157-6943	BEL-AIRE SEC 1 PB 65-36 LOT 7 BLK 11 LOT SIZE 75.000 X 105 OR 10508-905 0879 6 F/A/U 30-6005-004-2290
3660050042300	18630 SW 97 CT	ROBERT GIORDANO & W MARIE D	18630 SW 97 CT	MIAMI, FL 33157-6943	BEL-AIRE SEC 1 PB 65-36 LOT 8 BLK 11 LOT SIZE 10714 SQ FT OR 13818-2011 0988 1 F/A/U 30-6005-004-2300
3660050042310	18631 SW 97 CT	JOSEPH L FULLMORE	18631 SW 97 CT	MIAMI, FL 33157-6942	BEL-AIRE SEC 1 PB 65-36 LOT 1 BLK 12 LOT SIZE 91.370 X 105 OR 10180-0709 1078 1 F/A/U 30-6005-004-2310
3660050042320	18621 SW 97 CT	MARIA D NUNEZ	18621 SW 97 CT	MIAMI, FL 33157	BEL-AIRE SEC 1 PB 65-36 LOT 2 BLK 12 LOT SIZE 75.000 X 105 OR 20580-1298 052002 6 COC 22751-0612 09 2004 5 F/A/U 30-6005-004-2320
3660050042330	18611 SW 97 CT	JORGE A CARBALLES	18611 SW 97 CT	MIAMI, FL 33157-6942	BEL-AIRE SEC 1 PB 65-36 LOT 3 BLK 12 LOT SIZE 75.000 X 105 COC 22570-1391 07 2004 1 F/A/U 30-6005-004-2330
3660050042340	18601 SW 97 CT	LORRAINE M HOLTERMAN TRS JOHN M HOLTERMAN LIV TRUST	18601 SW 97 CT	MIAMI, FL 33157	5 56 40 BEL-AIRE SEC 1 PB 65-36 LOT 4 BLK 12 LOT SIZE 90.000 X 105 COC 26159-0425 05 2007 5
3660050042350	18600 SW 97 AVE	JESSICA WELSH	18600 SW 97 AVE	MIAMI, FL 33157-7027	5 56 40 BEL-AIRE SEC 1 PB 65-36 LOT 5 BLK 12 LOT SIZE 85.000 X 112 OR 11496-620 0782 5 F/A/U 30-6005-004-2350 COC 24948-0435 09 2006 5
3660050042360	18610 SW 97 AVE	JOSE A ALFAROANA M LIANES	18610 SW 97 AVE	MIAMI, FL 33157-7027	5 56 40 BEL-AIRE SEC 1 PB 65-36 LOT 6 BLK 12 LOT SIZE 75.000 X 115 OR 18020-3818 0398 4 COC 21358-2603 06 2003 1 F/A/U 30-6005-004-2360
3660050042370	18620 SW 97 AVE	ARNALDO LORENZO	18620 SW 97 AVE	MIAMI, FL 33157-7027	BEL-AIRE SEC 1 PB 65-36 LOT 7 BLK 12 LOT SIZE 75.000 X 114 OR 18696-1279 0799 1 F/A/U 30-6005-004-2370
3660050042380	18630 SW 97 AVE	FRANK VALLES JR	18630 SW 97 AVE	MIAMI, FL 33157	BEL-AIRE SEC 1 PB 65-36 LOT 8 BLK 12 LOT SIZE 88.680 X 114 OR 9531-116 F/A/U 30-6005-004-2380
3660050080960	9701 BEL AIRE DR	CHARLES WARDLOW & W LILIANA A	9701 BELAIRE DR	MIAMI, FL 33157-7852	BEL-AIRE SEC 3 PB 65-133 LOT 1 BLK 25 LOT SIZE 116.790 X 125 OR 17593-3973 0397 1 F/A/U 30-6005-008-0960
3660050080970	9711 BEL AIRE DR	ALEIDA RAMOS	9801 BEL AIRE DR	CUTLER BAY, FL 33157	BEL-AIRE SEC 3 PB 65-133 LOT 2 BLK 25 LOT SIZE 81.940 X 125 OR 16267-0612 0294 1 F/A/U 30-6005-008-0970
3660050080980					BEL-AIRE SEC 3 PB 65-133 LOT 3 BLK 25 LOT SIZE 81.940 X 125 OR 15807-4805 0293 1 F/A/U 30-6005-008-0980
3660050080990	9731 BEL AIRE DR	WANIDA K SIMMONS	9731 BEL AIRE DR	MIAMI, FL 33157-7852	BEL-AIRE SEC 3 PB 65-133 LOT 4 BLK 25 LOT SIZE 81.940 X 125 OR 20719-2529 092002 1 F/A/U 30-6005-008-0990
3660050081000	9741 BEL AIRE DR	DANIEL E ESCOBARJOAN VALASEK	9741 BEL AIRE DR	CUTLER BAY, FL 33157	BEL-AIRE SEC 3 PB 65-133 LOT 5 BLK 25 LOT SIZE 81.940 X 125 OR 20962-4691 012003 1 F/A/U 30-6005-008-1000
3660050081010	9751 BEL AIRE DR	BETTY JEAN CORTNER & BETTY JEAN HOUGHIN CORTNER	27 TANGLEWOOD RD	NEWNAN, GA 30263	BEL-AIRE SEC 3 PB 65-133 LOT 6 BLK 25 LOT SIZE 81.940 X 125 OR 16806-1679 0994 5 F/A/U 30-6005-008-1010
3660050081020	9761 BEL AIRE DR	CHRISTOPHER P LOPEZ	9761 BEL AIRE DRIVE	CUTLER BAY, FL 33157	BEL-AIRE SEC 3 PB 65-133 LOT 7 BLK 25 LOT SIZE 81.940 X 125 OR 19065-1565 042000 1 F/A/U 30-6005-008-1020
3660050081030	9771 BEL AIRE DR	CHARLES LAUSTED	9771 BELAIRE DR	MIAMI, FL 33157-7852	BEL-AIRE SEC 3 PB 65-133 LOT 8 BLK 25 LOT SIZE 81.940 X 125 OR 14194-3585 0789 1 F/A/U 30-6005-008-1030
3660050200010	18605 SW 100 AVE	YAN GONZALEZ	4602 E 10TH CT	HALEAH, FL 33013-2108	POINT ROYALE SEC 5 PB 100-2 LOT 1 BLK 9 LOT SIZE 72.550 X 132 OR 20294-3884 032002 1 COC 23458-2274 06 2005 1 F/A/U 30-6005-020-0010
3660050200020	18615 SW 100 AVE	ROY A FORBES	71 MASSACHUSETTS AVE	BAY SHORE, NY 11706	POINT ROYALE SEC 5 PB 100-2 LOT 2 BLK 9 LOT SIZE 95.450 X 120 OR 12808-2112 0186 1 F/A/U 30-6005-020-0020
3660050200030	18625 SW 100 AVE	TOWN & COUNTRY INVESTMENTS	8224 NW 30 TER	MIAMI, FL 33122	POINT ROYALE SEC 5 PB 100-2 LOT 3 BLK 9 LOT SIZE 80.000 X 120 OR 17820-0081 0997 1 F/A/U 30-6005-020-0030 COC 25502-2566 03 2007 1
3660050200040	18635 SW 100 AVE	BTJ 2015 LLC	11860 SW 123 PL	MIAMI, FL 33186	POINT ROYALE SEC 5 PB 100-2 LOT 4 BLK 9 LOT SIZE 80.000 X 120 OR 19261-1674 082000 1 F/A/U 30-6005-020-0040 COC 25775-2922 07 2006 1
3660050200050	18645 SW 100 AVE	CARLOS M BLANDON JTRSYADIRA BLANDON JTRS	733 NW 122 PL	MIAMI, FL 33182	POINT ROYALE SEC 5 PB 100-2 LOT 5 BLK 9 LOT SIZE 80.000 X 120 OR 11071-244 0481 6 F/A/U 30-6005-020-0050 COC 25846-1242/26083-0537 0707 1
3660050200060	18655 SW 100 AVE	LOUISE DANNIE TRS LOUISE DANNIF REVOCABLE TRUST	13462 SW 26 ST	MIRAMAR, FL 33027	POINT ROYALE SEC 5 PB 100-2 LOT 6 BLK 9 LOT SIZE 80.000 X 120 OR 14383-1438 1289 1 COC 23158-2370 02 2005 4 F/A/U 30-6005-020-0060
3660050200070	18665 SW 100 AVE	ELIO E MACHADO & YVONNE E MACHADO	13431 SW 98 PL	MIAMI, FL 33176-6110	POINT ROYALE SEC 5 PB 100-2 LOT 7 BLK 9 LOT SIZE 80.000 X 120 OR 16631-4384 1294 1 F/A/U 30-6005-020-0070
3660050200080	18675 SW 100 AVE	CARIDAD LOPEZ	19640 BELAIRE DR	CUTLER BAY, FL 33157	POINT ROYALE SEC 5 PB 100-2 LOT 8 BLK 9 LOT SIZE 80.000 X 120 OR 19108-0655 042000 1 F/A/U 30-6005-020-0080
3660050200090	18685 SW 100 AVE	BRYAN CHINCAROL A CHIN	13371 SW 193 TERR	MIAMI, FL 33177	POINT ROYALE SEC 5 PB 100-2 LOT 9 BLK 9 LOT SIZE 80.000 X 120 OR 16493-1710 0794 1 COC 21734-1769 09 2003 1 F/A/U 30-6005-020-0090
3660050200100	18705 SW 100 AVE	HUBERT STEPHENS	18705 SW 100 AVE	MIAMI, FL 33157	POINT ROYALE SEC 5 PB 100-2 LOT 10 BLK 9 LOT SIZE 80.000 X 120 OR 21269-2213 05/2003 4 F/A/U 30-6005-020-0100 COC 23918-4021 10 2005 1

3660050200110	18715 SW 100 AVE	DERRICK A ROBINSON & W PAULETTE J	14610 SW 80 AVE	MIAMI, FL 33158-2030	POINT ROYALE SEC 5 PB 100-2 LOT 11 BLK 9 LOT SIZE 80.000 X 120 OR 16665-1591 0195 1 F/A/U 30-6005-020-0110
3660050200120	18725 SW 100 AVE	DYNASTY PROPERTIES OF SOUTH FLORIDA LLC	16153 SW 73 PL	PALMETTO BAY, FL 33157	POINT ROYALE SEC 5 PB 100-2 LOT 12 BLK 9 LOT SIZE 78.000 X 120 OR 20401-1068 052002 1 F/A/U 30-6005-020-0120
3660050200130	18735 SW 100 AVE	PALMETTO BAY INVESTMENTS INC	7035 GLENEAGLE DR	MIAMI LAKES, FL 33014-6509	POINT ROYALE SEC 5 PB 100-2 LOT 13 BLK 9 LOT SIZE 78.000 X 120 OR 18802-1521 0999 4 F/A/U 30-6005-020-0130 OR 23551-1855 062005 1 COC 26156-0635 12 2007 4
3660050520020	18722 S DIXIE HWY	CHARAF INVESTMENT OF FL INCASSESSMENT TECHNOLOGIES LTD	121 INTERPARK BLVD STE 308	SAN ANTONIO, TX 78216-1852	POINT WEST 4TH ADDN PB 107-67 LOTS 1 THRU 4 BLK 6 LOT SIZE 101584 SQ FT FAU 36.6005.052.0020
3660050520050	18690 S DIXIE HWY	TROPICAL FINANCIAL CREDIT UNION	3050 CORPORATE WAY	MIRAMAR, FL 33025	POINT WEST 4TH ADDN PB 107-67 LOT 5 BLK 6 LOT SIZE 25453 SQ FT F/A/U 30-6005-052-0050 COC 25319-4554 01 2007 6
3660050550010	9741 SW 186 ST	LETICIA N NISHMAN	9741 SW 186 ST	MIAMI, FL 33157-6938	SECTION TWENTY-FOUR BEL-AIR PB 110-60 LOT 1 BLK 97 OR 17926-0623 1297 1 COC 23509-0459 05 2005 4 F/A/U 30-6005-055-0010
3660050550020	9731 SW 186 ST	DANILO ROSARIO	9731 SW 186 ST	MIAMI, FL 33157-6938	SECTION TWENTY-FOUR BEL-AIR PB 110-60 LOT 2 BLK 97 OR 15237-3789 1091 1 F/A/U 30-6005-055-0020
3660050550030	9721 SW 186 ST	FRANCES PUIG & ELVIN J CASCO & W YAMILETT ROMERO	9721 SW 186 ST	MIAMI, FL 33157-6938	SECTION TWENTY-FOUR BEL-AIR PB 110-60 LOT 3 BLK 97 OR 17073-1557 0196 5 F/A/U 30-6005-055-0030
3660050550040	9711 SW 186 ST	JOSE FUENTES	9711 SW 186 ST	MIAMI, FL 33157-6938	SECTION TWENTY-FOUR BEL-AIR PB 110-60 LOT 4 BLK 97 OR 19767-4209 062001 1 F/A/U 30-6005-055-0040
3660050550050	9701 SW 186 ST	PENELOPE K CARD	16705 SW 100 CT	MIAMI, FL 33157	SECTION TWENTY-FOUR BEL-AIR PB 110-60 LOT 5 BLK 97 OR 11485-2524 0682 1 F/A/U 30-6005-055-0050
3660050550060	9700 SW 185 TER	JONATHON SIMMONDS & W ROSETA E	9700 SW 185 TERR	MIAMI, FL 33157-6957	SECTION TWENTY-FOUR BEL-AIR PB 110-60 LOT 6 BLK 97 OR 20418-4745 052002 4 F/A/U 30-6005-055-0060
3660050550070	9710 SW 185 TER	NATALIE M REY	9710 SW 185 TER	CUTLER BAY, FL 33157	SECTION TWENTY-FOUR BEL-AIR PB 110-60 LOT 7 BLK 97 OR 14843-2393 1290 1 F/A/U 30-6005-055-0070
3660050550080	9720 SW 185 TER	HELEN E KLEK	9720 SW 185 TERR	MIAMI, FL 33157-6957	SECTION TWENTY-FOUR BEL-AIR PB 110-60 LOT 8 BLK 97 OR 10911-1084 1080 1 F/A/U 30-6005-055-0080
3660050550090	9730 SW 185 TER	M H NEGAHDARI & W SHOLEH	9730 SW 185 TERR	MIAMI, FL 33157-6957	SECTION TWENTY-FOUR BEL-AIR PB 110-60 LOT 9 BLK 97 OR 10615-731 1279 1 F/A/U 30-6005-055-0090
3660050550100	9740 SW 185 TER	MARIA DEL CARMEN A TITOSPEDRO BARROSO PADILLA	9740 SW 185 TER	CUTLER BAY, FL 33157	SECTION TWENTY-FOUR BEL-AIR PB 110-60 LOT 10 BLK 97 OR 11786-1697 0583 1 F/A/U 30-6005-055-0100
3660050610020	18605 S DIXIE HWY	QUAIL ROOST INVESTORS JOINT VENTURE	1501 VENERA AVENUE	MIAMI, FL 33146	QUAIL ROOST CENTER PB 115-26 LOT 2 BLK 1 LOT SIZE 221893 SQ FT OR 16770-1026 THRU 1030 0395 1 F/A/U 30-6005-061-0020
3660050610030	18601 S DIXIE HWY	CEIX CORP	3370 MARY ST	MIAMI, FL 33133	QUAIL ROOST CENTER PB 115-26 LOT 3 BLK 1 LOT SIZE 50312 SQ FT OR 19128-3009 0500 4 F/A/U 30-6005-061-0030 COC 25936-0400 07 2007 5
3660050620010	18670 S DIXIE HWY	CHARAF INVESTMENT OF FL INC	6095 NW 167 ST # D-8	MIAMI, FL 33015-4313	POINT WEST 7TH ADDN PB 116-56 LOT 10 BLK 6 LOT SIZE 35942 SQ FT COC 21950-0063 12 2003 2 F/A/U 30-6005-062-0010
3660050670010	18403 S DIXIE HWY	SOUTH DADE SHOPPING LLC/O PRINCIPAL. REAL EST INVESTORS	801 GRAND AVE	DES MOINES, IA 50392	SOUTH DADE SHOPPING CENTER PB 123-68 TR A LESS COMM AT MOST SWLY COR OF TR A TH N 20 DEG E 110.22FT S 69 DEG E 11.97FT FOR POB TH N 20 DEG E 234.04FT S 69 DEG E 174.67FT S 20 DEG W 233.82FT N 69 DEG W 174.67FT TO POB LOT SIZE 27.274 AC F/A/U 30-6005-067-
3660050670011	18591 S DIXIE HWY	SOUTH DADE TWO LLC	5301 N FEDERAL HWY 350	BOCA RATON, FL 33487	SOUTH DADE SHOPPING CENTER PB 123-68 PORT OF TR A DESC COMM AT MOST SWLY COR TR A TH N 20 DEG E 110.22FTS 69 DEG E 11.97FT FOR POB TH N 20 DEG E 234.04FT S 69 DEG E 174.67FT S 20 DEG W 233.82FT N 69 DEG W 174.67FT TO POB LOT SIZE 40861 SQ FT FAU 30 6005
3660050860001		REFERENCE ONLY			ROYALE POINT-TOWNVILLAS CONDO POINT ROYALE SEC 5 PB 100-2 LOT 1 THRU 17 BLK 10 LOT SIZE 4.01 AC AS DESC IN DECL OR 18896-401 F/A/U 30-6005-020-0200 THRU 0360 F/A/U 30-6005-086-0001
3660050860010	18612 SW 100 AVE 18612	EDGAR J REGIDOR TRSREGIDOR FAMILY LIVING TR	1023 NW 134 PL	MIAMI, FL 33182	ROYALE POINT-TOWNVILLAS CONDO PH UNIT 18612 UNDIV 1/68% INT IN COMMON ELEMENTS OFF REC 18896-401 OR 18935-1904 1299 1 COC 21341-0213 03 2003 1 F/A/U 30-6005-086-0010
3660050860020	18614 SW 100 AVE 18614	VICTOR MORALES & GRACE HERNANDEZ	18614 SW 100 AVE	MIAMI, FL 33157-6904	ROYALE POINT-TOWNVILLAS CONDO PH UNIT 18614 UNDIV 1/68% INT IN COMMON ELEMENTS OFF REC 18896-401 OR 18935-1719 1299 1 F/A/U 30-6005-086-0020
3660050860030	18616 SW 100 AVE 18616	U S BANK N A TRSC/O RUSHMORE LOAN MGMT SERV LLC	1755 WITTINGTON PL 400	DALLAS CENTER, TX 75234	ROYALE POINT-TOWNVILLAS CONDO PH UNIT 18616 UNDIV 1/68% INT IN COMMON ELEMENTS OFF REC 18896-401 OR 18935-1506 19440/2628 1299 1 F/A/U 30-6005-086-0030
3660050860040	18618 SW 100 AVE 18618	DEL ESTE LLC	3500 MYSTIC POINTE DR # 401	MIAMI, FL 33180	ROYALE POINT-TOWNVILLAS CONDO PH UNIT 18618 UNDIV 1/68% INT IN COMMON ELEMENTS OFF REC 18896-401 OR 19014-4422 19407-3911 0101 1 F/A/U 30-6005-086-0040
3660050860050	18622 SW 100 AVE 18622	DYANNE DARRY	18622 SW 100 AVE	MIAMI, FL 33157-6904	ROYALE POINT-TOWNVILLAS CONDO PH UNIT 18622 UNDIV 1/68% INT IN COMMON ELEMENTS OFF REC 18896-401 F/A/U 30-6005-089-0050 OR 18946-3271/24438-4677 0100 150
3660050860060	18624 SW 100 AVE 18624	CLARICE ALMEIDA LEREM SEBASTIAO MENDES	16421 SW 54 TER	MIAMI, FL 33185	ROYALE POINT-TOWNVILLAS CONDO PH UNIT 18624 UNDIV 1/68% INT IN COMMON ELEMENTS OFF REC 18896-401 OR 18975-2761 0100 1 F/A/U 30-6005-086-0060 COC 23812-0066 09 2005 5
3660050860070	18626 SW 100 AVE 18626	HORACIO J ORTIZ	18626 SW 100 AVE #18626	CUTLER BAY, FL 33157	ROYALE POINT-TOWNVILLAS CONDO PH UNIT 18626 UNDIV 1/68% INT IN COMMON ELEMENTS OFF REC 18896-401 COC 23365 3858 05 2005 1 F/A/U 30-6005-086-0070 COC 24557-1775 05 2006 1
3660050860080	18628 SW 100 AVE 18628	EDGAR J REGIDOR TRSREGIDOR FAMILY LIVING TRUST	1023 NW 134 PL	MIAMI, FL 33182	ROYALE POINT-TOWNVILLAS CONDO PH UNIT 18628 UNDIV 1/68% INT IN COMMON ELEMENTS OFF REC 18896-401 OR 20972-3092 01 2003 1 COC 21883-2197 11 2003 1 F/A/U 30-6005-086-0080



3660050860090	18632 SW 100 AVE 18632	A & R PROPERTY MANAGEMENT OF SOUTH FLORIDA LLC	15815 SW 102 PL	MIAMI, FL 33157	ROYALE POINT-TOWNVILLAS CONDO PHI UNIT 18632 UNDIV 1/68% INT IN COMMON ELEMENTS OFF REC 18896-401 OR 18975-2787 0100 1 F/A/U 30-6005-086-0090
3660050860100	18634 SW 100 AVE 18634	JASON O HUTCHINGS & JANELLE H & JANICE H BOYCE HUTCHINGS	18634 SW 100 AVE #18634	MIAMI, FL 33157-6904	ROYALE POINT-TOWNVILLAS CONDO PHI UNIT 18634 UNDIV 1/68% INT IN COMMON ELEMENTS OFF REC 18896-401 OR 18995-716 0200 1 F/A/U 30-6005-086-0100
3660050860110	18636 SW 100 AVE 18636	JERLENE JOSEPH TRS	11000 MARIN ST	CORAL GABLES, FL 33156-4228	ROYALE POINT-TOWNVILLAS CONDO PHI UNIT 18636 UNDIV 1/68% INT IN COMMON ELEMENTS OFF REC 18896-401 OR 18946-3310 0100 1 F/A/U 30-6005-086-0110
3660050860120	18638 SW 100 AVE 18638	FRANCISCO AVILA MARIA E AVILA	15820 SW 106 TER	CUTLER BAY, FL 33196	ROYALE POINT-TOWNVILLAS CONDO PHI UNIT 18638 UNDIV 1/68% INT IN COMMON ELEMENTS OFF REC 18896-401 OR 21045-1165 12 2002 1 F/A/U 30-6005-086-0120
3660050860130	18642 SW 100 AVE 18642	SHEARIYN DENISE JACOBS	18642 SW 100 AVE 18642	MIAMI, FL 33157-6939	ROYALE POINT-TOWNVILLAS CONDO PHI UNIT 18642 UNDIV 1/68% INT IN COMMON ELEMENTS OFF REC 18896-401 OR 18975-2920 0200 1 F/A/U 30-6005-086-0130
3660050860140	18644 SW 100 AVE 18644	ZHIFU YOUHAIYAN JIANG	8340 SW 166	PALMETTO BAY, FL 33157	ROYALE POINT-TOWNVILLAS CONDO PHI UNIT 18644 UNDIV 1/68% INT IN COMMON ELEMENTS OFF REC 18896-401 OR 18971-344 0100 1 F/A/U 30-6005-086-0140
3660050860150	18646 SW 100 AVE 18646	ROBERT BRUNY	18646 SW 100 AVE #0	MIAMI, FL 33137	ROYALE POINT-TOWNVILLAS CONDO PHI UNIT 18646 UNDIV 1/68% INT IN COMMON ELEMENTS OFF REC 18896-401 OR 19075-4019 0400 1 F/A/U 30-6005-086-0150
3660050860160	18648 SW 100 AVE 18648	CARLINE D BARNES	23955 SW 114 CT	HOMESTEAD, FL 33032	ROYALE POINT-TOWNVILLAS CONDO PHI UNIT 18648 UNDIV 1/68% INT IN COMMON ELEMENTS OFF REC 18896-401 OR 18946-3377 0100 1 F/A/U 30-6005-086-0160
3660050860170	18652 SW 100 AVE 18652	DWIGHT A & JOAN H JOHNSON	18652 SW 100 AVE	MIAMI, FL 33157-6939	ROYALE POINT-TOWNVILLAS CONDO UNIT 18652 UNDIV 1/68 INT IN COMMON ELEMENTS OFF REC 18896-401 OR 19327-4783 1000 1 F/A/U 30-6005-086-0170
3660050860180	18654 SW 100 AVE 18654	VIELKA DEL CARMEN OTERO	18654 SW 100 AVE	MIAMI, FL 33157-6939	ROYALE POINT-TOWNVILLAS CONDO UNIT 18654 UNDIV 1/68 INT IN COMMON ELEMENTS OFF REC 18896-401 OR 19489-4417 0101 1 F/A/U 30-6005-086-0180
3660050860190	18656 SW 100 AVE 18656	MARIA ELENA AVILA FRANCISCO AVILA	15820 SW 106 TER	MIAMI, FL 33196	ROYALE POINT-TOWNVILLAS CONDO UNIT 18656 UNDIV 1/68 INT IN COMMON ELEMENTS OFF REC 18896-401 OR 19357-4454 1100 1 COC 22266-4225 04 2004 1 F/A/U 30-6005-086-0190
3660050860200	18658 SW 100 AVE 18658	SENEN CORTIZA	18658 SW 100 AVENUE #18658	MIAMI, FL 33157	ROYALE POINT-TOWNVILLAS CONDO UNIT 18658 UNDIV 1/68 INT IN COMMON ELEMENTS OFF REC 18896-401 OR 19316-2610 1000 1 F/A/U 30-6005-086-0200
3660050860210	18662 SW 100 AVE 18662	FELIPE LOPERAMADELYN LOPERA	1420 SW 101 AVE	MIAMI, FL 33157	ROYALE POINT-TOWNVILLAS CONDO UNIT 18662 UNDIV 1/68 INT IN COMMON ELEMENTS OFF REC 18896-401 OR 19392-0206 1100 1 COC 22812-1902 10 2004 4 F/A/U 30-6005-086-0210
3660050860220	18664 SW 100 AVE 18664	PRUDENCE D MALLARY	18664 SW 100 AVE	MIAMI, FL 33157-6939	ROYALE POINT-TOWNVILLAS CONDO UNIT 18664 UNDIV 1/68 INT IN COMMON ELEMENTS OFF REC 18896-401 OR 19316-2433 1000 1 F/A/U 30-6005-086-0220
3660050860230	18666 SW 100 AVE 18666	YOISIS PEVIDA	18666 SW 100 AVE	MIAMI, FL 33157	ROYALE POINT-TOWNVILLAS CONDO UNIT 18666 UNDIV 1/68 INT IN COMMON ELEMENTS OFF REC 18896-401 OR 20680-1030 0702 1 COC 21933-4142 12 2003 4 F/A/U 30-6005-086-0230
3660050860240	18668 SW 100 AVE 18668	LUCELLY CORREA	18668 SW 100 AVE	MIAMI, FL 33157-6939	ROYALE POINT-TOWNVILLAS CONDO UNIT 18668 UNDIV 1/68 INT IN COMMON ELEMENTS OFF REC 18896-401 OR 19327-4959 1000 1 F/A/U 30-6005-086-0240
3660050860250	18672 SW 100 AVE 18672	AUSTRY GALVAN	12915 SW 286TH ST	HOMESTEAD, FL 33033-7459	ROYALE POINT-TOWNVILLAS CONDO UNIT 18672 UNDIV 1/68 INT IN COMMON ELEMENTS OFF REC 18896-401 OR 20839-0736 1102 1 F/A/U 30-6005-086-0250
3660050860260	18674 SW 100 AVE 18674	THE ISLANDER BA CORP	10305 NW 41 ST UNIT 219	DORAL, FL 33178	ROYALE POINT-TOWNVILLAS CONDO UNIT 18674 UNDIV 1/68 INT IN COMMON ELEMENTS OFF REC 18896-401 OR 20744-4112 0902 1 F/A/U 30-6005-086-0260
3660050860270	18676 SW 100 AVE 18676	ROYALE POINT TOWNVILLAS CONDOC/O MIRZA BASULTO & ROBBINS LLP	14160 NW 77 CT STE 22	MIAMI LAKES, FL 33016	MARRIAGE CT: SHANNON 04 2005 5
3660050860280	18678 SW 100 AVE 18678	MAYRA T & JORGE L BORGES JR	18678 SW 100 AVE #18678	MIAMI, FL 33157-6939	ROYALE POINT-TOWNVILLAS CONDO UNIT 18676 UNDIV 1/68 INT IN COMMON ELEMENTS OFF REC 18896-401 OR 19610-152 0301 1 F/A/U 30-6005-086-0270
3660050860290	18682 SW 100 AVE 18682	STEVEN A BARIMODIANA BARIMO	15645 SW 146 AVE	MIAMI, FL 33177	ROYALE POINT-TOWNVILLAS CONDO UNIT 18678 UNDIV 1/68 INT IN COMMON ELEMENTS OFF REC 18896-401 OR 20907-2500 1202 1 F/A/U 30-6005-086-0280
3660050860300	18684 SW 100 AVE 18684	ISADORE P INGRAM	18684 SW 100 AVE	MIAMI, FL 33157-6940	ROYALE POINT-TOWNVILLAS CONDO UNIT 18682 UNDIV 1/68 INT IN COMMON ELEMENTS OFF REC 18896-401 OR 19729-4189 0601 1 F/A/U 30-6005-086-0290
3660050860310	18686 SW 100 AVE 18686	WALTER J BLACKSHIRE	18686 SW 100 AVE	MIAMI, FL 33157-6940	ROYALE POINT-TOWNVILLAS CONDO UNIT 18684 UNDIV 1/68 INT IN COMMON ELEMENTS OFF REC 18896-401 OR 19316-2479 0900 1 F/A/U 30-6005-086-0300
3660050860320	18688 SW 100 AVE 18688	JULIO PADILLAANA GIRALDO	18688 SW 100 AVE #18688	MIAMI, FL 33157	ROYALE POINT-TOWNVILLAS CONDO UNIT 18686 UNDIV 1/68 INT IN COMMON ELEMENTS OFF REC 18896-401 OR 19316-2530 0900 1 F/A/U 30-6005-086-0310
					ROYALE POINT-TOWNVILLAS CONDO UNIT 18688 UNDIV 1/68 INT IN COMMON ELEMENTS OFF REC 18896-401 COC 22095-2124 12 2003 1 F/A/U 30-6005-086-0320 COC 26516-0319 07 2008 3

3660050860330	18702 SW 100 AVE 18702	BERNER DUARTE	18702 SW 100 AVE	MIAMI, FL 33157-6906	ROYALE POINT-TOWNVILLAS CONDO UNIT 18702 UNDIV 1/68% INT IN COMMON ELEMENTS OFF REC 18896-401 OR 20017-4087 1101 1 COC 21955-0218 12 2003 1 F/A/U 30-6005-086-0330
3660050860340	18704 SW 100 AVE 18704	TIFFANY S WHEELER	18704 SW 100 AVE	MIAMI, FL 33157	ROYALE POINT-TOWNVILLAS CONDO UNIT 18704 UNDIV 1/68% INT IN COMMON ELEMENTS OFF REC 18896-401 OR 19550-3178 03 2001 1 F/A/U 30-6005-086-0340 COC 24651-3356 06 2006 1
3660050860350	18706 SW 100 AVE 18706	ROBERT BRUNY	21223 SW 128 PL	MIAMI, FL 33177	ROYALE POINT-TOWNVILLAS CONDO UNIT 18706 UNDIV 1/68% INT IN COMMON ELEMENTS OFF REC 18896-401 OR 20603-1167 0802 1 F/A/U 30-6005-086-0350
3660050860360	18708 SW 100 AVE 18708	PEDRO A HERNANDEZ &W JANET	18708 SW 100 AVE	MIAMI, FL 33157-6906	ROYALE POINT-TOWNVILLAS CONDO UNIT 18708 UNDIV 1/68% INT IN COMMON ELEMENTS OFF REC 18896-401 OR 21127-1266 0303 1 COC 23766-3866 08 2005 1 F/A/U 30-6005-086-0360 COC 24944-1837 09 2006 1
3660050860370	18712 SW 100 AVE 18712	JORGE F GONZALEZ	6631 SW 107 PL	MIAMI, FL 33173	ROYALE POINT-TOWNVILLAS CONDO UNIT 18712 UNDIV 1/68% INT IN COMMON ELEMENTS OFF REC 18896-401 COC 23065-3022 01/05 4/23065-3023 F/A/U 30-6005-086-0370
3660050860380	18714 SW 100 AVE 18714	VALRIE CAMPBELL	18714 SW 100 AVE #18714	MIAMI, FL 33157-6906	ROYALE POINT-TOWNVILLAS CONDO UNIT 18714 UNDIV 1/68% INT IN COMMON ELEMENTS OFF REC 18896-401 OR 20862-2846 1202 1 COC 22419-3169 06 2004 1 F/A/U 30-6005-086-0380
3660050860390	18716 SW 100 AVE 18716	GEORGE HEFTYNICOLLETTA HEFTY	7860 SW 180 TER	MIAMI, FL 33157	ROYALE POINT-TOWNVILLAS CONDO UNIT 18716 UNDIV 1/68% INT IN COMMON ELEMENTS OFF REC 18896-401 OR 20764-1297 102002 1 F/A/U 30-6005-086-0390 COC 24868-2121 08 2006 1
3660050860400	18718 SW 100 AVE 18718	JULJO SILVA	18718 SW 100 AVE #18718	MIAMI, FL 33157-6906	ROYALE POINT-TOWNVILLAS CONDO UNIT 18718 UNDIV 1/68% INT IN COMMON ELEMENTS OFF REC 18896-401 OR 19550-3194 03 2001 1 COC 22930-2256 12 2004 1 F/A/U 30-6005-086-0400
3660050860410	18722 SW 100 AVE 18722	REYNIER REMY ANDINO	18722 SW 100 AVE	MIAMI, FL 33157	ROYALE POINT-TOWNVILLAS CONDO UNIT 18722 UNDIV 1/68% INT IN COMMON ELEMENTS OFF REC 18896-401 OR 19743-4355 0601 1 F/A/U 30-6005-086-0410 COC 26071-1102 11 2007 1
3660050860420	18724 SW 100 AVE 18724	EDGAR J REGIDOR TRSREGIDOR FAMILY LIVING TRUST	1023 NW 134 PL	MIAMI, FL 33182	ROYALE POINT-TOWNVILLAS CONDO UNIT 18724 UNDIV 1/68% INT IN COMMON ELEMENTS OFF REC 18896-401 OR 20726-2922 10/2002 1 F/A/U 30-6005-086-0420
3660050860430	18726 SW 100 AVE 18726	MARIANO LOPEZ &W MARIA M BAEZ	18726 SW 100 AVE	MIAMI, FL 33157-6906	ROYALE POINT-TOWNVILLAS CONDO UNIT 18726 UNDIV 1/68% INT IN COMMON ELEMENTS OFF REC 18896-401 OR 20203-4439 01 2002 1 F/A/U 30-6005-086-0430
3660050860440	18728 SW 100 AVE 18728	ELIDA S VELAZQUEZ	18728 SW 100 AVE	MIAMI, FL 33157-6906	ROYALE POINT-TOWNVILLAS CONDO UNIT 18728 UNDIV 1/68% INT IN COMMON ELEMENTS OFF REC 18896-401 OR 19745-1 0601 1 F/A/U 30-6005-086-0440
3660050860450	18732 SW 100 AVE 18732	ARMENIO DA SILVA &W MARIA	18732 SW 100 AVE	MIAMI, FL 33157-6984	ROYALE POINT-TOWNVILLAS CONDO UNIT 18732 UNDIV 1/68% INT IN COMMON ELEMENTS OFF REC 18896-401 OR 19748-2471 0601 1 F/A/U 30-6005-086-0450
3660050860460	18734 SW 100 AVE 18734	FRANCISCO AVILAMARIA E AVILA	15820 SW 106 TER	MIAMI, FL 33196	ROYALE POINT-TOWNVILLAS CONDO UNIT 18734 UNDIV 1/68% INT IN COMMON ELEMENTS OFF REC 18896-401 OR 20938-3280 1202 1 F/A/U 30-6005-086-0460
3660050860470	18736 SW 100 AVE 18736	MIRIAM GOMEZ	18736 SW 100 AVE	CUTLER BAY, FL 33157	ROYALE POINT-TOWNVILLAS CONDO UNIT 18736 UNDIV 1/68% INT IN COMMON ELEMENTS OFF REC 18896-401 OR 19861-3470 08 2001 1 COC 22462-3872 06 2004 1 F/A/U 30-6005-086-0470 COC 24211-2866 12 2005 5
3660050860480	18738 SW 100 AVE 18738	GILBERTO SOSA &W BEATRIZ TASCON	18738 SW 100 AVE	MIAMI, FL 33157-6984	ROYALE POINT-TOWNVILLAS CONDO UNIT 18738 UNDIV 1/68% INT IN COMMON ELEMENTS OFF REC 18896-401 OR 19745-64 0601 1 COC 22027-0/12 01 2004 1 F/A/U 30-6005-086-0480 COC 26054-3865 11 2007 5
3660050860490	18742 SW 100 AVE 18742	KELWYN S LOVE	18742 SW 100 AVE	MIAMI, FL 33157-6984	ROYALE POINT-TOWNVILLAS CONDO UNIT 18742 UNDIV 1/68% INT IN COMMON ELEMENTS OFF REC 18896-401 OR 20203-4464 0202 1 F/A/U 30-6005-086-0490
3660050860500	18744 SW 100 AVE 18744	MADELINE VILA	18744 SW 100 AVE #18744	MIAMI, FL 33157-6984	ROYALE POINT-TOWNVILLAS CONDO UNIT 18744 UNDIV 1/68% INT IN COMMON ELEMENTS OFF REC 18896-401 OR 20315-2350 0302 1 F/A/U 30-6005-086-0500
3660050860510	18746 SW 100 AVE 18746	OSCAR R REGIDORFRANCISCA Y REGIDOR	18746 SW 100 AVE #18746	MIAMI, FL 33157-6984	ROYALE POINT-TOWNVILLAS CONDO UNIT 18746 UNDIV 1/68% INT IN COMMON ELEMENTS OFF REC 18896-401 OR 20380-4424 04/02 1 COC 21826-2535 03 2003 4 F/A/U 30-6005-086-0510
3660050860520	18748 SW 100 AVE 18748	JAKEISHA D THOMPSON	850 N MIAMI AVE #309W	MIAMI, FL 33136	ROYALE POINT-TOWNVILLAS CONDO UNIT 18748 UNDIV 1/68% INT IN COMMON ELEMENTS OFF REC 18896-401 OR 20146-3019 01 2002 1 COC 23678-3082 08 2005 1 F/A/U 30-6005-086-0520
3660050860530	18752 SW 100 AVE 18752	DAVID E ROMAN &W MYRTA	18752 SW 100AVE #18752	MIAMI, FL 33157-6984	ROYALE POINT-TOWNVILLAS CONDO UNIT 18752 UNDIV 1/68% INT IN COMMON ELEMENTS OFF REC 18896-401 OR 20872-4880 12-2002 1 F/A/U 30-6005-086-0530
3660050860540	18754 SW 100 AVE 18754	JAVIER J CANALES &W CAROLINE E	18754 SW 100 AVE	MIAMI, FL 33157-6984	ROYALE POINT-TOWNVILLAS CONDO UNIT 18754 UNDIV 1/68% INT IN COMMON ELEMENTS OFF REC 18896-401 OR 20264-1900 0302 1 F/A/U 30-6005-086-0540
3660050860550	18756 SW 100 AVE 18756	GENE SPENCER JR	18756 SW 100 AVE #18756	CUTLER BAY, FL 33157-6984	ROYALE POINT-TOWNVILLAS CONDO UNIT 18756 UNDIV 1/68% INT IN COMMON ELEMENTS OFF REC 18896-401 OR 20134-0017 01 2002 1 COC 22462-1148 07 2004 1 F/A/U 30-6005-086-0550 COC 24871-0006 0806 1
3660050860560	18758 SW 100 AVE 18758	STEPHEN POLLOCK	18758 SW 100 AVE	MIAMI, FL 33157	ROYALE POINT-TOWNVILLAS CONDO UNIT 18758 UNDIV 1/68% INT IN COMMON ELEMENTS OFF REC 18896-401 OR 20164-3599 01 2002 1 F/A/U 30-6005-086-0560



3660050860570	18762 SW 100 AVE 18762	VEDADO PLAZA MANAGEMENT LLC	3671 SW 139 CT	MIAMI, FL 33175	ROYALE POINT-TOWNVILLAS CONDO UNIT 18762 UNDIV 1/68% INT IN COMMON ELEMENTS OFF REC 18896-401 OR 20146-2712 01 2002 1 F/A/U 30-6005-086-0570 COC 25265-1974 12 2006 1
3660050860580	18764 SW 100 AVE 18764	ROGER B ZARATE & ELIZABETH ZARATE	18764 SW 100 AVE #18764	MIAMI, FL 33157-6985	ROYALE POINT-TOWNVILLAS CONDO UNIT 18764 UNDIV 1/68% INT IN COMMON ELEMENTS OFF REC 18896-401 OR 20146-2638 01 2002 1 COC 21583-3614 08 2003 1 F/A/U 30-6005-086-0580
3660050860590	18766 SW 100 AVE 18766	HILDA COUTO PRADAPNB 719 #1353 LUIS VIGOREAUX AVE	GARDEN HILLS PLAZA	GUAYNABO, PR 00966	ROYALE POINT-TOWNVILLAS CONDO UNIT 18766 UNDIV 1/68% INT IN COMMON ELEMENTS OFF REC 18896-401 OR 20371-1322 04 2002 1 COC 22280-4716 04 2004 1 F/A/U 30-6005-086-0590
3660050860600	18768 SW 100 AVE 18768	DYNASTY PROPERTIES OF SOUTHFLORIDA LLC	13500 SW 88 ST STE 131	MIAMI, FL 33186	ROYALE POINT-TOWNVILLAS CONDO UNIT 18768 UNDIV 1/68% INT IN COMMON ELEMENTS OFF REC 18896-401 OR 20971-4265 0103 1 COC 22777-0770 10 2004 1 F/A/U 30-6005-086-0600
3660050860610	18772 SW 100 AVE 18772	LACAN LLC	4611 S UNIVERSITY DR #219	DAVIE, FL 33328	ROYALE POINT-TOWNVILLAS CONDO UNIT 18772 UNDIV 1/68% INT IN COMMON ELEMENTS OFF REC 18896-401 OR 20371-1671 04 2002 1 F/A/U 30-6005-086-0610
3660050860620	18774 SW 100 AVE 18774	FELIPE LOPERAMADELYN LOPERA	1420 SW 101 AVE	MIAMI, FL 33174	ROYALE POINT-TOWNVILLAS CONDO UNIT 18774 UNDIV 1/68% INT IN COMMON ELEMENTS OFF REC 18896-401 OR 20240-1088 0202 1 F/A/U 30-6005-086-0620
3660050860630	18776 SW 100 AVE 18776	SURUSH RAMPERSAD	18776 SW 100 AVE	CUTLER BAY, FL 33157	ROYALE POINT-TOWNVILLAS CONDO UNIT 18776 UNDIV 1/68% INT IN COMMON ELEMENTS OFF REC 18896-401 OR 20234-3336 0202 1 COC 22117-2329 02 2004 1 F/A/U 30-6005-086-0630
3660050860640	18778 SW 100 AVE 18778	FREDERICK S BROWN & W MAXINE A	18778 SW 100 AVE	MIAMI, FL 33157-6985	ROYALE POINT-TOWNVILLAS CONDO UNIT 18778 UNDIV 1/68% INT IN COMMON ELEMENTS OFF REC 18896-401 OR 20240-1003 0202 1 F/A/U 30-6005-086-0640
3660050860650	18602 SW 100 AVE 18602	TC INVESTMENTS GROUP LLC	18999 BISCAYNE BLVD #205	AVENTURA, FL 33180	ROYALE POINT-TOWNVILLAS CONDO UNIT 18602 UNDIV 1/68% INT IN COMMON ELEMENTS OFF REC 18896-401 OR 20041-4682 10 2001 1 F/A/U 30-6005-086-0650 COC 25528-4562 04 2007 1
3660050860660	18604 SW 100 AVE 18604	TATIANA LOPEZ	3615 SW 142 CT	MIAMI, FL 33175	ROYALE POINT-TOWNVILLAS CONDO UNIT 18604 UNDIV 1/68% INT IN COMMON ELEMENTS OFF REC 18896-401 OR 20109-2469 12 2001 1 COC 22707-0678 09 2004 1 F/A/U 30-6005-086-0660
3660050860670	18606 SW 100 AVE 18606	ROBERT BRUNY	18606 SW 100 AVE	MIAMI, FL 33157-6904	ROYALE POINT-TOWNVILLAS CONDO UNIT 18606 UNDIV 1/68% INT IN COMMON ELEMENTS OFF REC 18896-401 OR 20824-2096 11 2002 1 F/A/U 30-6005-086-0670
3660050860680	18608 SW 100 AVE 18608	ARMANDO NAVARRO & W MARIA P	18608 SW 100 AVE	MIAMI, FL 33157-6904	ROYALE POINT-TOWNVILLAS CONDO UNIT 18608 UNDIV 1/68% INT IN COMMON ELEMENTS OFF REC 18896-401 OR 19969-4730 10 2001 1 F/A/U 30-6005-086-0680
3660050970010	9760 SW 185 TER	HUBERT C STEPHENS	9760 SW 185 TERR	MIAMI, FL 33157	MIXED PLACE PB 164-22 T-21747 LOT 1 BLK 1 LOT SIZE 8910 SF FAU 36-6005-055-0110 OR 19290-2038 09/2000 2 (7) COC 24588-0001 05 2006 1
3660050970020	18530 SW 97 PL	CHRISTOPHER BENITEZAMANDA I DE CUN	18530 SW 97 PL	CUTLER BAY, FL 33157	MIXED PLACE PB 164-22 T-21747 LOT 2 BLK 1 LOT SIZE 6142 SF FAU 36-6005-055-0110 OR 19290-2038 09/2000 2 (7)
3660050970030	18560 SW 97 PL	PAULINE RICHARD & W DORREL	18560 SW 97 PL	MIAMI, FL 33157-6908	MIXED PLACE PB 164-22 T-21747 LOT 3 BLK 1 LOT SIZE 6142 SF FAU 36-6005-055-0110 COC 24672-4329 06 2006 1
3660050970040	18590 SW 97 PL	EDUARD RIMAR CARDENAS MARIA ZOILA CARDENAS	18590 SW 97 PL	CUTLER BAY, FL 33157	MIXED PLACE PB 164-22 T-21747 LOT 4 BLK 1 LOT SIZE 7539 SF FAU 36-6005-055-0110 OR 19290-2038 09/2000 2 (7) COC 25967-2238 09 2007 1
3660050970050	18529 SW 97 PL	LUIS ERNESTO LOPEZ	18529 SW 97 PL	MIAMI, FL 33189	MIXED PLACE PB 164-22 T-21747 LOT 1 BLK 2 LOT SIZE 7404 SF FAU 36-6005-055-0110 OR 19290-2038 09/2000 2 (7) COC 25718-0846 06 2007 1
3660050970060	18559 SW 97 PL	ALEXANDER ALVAREZ JTRSSANDRA LEYVA JTRS	18559 SW 97 PLACE	CUTLER BAY, FL 33157	MIXED PLACE PB 164-22 T-21747 LOT 2 BLK 2 LOT SIZE 7749 SF FAU 36-6005-055-0110 OR 19290-2038 09/2000 2 (7) COC 24980-2146 10 2006 1
3660050970070	18589 SW 97 PL	GUILLERMO DECUN	12721 SW 99 AVE	MIAMI, FL 33176-4920	MIXED PLACE PB 164-22 T-21747 LOT 3 BLK 2 LOT SIZE 7313 SF FAU 36-6005-055-0110 OR 19290-2038 09/2000 2 (7)
3660050980001		REFERENCE ONLY			VILLAS AT CUTLER BAY CONDO 5 56 40 SUB OF PB 1-4 BEG AT NW COR LOT 1 TH S306FT E337FT N329FT W337FT TO POB LESS N40FT FOR R/W AS DFSC IN DECL OR 24457-2421 LOT SIZE: 94960 SQ FT FAU 36 6005 001 0030
3660050980010	9760 SW 184 ST A1	DONALD DE ANGELIS	8030 SW 62 PL	MIAMI, FL 33143	VILLAS AT CUTLER BAY CONDO UNIT A1 UNDIV 0.0196% INT IN COMMON ELEMENTS OFF REC 24457-2421 OR 24248-2011 0206 2
3660050980020	9760 SW 184 ST A2	ORLANDO ALVAREZ	9760 SW 184 ST SUITE A2	CUTLER BAY, FL 33157	VILLAS AT CUTLER BAY CONDO UNIT A2 UNDIV 0.0224% INT IN COMMON ELEMENTS OFF REC 24457-2421 OR 24248-2011 0206 2 COC 25908-0819 08 2007 1
3660050980030	9760 SW 184 ST A3	JOCHIE L LLC	8004 NW 154 ST #208	MIAMI LAKES, FL 33016	VILLAS AT CUTLER BAY CONDO UNIT A3 UNDIV 0.0224% INT IN COMMON ELEMENTS OFF REC 24457-2421 OR 24248-2011 0206 2 COC 25093-2682 10 2006 1
3660050980040	9760 SW 184 ST A4	CUTLER LLC TRS184ST 02 2017 LAND TRUST	12227 SW 131 AVE	CUTLER BAY, FL 33186	VILLAS AT CUTLER BAY CONDO UNIT A4 UNDIV 0.0253% INT IN COMMON ELEMENTS OFF REC 24457-2421 OR 24248-2011 0206 2 COC 25089-3397 10 2006 1
3660050980050	9760 SW 184 ST A5	DONALD DE ANGELIS	9760 SW 184 ST A5	CUTLER BAY, FL 33157	VILLAS AT CUTLER BAY CONDO UNIT A5 UNDIV 0.0224% INT IN COMMON ELEMENTS OFF REC 24457-2421 OR 24248-2011 0206 2 COC 26399-2397 05 2008 1
3660050980060	9760 SW 184 ST A6	HORA LIBRE LLC	2801 NE 208 TERR #2FL	AVENTURA, FL 33180	VILLAS AT CUTLER BAY CONDO UNIT A6 UNDIV 0.0197% INT IN COMMON ELEMENTS OFF REC 24457-2421 OR 24248-2011 0206 2
3660050980070	9760 SW 184 ST A7	LAMBDA SERVICES LLC	15364 SW 151 TER	MIAMI, FL 33196	VILLAS AT CUTLER BAY CONDO UNIT A7 UNDIV 0.0202% INT IN COMMON ELEMENTS OFF REC 24457-2421 OR 24248-2011 0206 2
3660050980080	9760 SW 184 ST A8	SUN INVEST LLC	4980 NW 165 ST #A15	HALEAH, FL 33014	VILLAS AT CUTLER BAY CONDO UNIT A8 UNDIV 0.0202% INT IN COMMON ELEMENTS OFF REC 24457-2421 OR 24248-2011 0206 2

3660050980090	9760 SW 184 ST A9	DONALD DEANGELIS	8030 SW 62 PL	MIAMI, FL 33143	VILLAS AT CUTLER BAY CONDO UNIT A9 UNDIV 0.0202% INT IN COMMON ELEMENTS OFF REC 24457-2421 OR 24248-2011 0206 2
3660050980100	9760 SW 184 ST A10	FOJHEZ LLC	7950 SW 195 TER	MIAMI, FL 33157	VILLAS AT CUTLER BAY CONDO UNIT A10 UNDIV 0.0202% INT IN COMMON ELEMENTS OFF REC 24457-2421 OR 24248-2011 0206 2
3660050980110	9760 SW 184 ST B1	INVERSOIRES 30 60 INC	31 SE 5 ST #515	MIAMI, FL 33131	VILLAS AT CUTLER BAY CONDO UNIT B1 UNDIV 0.0173% INT IN COMMON ELEMENTS OFF REC 24457-2421 OR 24248-2011 0206 2
3660050980120	9760 SW 184 ST B2	SKAVIO LLC	2801 NE 208 TER 2 FLOOR	AVENTURA, FL 33180	VILLAS AT CUTLER BAY CONDO UNIT B2 UNDIV 0.0216% INT IN COMMON ELEMENTS OFF REC 24457-2421 OR 24248-2011 0206 2
3660050980130	9760 SW 184 ST B3	DANISA PROPERTY HOLDINGS LLC	4229 SW 154 CT	MIAMI, FL 33185	VILLAS AT CUTLER BAY CONDO UNIT B3 UNDIV 0.0216% INT IN COMMON ELEMENTS OFF REC 24457-2421 OR 24248-2011 0206 2 COC 25607-4765 04 2007 1
3660050980140	9760 SW 184 ST B4	9760 SW 184 STREET LLC	6250 SW 43 ST	MIAMI, FL 33155	VILLAS AT CUTLER BAY CONDO UNIT B4 UNDIV 0.0216% INT IN COMMON ELEMENTS OFF REC 24457-2421 OR 24248-2011 0206 2 COC 25717-0100 06 2007 1
3660050980150	9760 SW 184 ST B5	ALFONSO BERNAL & W ANA BERNAL	9760 SW 184TH ST B5	MIAMI, FL 33157-6963	VILLAS AT CUTLER BAY CONDO UNIT B5 UNDIV 0.0216% INT IN COMMON ELEMENTS OFF REC 24457-2421 OR 24248-2011 0206 2 COC 25442-3048 02 2007 1
3660050980160	9760 SW 184 ST B6	ROBERTO VARGAS	9760 SW 184 ST #B6	MIAMI, FL 33157	VILLAS AT CUTLER BAY CONDO UNIT B6 UNDIV 0.0216% INT IN COMMON ELEMENTS OFF REC 24457-2421 OR 24248-2011 0206 2 COC 25169-3671 11 2006 1
3660050980170	9760 SW 184 ST B7	EDWARD CHARLES BAKER	9760 SW 184 ST	MIAMI, FL 33157	VILLAS AT CUTLER BAY CONDO UNIT B7 UNDIV 0.0216% INT IN COMMON ELEMENTS OFF REC 24457-2421 OR 24248-2011 0206 2 COC 25524-3158 04 2007 1
3660050980180	9760 SW 184 ST B8	SILVIA LETICIA PERDOMOYANET LJMA	9760 SW 184 ST B8	CUTLER BAY, FL 33157	VILLAS AT CUTLER BAY CONDO UNIT B8 UNDIV 0.0216% INT IN COMMON ELEMENTS OFF REC 24457-2421 OR 24248-2011 0206 2 COC 25430-3065 03 2007 1
3660050980190	9760 SW 184 ST B9	POSEIDON FLORIDA INVEST LLC	2801 NE 208 TER 2 FLR	AVENTURA, FL 33180	VILLAS AT CUTLER BAY CONDO UNIT B9 UNDIV 0.0173% INT IN COMMON ELEMENTS OFF REC 24457-2421 OR 24248-2011 0206 2
3660050980200	9760 SW 184 ST B10	JUDEXY PINAR TOLEDO	9760 SW 184 ST B10	CUTLER BAY, FL 33157	VILLAS AT CUTLER BAY CONDO UNIT B10 UNDIV 0.0202% INT IN COMMON ELEMENTS OFF REC 24457-2421 OR 24248-2011 0206 2
3660050980210	9760 SW 184 ST B11	INVERSOIRES 30 60 INC	31 SW 5 ST #515	MIAMI, FL 33131	VILLAS AT CUTLER BAY CONDO UNIT B11 UNDIV 0.0202% INT IN COMMON ELEMENTS OFF REC 24457-2421 OR 24248-2011 0206 2
3660050980220	9760 SW 184 ST B12	ARGPRODUCT LLC	2801 NE 208 TER 2 FLOOR	AVENTURA, FL 33180	VILLAS AT CUTLER BAY CONDO UNIT B12 UNDIV 0.0202% INT IN COMMON ELEMENTS OFF REC 24457-2421 OR 24248-2011 0206 2
3660050980230	9760 SW 184 ST B13	EMIL NOVAKMARIA DANIELA POGGIOLI NOVAK	790 SW 21 RD	MIAMI, FL 33129	VILLAS AT CUTLER BAY CONDO UNIT B13 UNDIV 0.0202% INT IN COMMON ELEMENTS OFF REC 24457-2421 OR 24248-2011 0206 2
3660050980240	9760 SW 184 ST B14	UP REAL ESTATE LLC	2801 NE 208 TER 2 FLR	AVENTURA, FL 33180	VILLAS AT CUTLER BAY CONDO UNIT B14 UNDIV 0.0202% INT IN COMMON ELEMENTS OFF REC 24457-2421 OR 24248-2011 0206 2
3660050980250	9760 SW 184 ST B15	MORAZ6 LLC	10853 NW 7 ST #11-38	MIAMI, FL 33172	VILLAS AT CUTLER BAY CONDO UNIT B15 UNDIV 0.0202% INT IN COMMON ELEMENTS OFF REC 24457-2421 OR 24248-2011 0206 2 COC 25786-0545 06 2007 1
3660050980260	9760 SW 184 ST B16	MILFINNIUM CAPITAL INVEST LLC	2801 NE 208 TER 2ND FLOOR	AVENTURA, FL 33180	VILLAS AT CUTLER BAY CONDO UNIT B16 UNDIV 0.0202% INT IN COMMON ELEMENTS OFF REC 24457-2421 OR 24248-2011 0206 2
3660050980270	9760 SW 184 ST B17	WIDMARCK N GARDONES	9760 SW 184 ST B17	CUTLER BAY, FL 33157	VILLAS AT CUTLER BAY CONDO UNIT B17 UNDIV 0.0134% INT IN COMMON ELEMENTS OFF REC 24457-2421 OR 24248-2011 0206 2
3660050980280	9760 SW 184 ST B18	DAVID MIDENCE	9760 SW 184 ST B18	CUTLER BAY, FL 33157	VILLAS AT CUTLER BAY CONDO UNIT B18 UNDIV 0.0113% INT IN COMMON ELEMENTS OFF REC 24457-2421 OR 24248-2011 0206 2
3660050980290	9760 SW 184 ST C1	YESID GONZALEZ & W LIGIA TORRES	9760 SW 184 ST C1	CUTLER BAY, FL 33157	VILLAS AT CUTLER BAY CONDO UNIT C1 UNDIV 0.0224% INT IN COMMON ELEMENTS OFF REC 24457-2421 OR 24248-2011 0206 2 COC 25234-0834 12 2006 1
3660050980300	9760 SW 184 ST C2	YANNETT F HERNANDEZ & AMERICA L RODRIGUEZ	9760 SW 184 ST #C2	CUTLER BAY, FL 33157-6902	VILLAS AT CUTLER BAY CONDO UNIT C2 UNDIV 0.0224% INT IN COMMON ELEMENTS OFF REC 24457-2421 OR 24248-2011 0206 2 COC 25216-2613 11 2006 1
3660050980310	9760 SW 184 ST C3	FRESIA Z ROMERO PADILLA WILLIAM M VEGA	9760 SW 184 ST #D7	CUTLER BAY, FL 33157	VILLAS AT CUTLER BAY CONDO UNIT C3 UNDIV 0.0224% INT IN COMMON ELEMENTS OFF REC 24457-2421 OR 24248-2011 0206 2 COC 25169-1956 11 2006 1
3660050980320	9760 SW 184 ST C4	CAROLE LOGAN WENZEL & ANTHONY J LOGAN JTRS	9760 SW 184 ST #C4	CUTLER BAY, FL 33157-6902	VILLAS AT CUTLER BAY CONDO UNIT C4 UNDIV 0.0237% INT IN COMMON ELEMENTS OFF REC 24457-2421 OR 24248-2011 0206 2 COC 25858-0173 07 2007 1
3660050980330	9760 SW 184 ST C5	ALP MIA LLC	290 NW 165 ST STE PHIS	MIAMI, FL 33169	VILLAS AT CUTLER BAY CONDO UNIT C5 UNDIV 0.0202% INT IN COMMON ELEMENTS OFF REC 24457-2421 OR 24248-2011 0206 2
3660050980340	9760 SW 184 ST C6	CEMAB LLC	2801 NE 208 TER 2 FLOOR	AVENTURA, FL 33180	VILLAS AT CUTLER BAY CONDO UNIT C6 UNDIV 0.0202% INT IN COMMON ELEMENTS OFF REC 24457-2421 OR 24248-2011 0206 2
3660050980350	9760 SW 184 ST C7	CEMAB LLC	2801 NE 208 TER 2 FLOOR	AVENTURA, FL 33180	VILLAS AT CUTLER BAY CONDO UNIT C7 UNDIV 0.0202% INT IN COMMON ELEMENTS OFF REC 24457-2421 OR 24248-2011 0206 2
3660050980360	9760 SW 184 ST C8	FAISAL MOHAMMED	14946 SW 34 ST	MIAMI, FL 33185	VILLAS AT CUTLER BAY CONDO UNIT C8 UNDIV 0.0202% INT IN COMMON ELEMENTS OFF REC 24457-2421 OR 24248-2011 0206 2 COC 26199-4342 01 2008 1
3660050980370	9760 SW 184 ST D1	DONALD DEANGELIS	8030 SW 62 PL	MIAMI, FL 33143	VILLAS AT CUTLER BAY CONDO UNIT D1 UNDIV 0.0154% INT IN COMMON ELEMENTS OFF REC 24457-2421 OR 24248-2011 0206 2
3660050980380	9760 SW 184 ST D2	DONALD DE ANGELIS	8030 SW 62 PL	MIAMI, FL 33143	VILLAS AT CUTLER BAY CONDO UNIT D2 UNDIV 0.0154% INT IN COMMON ELEMENTS OFF REC 24457-2421 OR 24248-2011 0206 2



3660050980390	9760 SW 184 ST D3	JOCHE A LLC	8004 NW 154 ST #208	MIAMI LAKES, FL 33016	VILLAS AT CUTLER BAY CONDO UNIT D3 UNDIV 0.0154% INT IN COMMON ELEMENTS OFF REC 24457-2421 OR 24248-2011 0206 2 COC 25102-1935 11 2006 1
3660050980400	9760 SW 184 ST D4	JOCHE L LLC	8004 NW 154 ST #208	MIAMI LAKES, FL 33016	VILLAS AT CUTLER BAY CONDO UNIT D4 UNDIV 0.0154% INT IN COMMON ELEMENTS OFF REC 24457-2421 OR 24248-2011 0206 2 COC 25139-2065 11 2006 1
3660050980410	9760 SW 184 ST D5	SUN INVEST LLC	8030 SW 62 PL	MIAMI, FL 33143	VILLAS AT CUTLER BAY CONDO UNIT D5 UNDIV 0.0154% INT IN COMMON ELEMENTS OFF REC 24457-2421 OR 24248-2011 0206 2
3660050980420	9760 SW 184 ST D6	ALP MIA LLC	290 NW 165 ST STE PH5	MIAMI, FL 33169	VILLAS AT CUTLER BAY CONDO UNIT D6 UNDIV 0.0154% INT IN COMMON ELEMENTS OFF REC 24457-2421 OR 24248-2011 0206 2
3660050980430	9760 SW 184 ST D7	FOJHEZ LLC	7950 SW 195 TER	MIAMI, FL 33157	VILLAS AT CUTLER BAY CONDO UNIT D7 UNDIV 0.0154% INT IN COMMON ELEMENTS OFF REC 24457-2421 OR 24248-2011 0206 2
3660050980440	9760 SW 184 ST D8	NEYRA 6900 LLC	8830 SW 129 TER	MIAMI, FL 33176	VILLAS AT CUTLER BAY CONDO UNIT D8 UNDIV 0.0156% INT IN COMMON ELEMENTS OFF REC 24457-2421 OR 24248-2011 0206 2
3660050980450	9760 SW 184 ST D9	ALP MIAMI LLC	290 NW 165 ST STE PH5	MIAMI, FL 33169	VILLAS AT CUTLER BAY CONDO UNIT D9 UNDIV 0.0154% INT IN COMMON ELEMENTS OFF REC 24457-2421 OR 24248-2011 0206 2
3660050980460	9760 SW 184 ST D10	DONALD DEANGELIS	8030 SW 62 PL	MIAMI, FL 33143	VILLAS AT CUTLER BAY CONDO UNIT D10 UNDIV 0.0154% INT IN COMMON ELEMENTS OFF REC 24457-2421 OR 24248-2011 0206 2
3660050980470	9760 SW 184 ST D11	DONALD DEANGELIS	8030 SW 62 PL	MIAMI, FL 33143	VILLAS AT CUTLER BAY CONDO UNIT D11 UNDIV 0.0154% INT IN COMMON ELEMENTS OFF REC 24457-2421 OR 24248-2011 0206 2
3660050980480	9760 SW 184 ST D12	ALP MIAMI LLC	290 NW 165 ST STE PH5	MIAMI, FL 33169	VILLAS AT CUTLER BAY CONDO UNIT D12 UNDIV 0.0154% INT IN COMMON ELEMENTS OFF REC 24457-2421 OR 24248-2011 0206 2
3660050980490	9760 SW 184 ST D13	POSEIDON FLORIDA INVESTMENT LLC	2801 NE 208 TER 2ND FLOOR	AVENTURA, FL 33180	VILLAS AT CUTLER BAY CONDO UNIT D13 UNDIV 0.0154% INT IN COMMON ELEMENTS OFF REC 24457-2421 OR 24248-2011 0206 2
3660050980500	9760 SW 184 ST D14	NEYRA 6900 LLC	8830 SW 129 TER	MIAMI, FL 33176	VILLAS AT CUTLER BAY CONDO UNIT D14 UNDIV 0.0154% INT IN COMMON ELEMENTS OFF REC 24457-2421 OR 24248-2011 0206 2
3660050980510	9760 SW 184 ST D15	DONALD DE ANGELIS	8030 SW 62 PL	MIAMI, FL 33143	VILLAS AT CUTLER BAY CONDO UNIT D15 UNDIV 0.0154% INT IN COMMON ELEMENTS OFF REC 24457-2421 OR 24248-2011 0206 2
3660050980520	9760 SW 184 ST D16	MHAG LLC	2801 NE 208 TER 2ND FLOOR	AVENTURA, FL 33180	VILLAS AT CUTLER BAY CONDO UNIT D16 UNDIV 0.0156% INT IN COMMON ELEMENTS OFF REC 24457-2421 OR 24248-2011 0206 2
3660050980530	9760 SW 184 ST E1	DONALD DE ANGELIS	8030 SW 62 PLACE	MIAMI, FL 33143	VILLAS AT CUTLER BAY CONDO UNIT E1 UNDIV 0.0082% INT IN COMMON ELEMENTS OFF REC 24457-2421 OR 24248-2011 0206 2
3660050980540	9760 SW 184 ST E2	SOL DEL ESTE LLC	290 NW 165 ST PH 5	MIAMI, FL 33169	VILLAS AT CUTLER BAY CONDO UNIT E2 UNDIV 0.0092% INT IN COMMON ELEMENTS OFF REC 24457-2421 OR 24248-2011 0206 2



**TOWN OF CUTLER BAY  
AFFIDAVIT OF POSTING**

On July 2, 2018, I posted a copy of the attached Notice on the following described property located at (18403 S Dixie Hwy). Photographs I took on said date of the Notice posted at location are below.

DATED THIS 2nd day of July, 2018.

Santiago Gonzalez  
(Print Name)

  
(Signature)

HEARING # V-2018-025 (a) thru (f)

HEARING DATE/TIME 7/18/2018 at 8:00 PM

APPLICANT Ross Stores Inc.

LOCATION/FOLIO # 18437 S Dixie Hwy

