



Application No.:

V-2018-019

Attachment "C"

Advertisement, Courtesy Notice, and Posting

DADE COUNTY FEDERAL CREDIT UNION

SIGN VARIANCE

A RESOLUTION OF THE MAYOR AND TOWN COUNCIL OF THE TOWN OF CUTLER BAY, FLORIDA, APPROVING A VARIANCE APPLICATION FOR DADE COUNTY FEDERAL CREDIT UNION LOCATED AT 20295 S. DIXIE HIGHWAY, TO PERMIT THREE (3) WALL SIGNS WHERE ONE (1) IS PERMITTED; AND PROVIDING FOR AN EFFECTIVE DATE.



**TOWN OF CUTLER BAY
NOTICE OF PUBLIC HEARING**

The Town of Cutler Bay will be holding a public hearing on **Wednesday, June 20, 2018 at 8:00 p.m.**, or as soon thereafter as possible, in the Town Hall Council Chambers, 10720 Caribbean Boulevard, Cutler Bay, Florida. The purpose of the public hearing(s) is to consider the adoption of the Resolution(s) described below:

A RESOLUTION OF THE MAYOR AND TOWN COUNCIL OF THE TOWN OF CUTLER BAY, FLORIDA, APPROVING A VARIANCE APPLICATION FOR DADE COUNTY FEDERAL CREDIT UNION LOCATED AT 20295 S. DIXIE HIGHWAY, TO PERMIT THREE (3) WALL SIGNS WHERE ONE (1) IS PERMITTED; AND PROVIDING FOR AN EFFECTIVE DATE.

The Town Council may continue or defer the hearing(s) to a new date and time certain without further notice provided the date and time of the continuance or deferral is announced at the hearing(s). The Resolution(s) in its entirety may be inspected at the Office of the Town Clerk during regular business hours.

Persons wishing to appeal any decisions made by the Town Council with respect to any matter considered at such hearing(s) will need a record of the proceedings and; for such purpose, may need to ensure that a verbatim record of the proceedings is made; which includes the testimony and evidence upon which the appeal is to be based (F.S. 286.0105).

Any and all interested parties may appear at the above meeting and be heard with respect to the proposed items.

In accordance with the Americans with Disabilities Act of 1990 (ADA), persons needing special accommodations to participate in these proceedings should contact the Town Clerk's Office for assistance at (305) 234-4262, no later than four (4) business days prior to such proceeding.

Debra E. Eastman, MMC
Town Clerk

KEY LARGO

Woman squatted in home and sold cars, cops say

BY DAVID GOODHUE
dgoodhue@flkeysnews.com

A Key Largo woman squatted at a couple's home and sold four of their vehicles while they were away, police say.

Angela Sloan, 43, faces four counts of grand theft, two counts of fraud, one count of dealing in stolen property and one misdemeanor larceny count. Monroe County Sheriff's Office deputies arrested her Thursday.

While living at the Hibiscus Lane house, Sloan used the driver's license of the woman living there, who was not at home because she was receiving



Sloan

hospice care. Sloan sold the vehicles to Al's Wrecker Service in Key Largo on May 4 using the fraudulent

license, Deputy Gil Gonzalez wrote in his report.

Ronald Peterson, noticed his vehicles in the lot of Al's after he drove south into Key Largo over the Jewfish Creek Bridge on May 16, Gonzalez wrote.

Peterson called Al's owner, Craig Haberdeau, and asked him why the vehicles — three vans and a Saturn car — were in his lot, and he told him the woman of the

house called him and said she had several cars she wanted to get rid of, according to Gonzalez's report.

When Haberdeau arrived at the house, Sloan showed her the license and titles for two of the vans. He paid her \$50 each for the vehicles with titles and \$25 each for the ones without titles, the arrest report said.

After Peterson spoke with Haberdeau, Haberdeau told him to call the police and he'd assist in their investigation. He was able to identify Sloan from a photo lineup, according to Gonzalez.

As of Friday, Sloan was in county jail on Stock Island with no bond information available.

MOCA summer camp arts program begins Monday

The Museum of Contemporary Art North Miami (MOCA) will host two summer camp programs (five two-week sessions) from Monday until August 19.

The Creative Arts Summer Camp is offered for kids 6 through 12; the Dynamic Design Summer Camp is for kids 11 through 13. Each session will offer a different theme to introduce students to variety of contemporary art or design techniques.

The camp classes will run from 9 a.m. to 3:30

p.m. Mondays through Fridays. Cost: \$200 per two-week session for the general public; \$160 per two-week session for MOCA members, North Miami residents and city employees; and \$50 per week for pre-care and after-care from 8:30 to 9 a.m. and 3:30 to 5:30 p.m.

For more information, visit <https://hrlid.us/2LIIMJH>.

MIAMI: SUMMER PASSPORT PROGRAM

HistoryMiami Museum is kicking off its Summer

Passport Program, which provides free access to the museum for all children and their families in Miami-Dade County. The program, from Friday until Aug. 19, offers children an exciting educational adventure while exploring South Florida's rich past.

The passports can be picked up at the museum's front desk, 101 W. Flagler St. in downtown Miami. Each passport offers free admission to each child and their family members

SEE EVENTS, 15SE



**TOWN OF CUTLER BAY
PLANNING AND ZONING DIVISION**

AFFIDAVIT OF MAILING - COURTESY NOTICE

On June 6th, 2018, I Odalys Padron, mailed 25
 Courtesy Notices via First Class Mail. The mailing labels were provided by
The Zoning Specialists Group, Inc. (copy attached), for the
 purpose of informing adjacent property owners of an upcoming Public Hearing
 for Application # V-2018-019.

For Office Use

Odalys Padron
 (Planning and Zoning Staff Member)

[Signature]
 (Signature)

June 6, 2018
 (Date)

Kathryn Lyon
 (Planning & Zoning Director)

[Signature]
 (Signature)

6/6/18
 (Date)

1,000-FOOT RADIUS MAP OF:

LEGAL DESCRIPTION:

Portion of Tract E of CUTLER RIDGE MALL SUBDIVISION SECTION ONE,
according to the Plat thereof, as recorded in Plat Book 111, at Page
49 of the Public Records of Miami-Dade County, Florida.

LOCATION: 20295 South Dixie Highway, Cutler Bay, FL 33189

FOLIO NO. 36-6007-020-0021

PREPARED FOR: DADE COUNTY FEDERAL CREDIT UNION

ORDER: 180308

DATE: March 20, 2018

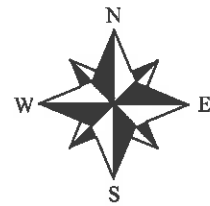

SCALE: 1"= 250'

The Zoning Specialists Group, Inc.

7729 NW 146th Street

Miami Lakes FL 33016

Ph: (305)828-1210

www.thezoningspecialistsgroup.com

I HEREBY CERTIFY: That all the properties shown herein are lying within a 1000-foot radius from all boundary lines of the subject property. I further certify that this radius map is true and correct to the best of my knowledge and belief.

BY: Jose Lopez
JOSE F. LOPEZ, P.S.M.

**Professional Surveyor & Mapper
No. 3086, State of Florida.**

NOTE:
NOT VALID UNLESS SEALED WITH
THE SIGNING SURVEYOR'S SEAL

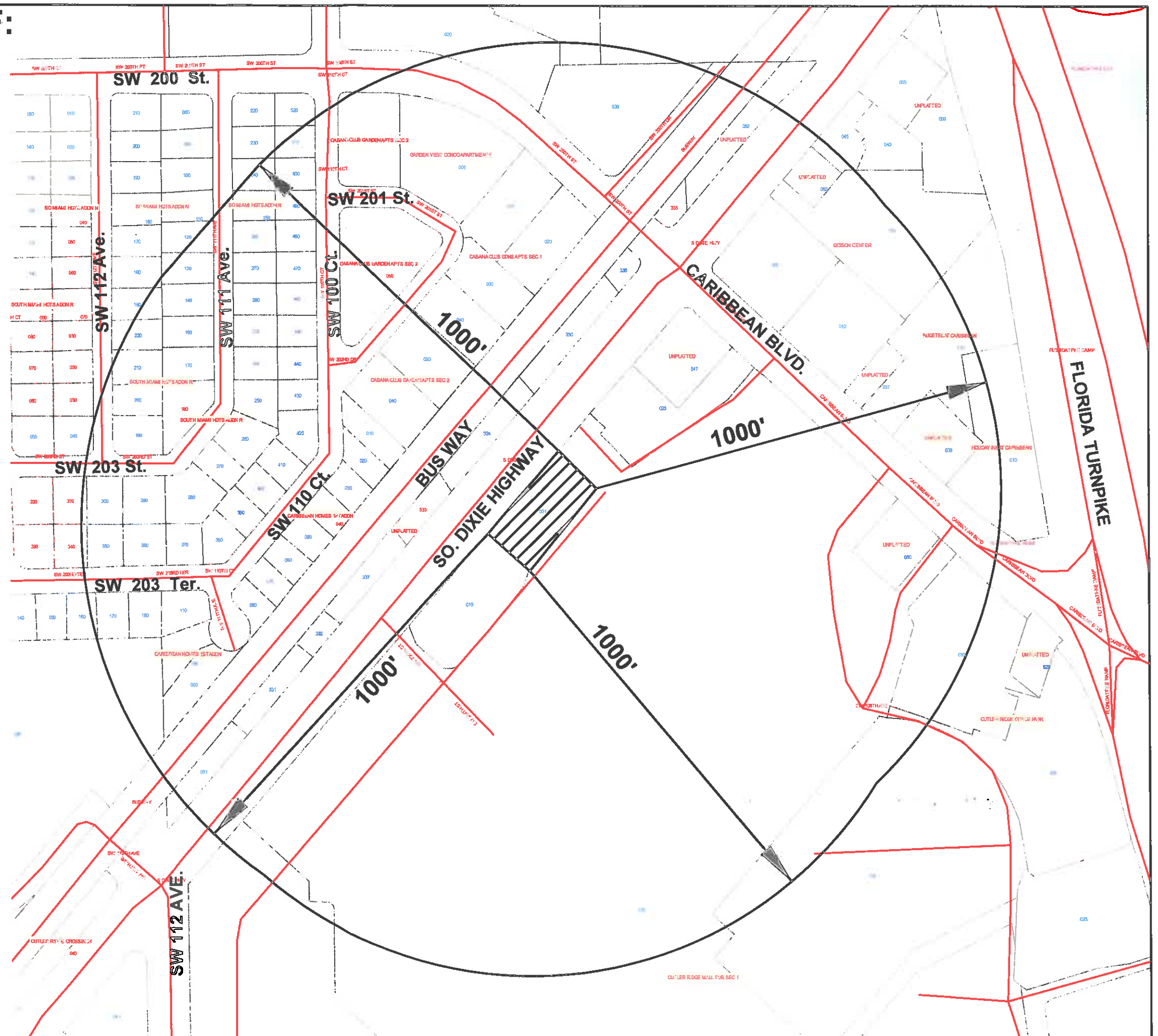

PROPERTY OWNERS LIST

THE FOLLOWING ARE PROPERTY OWNERS WITHIN THE TOWN OF CUTLER BAY AND WITHIN A 1,000-FOOT RADIUS FROM THE FOLLOWING LEGALLY DESCRIBED PROPERTY:

LEGAL DESCRIPTION:

Portion of Tract E of CUTLER RIDGE MALL SUBDIVISION SECTION ONE, according to the Plat thereof, as recorded in Plat Book 111, at Page 49 of the Public Records of Miami-Dade County, Florida.

LOCATION: 20295 South Dixie Highway, Cutler Bay, FL 33189

FOLIO NO. 36-6007-020-0021

PREPARED FOR: DADE COUNTY FEDERAL CREDIT UNION

ORDER: 180308

7 56 40 .60 Ac M/L Comm At The X Of SEly R/W/L Of Us #1 /St Rd #5/ WithThe
NEly R/W/L Of Carib Blvd Th SEly Alg NEly R/W/L Carib Blvd For 612.60Ft To
POB Th Cont 175Ft Th Nely150ft Nwly175ft Swly150ft Th NWly To POB
Property address: 10801 Caribbean Blvd
Folio number: 3660070000036

Unigas Inc
10801 Caribbean Blvd
Miami, FL 33189-1203

7 56 40 .23 Ac Comm At The X Of SEly R/W/L To Us 1 /St Rd 5/ With NEly
R/W/L Of Carib Blvd Th SEly Alg NEly R/W/L Of Carib Blvd For 452.60Ft ToPOB
Th Nely167.45Ft Sely60ft Swly167.55Ft Th NWly To POB Pr Add 10851
CaRibbean Blvd
Property address: 10851 Caribbean Blvd
Folio number: 3660070000037

Ccs Real Est Invest LLC
6883 Queenferry Cicle
Boca Raton, FL 33496

7 56 40 .31 Ac M/L Beg 411.05Fts Of NW Cor Of Sw1/4 Of Ne1/4 Cont 574.19Ft
To NWly R/W/L Of Sr 5 Ne300ft Nw50ft To SEly R/W/L Of Fec R/W Sw245.19Ft
To POB As Per Unity Of Title Dated 10-5-64
Property address: 20500 Dixie Hwy S
Folio number: 3660070000051

Magram Motor Cars Inc
8525 SW 92nd St Ste A3
Miami, FL 33156-7374

7 56 40 .55 Ac That Pt Of N1/2 Of N1/2 Of Ne1/4 Of Ne1/4 Lying Betw W/L
U S 1 & E/L Fec R/W Less Beg 335.25Fts Of NW Cor Of Nw1/4 Of Ne1/4 Of
NE1/4 Of Sec Th N 41 Deg E 117.11Ft NEly Ad 179.72Ft N 53 Deg E 60.18Ft
SWly Ad 238.60Ft S 41 Deg W 131.40Ft N 0 Deg W 19.32Ft To POB A/K/A
Pt OfParcel 102 Case No 94-251
Property address:
Folio number: 3660070000052

State Of Fla Dot
1000 NW 111th Ave
Miami, FL 33172-5800

7 56 40 .24 Ac M/L Beg X S/L N1/2 Of N1/2 Of Ne1/4 Of Ne1/4 & SEly R/W
US 1 NEly Al R/W 74.6ft M/L For POB SEly R/W 100Ft Nely105ft Nwly100ft
ToSEly R/W Us 1 SWly Alg R/W To Po
Property address: 20095 Dixie Hwy S
Folio number: 3660070000053

Andi Investments LLC
20095 S Dixie Hwy
Miami, FL 33189-1205

7 56 40 .366 Ac M/L Beg X SE R/W/L Fec Rr & SW R/W/L Caribbean Blvd S
42deg W121ft To POB Cont SW For 319Ft S47deg E50 Ft N42deg E319ft
Nw50ft ToPOB
Property address:
Folio number: 3660070000330

1622 Investment Corp
655 W Flagler St Ste 201
Miami, FL 33130-1223

7 56 40 .287 Ac Beg 300Ft NE Of X C/L Sec & N/L Sr-5 Ne250ft Nw50ft
Sw250ft SE 50ft To POB
Property address: 20462 Dixie Hwy S
Folio number: 3660070000331

Magram Motor Cars Inc
8525 SW 92nd St Ste A3
Miami, FL 33156-7374

7 56 40 .12 Ac Beg 550Ftne Of X C/L Sec & N/L St Rd 5 Ne100ft Nw50ft Sw
100ft SE 50ft To POB
Property address: 20400 Dixie Hwy S
Folio number: 3660070000332

Kathleen L Higginbotham
1 Grove Isle Dr Bldg 1 Unit 210
Miami, FL 33133-4100

7 56 40 .20 Ac M/L Beg X W/L Of Ne1/4 & SE R/W/L Fec Rr N 42 Deg E855.15Ft
To POB Cont Nely172.27Ft Sely50ft Swly172.27Ft Nwly50ft To POB
Property address:
Folio number: 3660070000333

1622 Investment Corp
655 W Flagler St Ste 201
Miami, FL 33130-1223

7 56 40 .35 Ac M/L Beg X Of W/L Of Ne1/4 & SE R/W/L Fec Ry N42 Deg 15
Min 01 Sec E1027.46Ft For POB Cont Ne305ftse At R/A 50ftsw At R/A 305Ft
nwAt R/A 50ft To POB
Property address: 20302 Dixie Hwy S
Folio number: 3660070000334

1622 Investment Corp
655 W Flagler St Ste 201
Miami, FL 33130-1223

7 56 40 Beg X SE R/W/L Fec Rr & NE R/W/L Caribbean Blvd N 42 Deg E 121.53Ft
S74.31Ft Sw76.85Ft NW 50 Ft To POB Less SEly 13 Ft & Less Ext Area OF
Curve In Most Sly Cor
Property address:
Folio number: 3660070000335

E T Legg & Co C/O Lawrence N Legg Cpa
3837 Hollywood Blvd Ste B
Hollywood, FL 33021-1243

7 56 40 .139 Ac M/L Beg X SE R/W/L Fec Rr & SW R/W/L Caribbean Blvd Th S42
Deg W121ft S47deg E50ft N42deg E121ft NW 50 Ft To POB
Property address:
Folio number: 3660070000336

1622 Investment Corp
655 W Flagler St Ste 201
Miami, FL 33130-1223

7 56 40 .30 Ac M/L Beg X W/L Of Ne1/4 & SE R/W/L Fec Ry N42deg 15 Min 01
Sec E 595.15Ft For POB Cont NEly 260ftse At R/A 50ft SW At R/A 260ft NWAt
R/A 50ft To POB
Property address: 20390 Dixie Hwy S
Folio number: 3660070000337

Gm Investments Enterprises LLC
1200 W 49th St
Hialeah, FL 33012-3217

7 56 40 15.26 Ac Beg 50Fte Of Center Of Sec N730.94Ft NEly Alg SEly R/W/L
Us 1 For 200ft S 47 Deg E214.20ft S43.92ft E44.39ft S 47 Deg E14.65ft
S230ft S 47 Deg E550ft S 42 Deg W160ft S 47 Deg E260ft S 42 Deg W368.20FT
W172.98ft N 44 Deg W296.98ft W210ft N273.57ft To POB
Pr Add 20701 AllaPattah Rd
Property address: 20701 Allapattah Rd
Folio number: 3660070000546

Seritage Src Finance LLC
3333 Beverly Rd
Hoffman Estates, IL 60179-0001

7 56 40 .61 Ac M/L Beg X Of SWly R/W Of Caribbean Blvd & SEly R/W Us #1
SEly Alg Carib Blvd 150Ft SWly Para Us #1 200Ft NWly Para Carib Blvd 150Ft
NEly Alg Us #1 200Ft To POB Less Nely20ft For R/W
Property address: 20201 Dixie Hwy S
Folio number: 3660070000547

Biscayne Petroleum LLC
2200 S Dixie Hwy Ste 601
Miami, FL 33133-2300

7 56 40 .50 Ac M/L Beg 689Ftsely R/W/L Of Sr 5 & SWly R/W/L Of Caribbean
Blvd Th S 48 Deg E 141.48Ft SEly & SWly Ad 5.05Ft S 41 Deg W 148.82Ft N48
Deg W 142Ft N 41 Deg E 153.83Ft To POB Less Nely20ft

Property address: 10808 Caribbean Blvd
Folio number: 3660070000660

Southland Mall Properties LLC
Washington Mutual Inc (Lessee)
PO Box 4900
Scottsdale, AZ 85261-4900

7 56 40 1.74 Ac M/L PB 104-60 Holiday Inn At Caribbean Tract A
Property address: 10775 Caribbean Blvd
Folio number: 3660070180010

G6 Hospitality Property LLC
4001 International Pkwy
Carrollton, TX 75007-1914

7 56 40 1.062 Ac M/L Cutler Ridge Mall Sub Sec One PB 111 - 49 Port Of TR E
Desc Comm Ctr Of Sec Th N 88 Deg E 50Ft N 01 Deg W 730.93Ft N 41 Deg
E 845.76Ft For POB Th Cont N 41 Deg E 296.50Ft S 48 Deg E 127Ft S 11 DeG
W 46Ft S 41 Deg W 240.76Ft SWly - NWly Ad 54.98Ft N 48 Deg W 78.20Ft
N21 Deg W 41.43Ft To POB
Property address: 20345 Dixie Hwy S
Folio number: 3660070200019

Eliest LLC
4550 N Bay Rd
Miami Beach, FL 33140-2859

7 56 40 54 Ac M/L Cutler Ridge Mall Sub Sec One PB 111-49 Tr E Less Beg258Ft
swly Cor Of Tr D Th N222.06Ft Nely310.50Ft M/L Sw50ft N 80 Deg W105.37Ft
S142.01Ft W31.50Ft S75ft To NWly/L Of SW 211 St R/W W144ft To POB& Less
Beg 521.12Ftswly X Of C/L Of Caribbean Blvd & SEly/L Of Us #1 ThSe127ft
Sw257.24Ft Nw127ft To SEly R/W/L Us #1 Ne257.24Ft To POB & PortOf Tr D
Desc Beg Most NWly Cor Of Tr D Th S 48 Deg E 222.20Ft Ne60.17FtNw204.70Ft
N 41 Deg E 229Ft Se54ft N 74 Deg E 110.70Ft Nwly165.47Ft Sw282.24Ft To POB
& Beg SE Cor Of Tr D Th N408.56Ft N 41 Deg E 59.29Ft N 48Deg W 14Ft
Sw330.20Ft S199.12Ft Sw41.31Ft M/L E To POB & Less Port Of Tr
Property address: 20505 Dixie Hwy S
Folio number: 3660070200020

Southland Mall Properties LLC
20505 S Dixie Hwy Ste 899
Miami, FL 33189-1259

7 56 40 .75 Ac M/L Cutler Ridge Mall Sub Sec One PB 111-49 Port Of Tr E Desc
Beg 521.12Ft SWly X Of C/L Of Caribbean Blvd & SEly/L Of Us #1 Th SE127ft
Sw257.24Ft Nw127ft To SEly R/W/L Us #1 Ne257.24Ft To POB
Property address: 20295 Dixie Hwy S
Folio number: 3660070200021

Dade County Federal Credit Union
1500 NW 107th Ave
Miami, FL 33172-2706

7 56 40 1.044 Ac M/L Cutler Ridge Mall Sub Sec One PB 111-49 Port Of TraCt
E Beg X Of NE Cor Of Tr E & S R/W/L Of State Road #5 Th S 48 Deg E 150Ft
N 41 Deg E 180Ft S 48 Deg E 73Ft S 41 Deg W 101.83Ft S 56 Deg W 286.01Ft
N 43 Deg W 76.11Ft N 48 Deg W 33.33Ft N 41 Deg E 20Ft N 48 Deg W 40Ft
N 41 Deg E 170.62Ft To POB

Property address: 20203 Dixie Hwy S
Folio number: 3660070200025

Arbys Properties LLC
C/O Arbys Restaurant Group Inc
1155 Perimeter Center West #1200
Atlanta, GA 30338

Cutler Ridge Mall Sub Sec One PB 111 - 49 7.77 Ac M/L Tr F Less Port DesC
 As Comm SEly South Cor Of Tr F Th N 41 Deg E 330Ft N 65 Deg E 294.37Ft
 For POB N 00 Deg W 34.91Ft N 18 Deg E 46.73Ft N 81 Deg E 5.61Ft SEly
 Ad42.67Ft N 73 Deg E 221.99Ft NWly NEly Ad 39.27Ft S 16 Deg E 82Ft S 73
 DEg W 285Ft N 08 Deg W 19.14Ft S 65 Deg 31.9Ft M/L To POB
 Property address: 20505 Dixie Hwy S
 Folio number: 3660070200030

Southland Mall Properties LLC
 20505 S Dixie Hwy Ste 899
 Miami, FL 33189-1259

Cutler Ridge Office Park PB 128-37 Port Of Tr A Desc Beg Most NEly Cor OF Tr A
 Th SEly 252.34Ft S 18 Deg W168.86Ft Se20ft S 18 Deg W136.66Ft N 71 Deg
 W300ft N 18 Deg E189.62Ft Nly & NEly A/D 48.69Ft N 41 Deg E178ft TO POB
 All Lyg SWly Of Caribbean Blvd & Port Of Tr A Desc As Comm NEly CoR Of Tr A
 Th S 48 Deg E 57.09Ft SEly Ad 195.25Ft S 18 Deg W 118.86Ft ForPOB Th S 54
 Deg E 97.12Ft N 71 Deg W 92.60Ft N 18 Deg E 28.86Ft To POB& Less Port Of
 Tr A Desc As Comm NEly Cor Of Tr A Th S 48 Deg E 57.09FtSEly Ad 195.25Ft
 S 18 Deg W 147.72Ft S 71 Deg E 20Ft S 18 Deg W 123.46FtFor POB Th N 71
 Deg W 83.01Ft S 18 Deg W 13.14Ft S 71 Deg E 83.02Ft N 1
 Property address: 10750 Caribbean Blvd
 Folio number: 3660070240010

Cbg Executive Offices LLC
 275 189th Ter
 North Miami Beach, FL 33160-2311

Cutler Ridge Office Park PB 128-37 Tr A Less Beg Most NEly Cor Of Tr A TH
 SEly 252.34Ft S 18 Deg W168.86Ft Se20ft S 18 Deg W136.66Ft N 71 Deg W300Ft
 N 18 Deg E189.62Ft Nly & NEly A/D 48.69Ft N 41 Deg E178ft To POB ALL Lyg
 SWly Caribbean Blvd & Less Port Of Tr A Desc As Comm NEly Cor Of TR A Th
 S 48 Deg E 57.09Ft SEly Ad 195.25Ft S 18 Deg W 118.86Ft For POB TH S 54
 Deg E 97.12Ft N 71 Deg W 92.60Ft N 18 Deg E 28.86Ft To POB & PortOf Tr A
 Desc As Comm NEly Cor Of Tr A Th S 48 Deg E 57.09Ft SEly Ad 195.25Ft S 18
 Deg W 147.72Ft S 71 Deg E 20Ft S 18 Deg W 123.46Ft For POB ThN 71 Deg
 W 83.01Ft S 18 Deg W 13.14Ft S 71 Deg E 83.02Ft N 18 Deg E 13.
 Property address: 10720 Caribbean Blvd
 Folio number: 3660070240020

Town Of Cutler Bay
 10720 Caribbean Blvd Ste 105
 Miami, FL 33189-1257

Gibson Center PB 142-19 T-17714 Tracts A & E
 Property address: 10855 Caribbean Blvd
 Folio number: 3660070250010

Mcdonalds Corporation
 PO Box 770367
 Miami, FL 33177-0007

Gibson Center PB 142-19 T-17714 Tr B
 Property address: 20195 Dixie Hwy S
 Folio number: 3660070250020

Sunshine Dade Investments LLC
 1650 NW 87th Ave
 Miami, FL 33172-2614

Gibson Center PB 142-19 T-17714 Tr C Less Beg At Most Ely Cor Tr D Th S48
 Deg E 79.18Ft S42.54Ft W141.80Ft N 41 Deg E 124.48Ft To POB

Property address: 10871 Caribbean Blvd
 Folio number: 3660070250030

Realty Income Corp
 Attn: Portfolio Management 1024
 11995 El Camino Real # Dep1024
 San Diego, CA 92130-2539

Gibson Center PB 142-19 T-17714 Port Of Tr C & D Desc Beg At Most Ely CoR
Tr C Th S 48 Deg E 79.28Ft S 00 Deg E 42.54Ft N 89 Deg W 170.48Ft N 16Deg
E 53.51Ft N 42 Deg E 1.67Ft N 47 Deg W 17.31Ft N 42 Deg E 15.45Ft N47 Deg
W 40.19Ft N 42 Deg E 76.62Ft S 48 Deg E 100.15Ft To POB
Property address: 20053 Dixie Hwy S
Folio number: 3660070250040

Baldeon Enterprises V LLC
15520 Palmetto Lake Dr
Miami, FL 33157-1752

Gibson Center PB 142-19 Tr D Less Desc Beg SEly Cor Of Tr D Th S 41 Deg
W 124.48Ft N 89 Deg W 28.68Ft M/L N 16 Deg E 53.51Ft N 42 Deg E 1.67Ft
N47 Deg W 17.31Ft N 42 Deg E 15.45Ft N 47 Deg W 40.19Ft N 42 Deg E 76.62Ft
S 48 Deg E 100.15Ft To POB
Property address: 20033 Dixie Hwy S
Folio number: 3660070250045

J D Investmant Capital Corp
20033 S Dixie Hwy
Miami, FL 33189-1205

Bugetel At Caribbean PB 146-20 T-18758 Tr A

Property address: 10821 Caribbean Blvd
Folio number: 3660070270010

Bre Lq Fl Properties L L C
C/O La Quinta Corporation
909 Hidden Rdg Ste 600
Irving, TX 75038-3822



TOWN OF CUTLER BAY
AFFIDAVIT OF POSTING

On June 6, 2018, I posted a copy of the attached Notice on the following described property located at 20295 South Dixie Highway Photographs I took on said date of the Notice posted at location are below.

DATED THIS 6th day of June, 2018.

Dennis Santiago
(Print Name)

Dennis Santiago
(Signature)

HEARING # V-2018-019

HEARING DATE/TIME Wednesday, June 20, 2018

APPLICANT Dade County Federal Credit Union

LOCATION/FOLIO # 36-6007-020-0221



PHOTO #1 (Close-up of Sign)



PHOTO #2 (Sign showing location)